

SCALE : 1 : 18 000

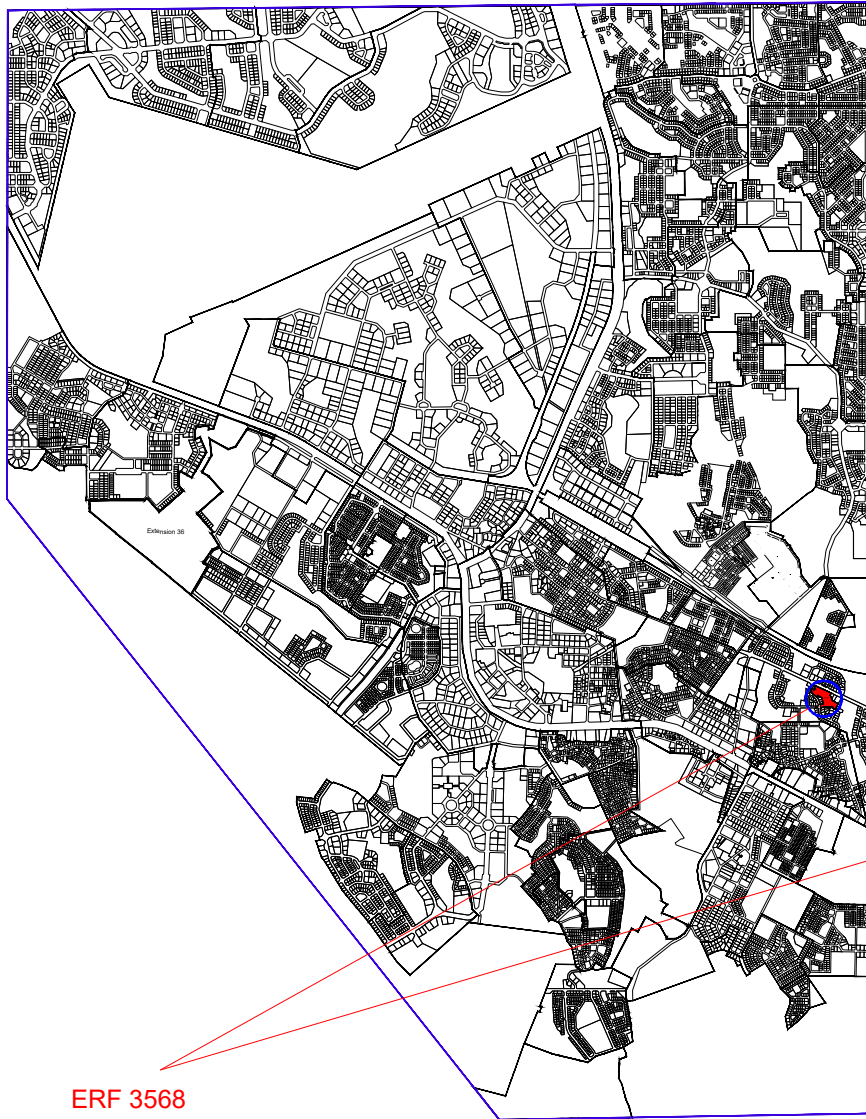

ERF 3568

SCALE : 1 : 3 000

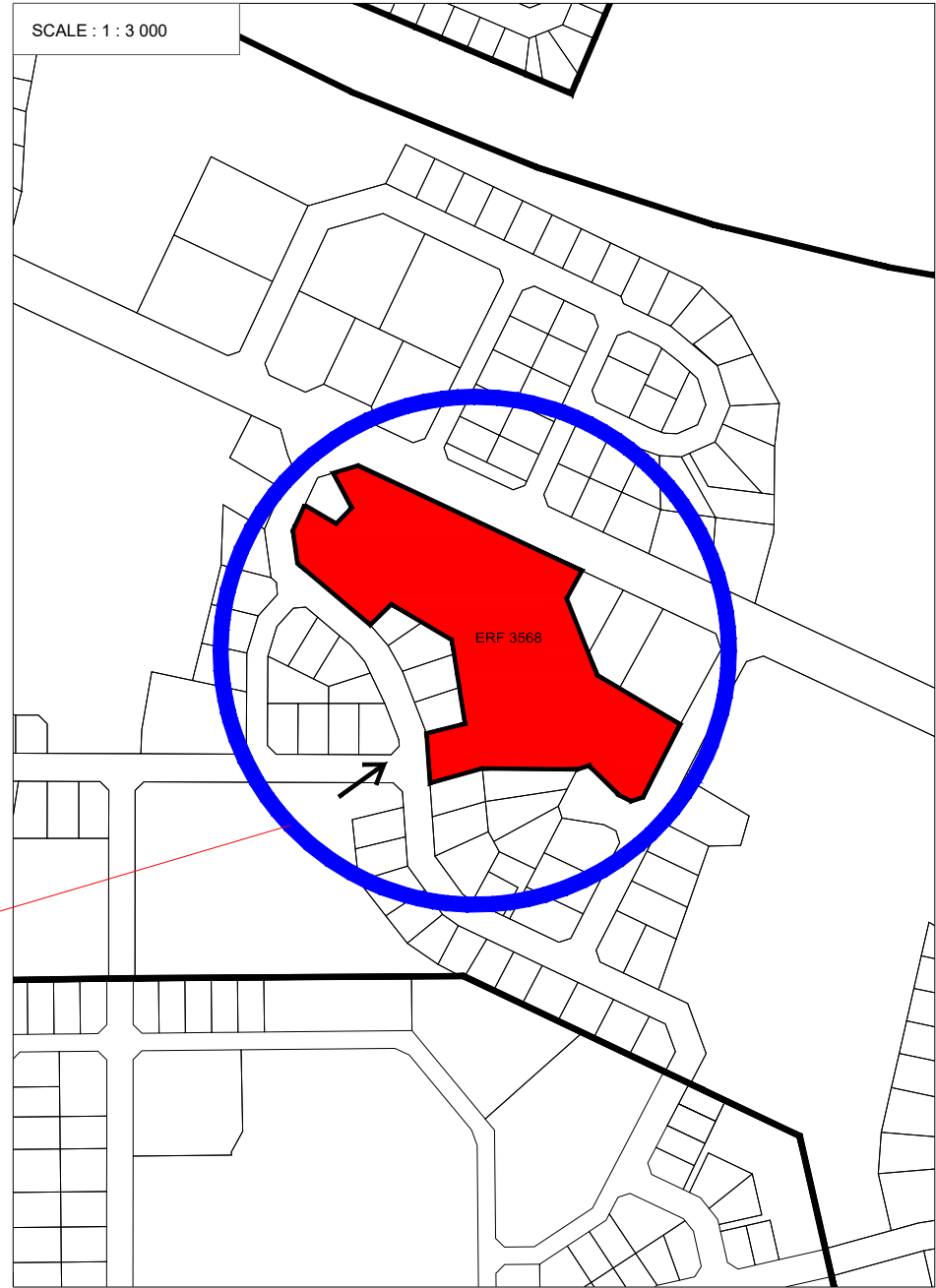

LOCALITY OF ERF 3568, ONDANGWA EXTENSION 16

SCALE : 1 : 18 000 (INSERT - 1 : 3 000)

DATE: JANUARY 2026

GEOGRAPHIC COORDINATES	
LATITUDE	-17.911298°
LONGITUDE	15.995381°



CONSULTANT	NPC
DRAWN BY	NNK
CLIENT	MR AMUTENYA
DRAWING NO	OND 01-11-2025



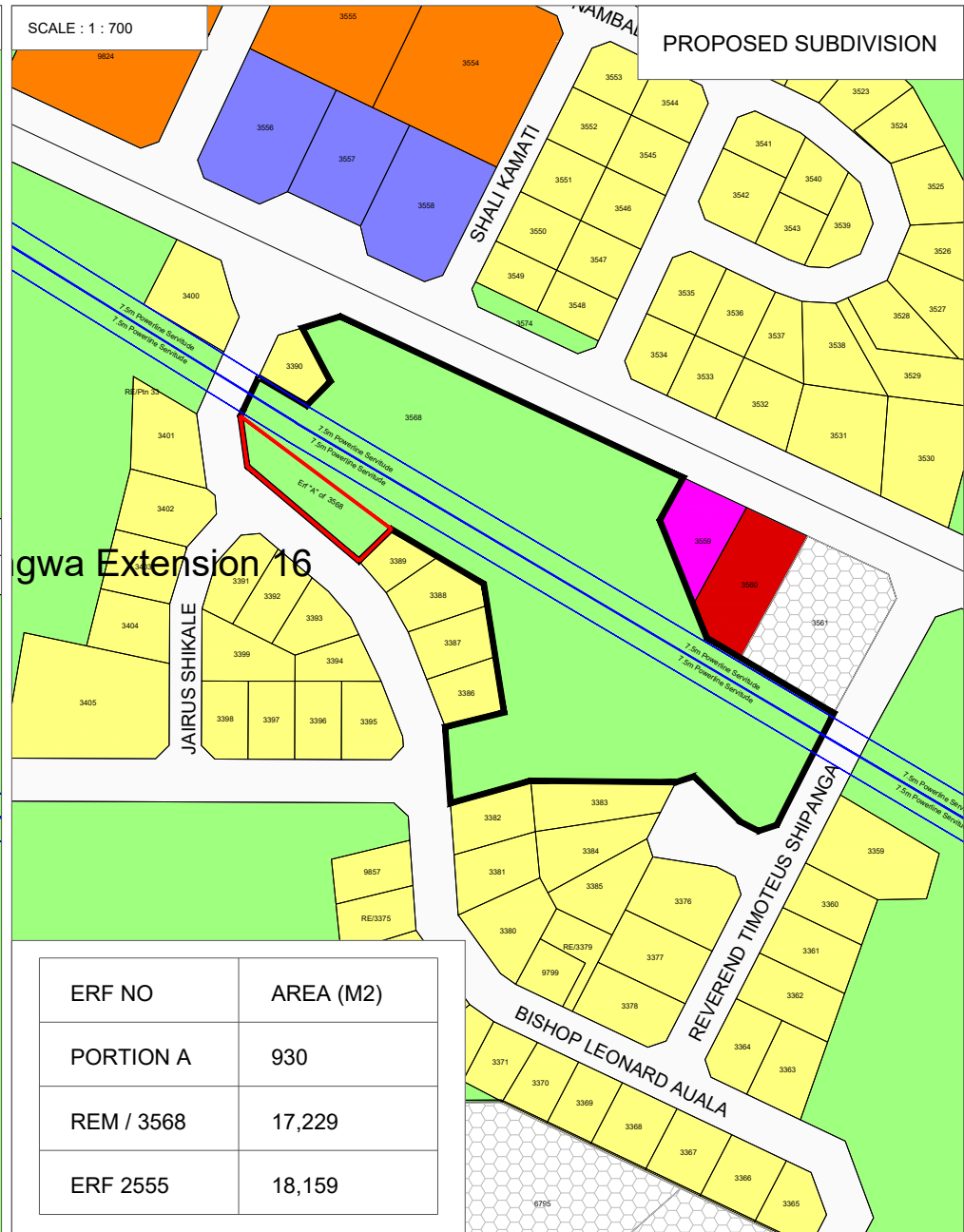
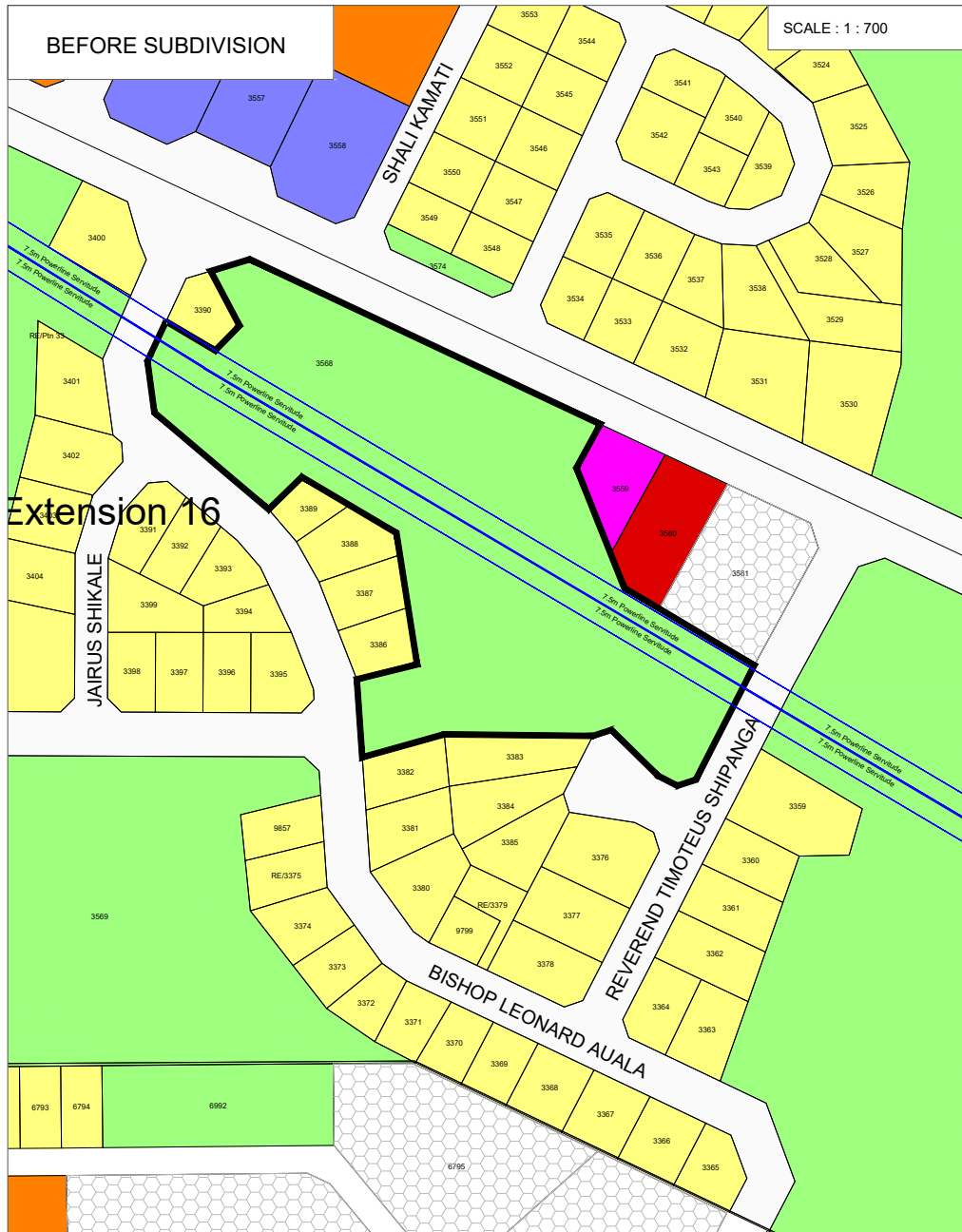

ERF NO	AREA (M2)
PORTION A	930
REM / 3568	17,229
ERF 2555	18,159

SUBDIVISION OF ERF 3568 (POS), ONDANGWA EXTENSION 16 INTO PORTION A AND REMAINDER

SCALE : 1:700

DATE: JANUARY 2025

LEGEND	
	SUBDIVISION BOUNDARY
	ERF 3568 BOUNDARY
	CONTOURS



CONSULTANT	NPC
DRAWN BY	NNK
CLIENT	MR AMUTENYA
DRAWING NO	OND-02-11-2025



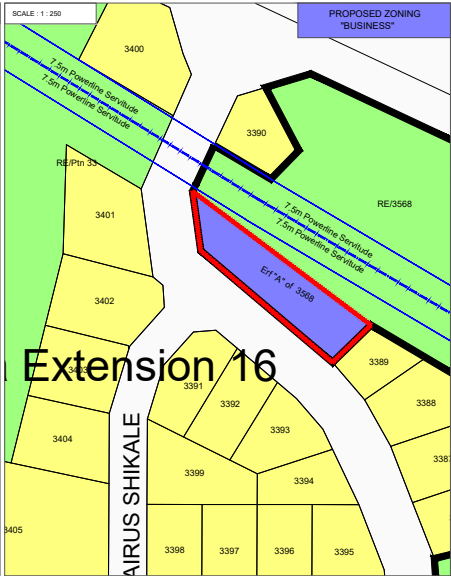
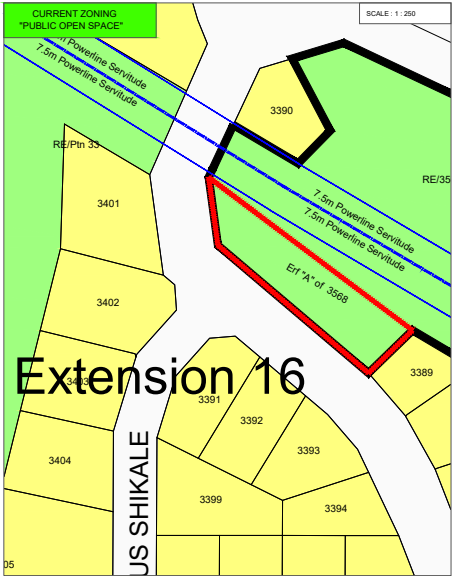





Extension 16

Extension 16

US SHIKALE

AIRUS SHIKALE

**REZONING OF PORTION A OF ERF 3568, ONDANGWA EXTENSION 16
FROM "PUBLIC OPEN SPACE" TO "BUSINESS"**

LEGEND		CONSULTANT		
PUBLIC OPEN SPACE		DESIGNED BY	NAME	
INSTITUTIONAL		CLIENT	MR ABULTENYA	
PORTION A BOUNDARIES		DRAWING NO	END-04-11-2025	

SCALE: 1:250

DATE: JANUARY 2025