

MINUTES OF SITE VISIT AND PUBLIC CONSULTATION MEETING



Project: Okonjima Piggery Operations

Location: Farm Okonjima No. 3

Date: 24 January 2026

Time: 10h00 – 12h00

1.

Attendance

- Mr. C. R. Haikali – Owner, Okonjima Piggery
 - Environmental Assessment Practitioner (EAP) Team
 - Piggery Operational Staff
-

2.

Purpose of the Meeting

The purpose of the site visit and consultation meeting was to:

- Assess the current piggery and slaughterhouse operations;
 - Engage with the owner and staff regarding operational procedures;
 - Identify potential environmental and social impacts;
 - Gather information to inform the Environmental Assessment process.
-

3.

Proceedings

3.1 Opening and Introduction

The meeting was led by Mr C. R. Haikali, who welcomed the EAP team and provided an overview of the piggery operations.

3.2 Site Visit

A comprehensive site inspection was conducted, covering:

- Piggery housing units;
- Feeding and watering systems;
- Waste management areas;
- Slaughterhouse facilities;
- General site layout and infrastructure.

3.3 Operational Overview

- The EAP team was guided through the full operational cycle, from pig rearing to slaughtering.
- Staff members responsible for various stages of the operation were introduced.
- Detailed explanations were provided on:
 - Daily operational procedures;
 - Animal handling practices;
 - Hygiene and sanitation measures;
 - Waste disposal and management systems.

3.4 Engagement with Staff

- The team engaged directly with workers to understand:
 - Working conditions;
 - Occupational health and safety practices;
 - Operational challenges and efficiencies.
-

4.

Key Findings from the Site Visit

4.1 General Operations

- The piggery is fully operational, with clearly defined processes from housing to slaughter.
- Staff demonstrated a sound understanding of their roles and responsibilities.

4.2 Infrastructure

- Adequate infrastructure is in place for pig rearing and slaughtering activities.
- The layout supports operational efficiency, although some areas may require optimisation for improved environmental management.

4.3 Waste Management

- Waste is generated from both the piggery and slaughterhouse operations.
- Existing waste management practices were observed; however, improvements may be required to ensure compliance with environmental standards and to minimise potential impacts.

4.4 Environmental Considerations

- Potential environmental concerns identified include:
 - Odour emissions;
 - Wastewater generation;
 - Solid waste handling.
- No immediate significant impacts on surrounding properties were observed during the visit.

4.5 Occupational Health and Safety

- Basic health and safety measures are in place.
 - Further strengthening of safety protocols and documentation may be beneficial.
-

5.

Public Consultation Outcomes

- The engagement was primarily internal, involving the owner and operational staff.
 - No objections or concerns were raised during the consultation.
 - The owner expressed willingness to comply with environmental requirements and implement recommended improvements.
-

6.

Conclusions

The site visit provided a clear understanding of the Okonjima Piggery operations. While the facility is functional and managed, certain aspects—particularly waste management and environmental controls—require enhancement to align with best practices and regulatory requirements.

7.

Recommendations

- Improve waste and wastewater management systems;
- Strengthen environmental monitoring measures;
- Enhance occupational health and safety procedures;

- Develop and implement an Environmental Management Plan (EMP).
-

8.

Closure

The meeting and site visit concluded with appreciation extended to Mr Haikali and his team for their cooperation and transparency.

Prepared by: KPM Environmental Consulting

Date: 25 January 2026

9.

Photographic Record of Site Visit

The following photographs were taken during the site visit to document the existing conditions and operations at Okonjima Piggery:

Photo 1: Overview of piggery housing units

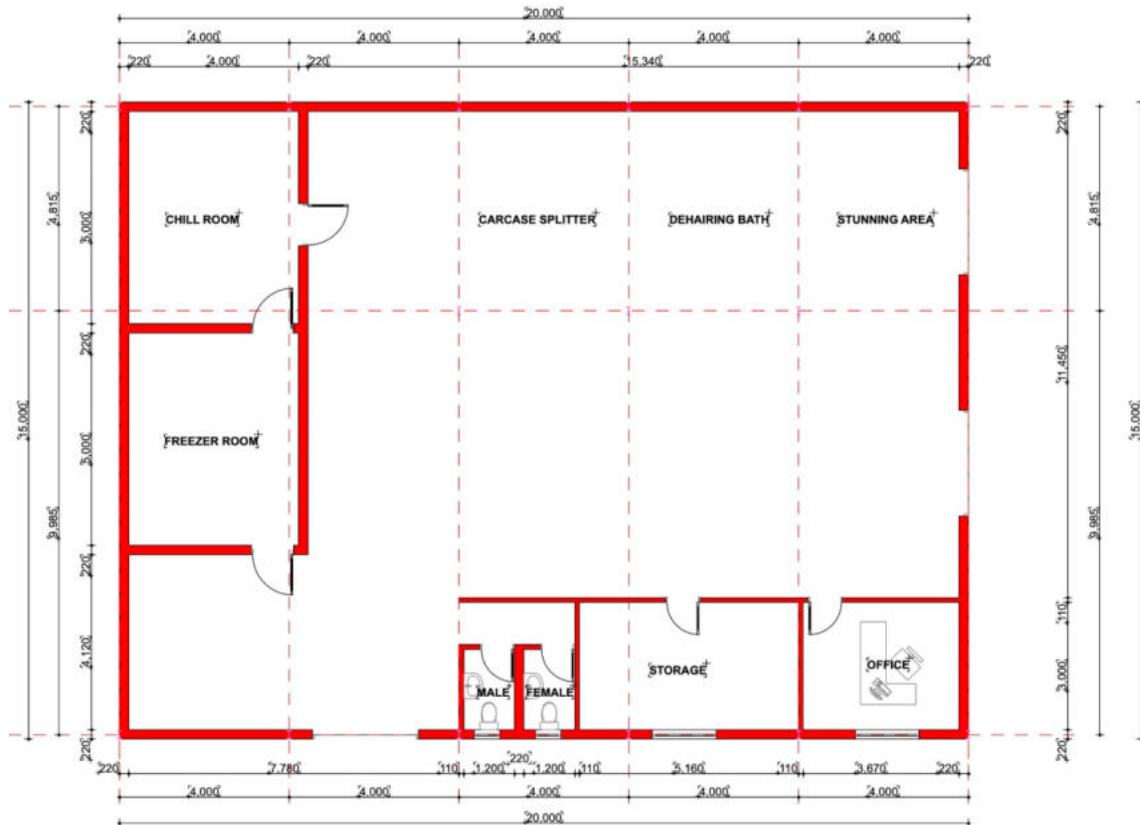

Description: General layout and structure of pig housing facilities.

Photo 2: Feeding and watering systems



Description: Installed systems used for feeding and watering livestock.

Photo 3: Waste management area



Description: Area designated for handling and disposal of solid waste.

Photo 4: Slaughterhouse facility



Description: Interior/exterior of the slaughterhouse where processing takes place.

Notes:

- All photographs were taken on 24 January 2026 during the site visit.
 - The images form part of the Environmental Assessment record.
-