

MINISTRY OF AGRICULTURE, WATER AND FORESTRY

No. 37

2006

**FOREST ACT, 2001: DECLARATION OF AN AREA AS A COMMUNITY FOREST:
NCAMAGORO COMMUNITY FOREST**

- (a) Under section 15(3) of the Forest Act, 2001 (Act No. 12 of 2001), I declare -
- (i) the area, in respect of which the geographical boundaries have been identified in the Schedule, to be the Ncamagoro Community Forest; and
 - (ii) that the Ncamagoro Community Forest shall be managed in accordance with the agreement referred to in subsection (1) of that section.
- (b) A map and other information or documents referred to in paragraph (a) lie open for inspection by the public during office hours at the offices of the Directorate: Forestry, Government Office Park, Fourth Floor, Room No. 453, Windhoek.

N. IYAMBO
MINISTER OF AGRICULTURE,
WATER AND FORESTRY

Windhoek, 27 January 2006

SCHEDULE**PART I****DESCRIPTION OF THE GEOGRAPHICAL BOUNDARIES OF THE
NCAMAGORO COMMUNITY FOREST**

From point A the boundary line runs in a south-easterly direction to point B. From point B the boundary line runs in a southerly direction to point C. From point C the boundary line runs in a north-westerly direction to point D. From point D the boundary line runs in a north-westerly direction to points E and then F. From point F the boundary line runs in a north-easterly direction to the point of beginning, point A.

The coordinates of the geographical boundaries of the Ncamagoro Community Forest.

Point	S (degrees)	S (minutes)	E (degrees)	E (minutes)
A	18	09.458	19	30.524
B	18	18.139	19	42.532
C	18	22.001	19	42.532
D	18	14.373	19	26.232

PART II

MAP OF THE NCAMAGORO COMMUNITY FOREST

MAP FOR NCAMAGORO COMMUNITY FOREST

Shape	Name	East-coord	South-coord
Point	A	19.91494	-18.16271
Point	B	19.71524	-18.30434
Point	C	19.71528	-18.36157
Point	D	19.67808	-18.35459
Point	E	19.67036	-18.14731
Point	F	19.43916	-18.24581

Projector: Geographic
 Datum: WGS84
 Units: Decimals

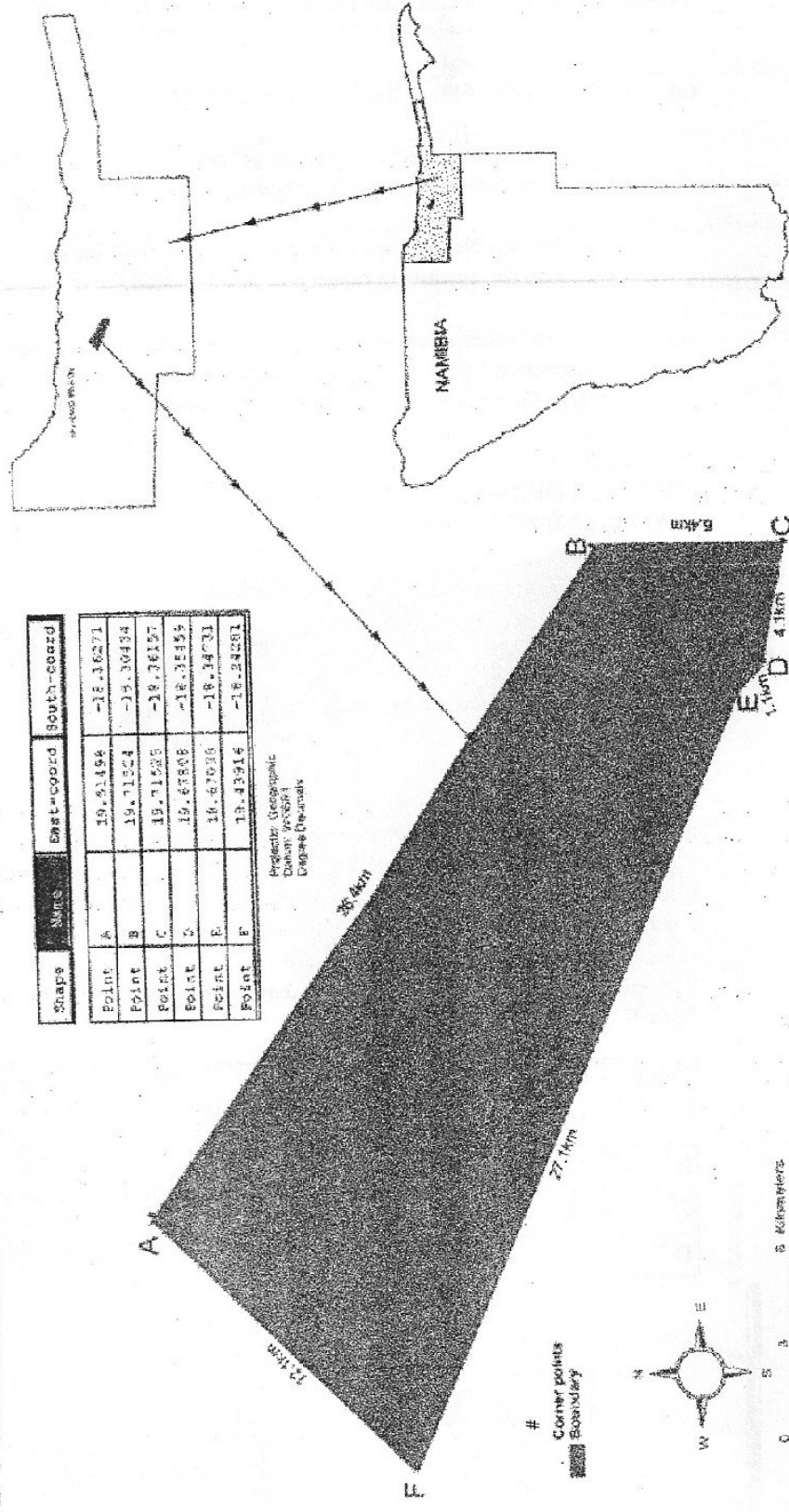

Corner points
 Boundary

