



Image © 2022 Maxar Technologies

PLAN AFRICA CONSULTING CC



TOKIN AND REGIONAL PLANNERS

LOCALITY OF REMAINDER OF THE CONSOLIDATED
PORTION F OF THE FARM OKAHANDJA TOWN
AND TOWNLANDS NO.57

CO-ORDINATES: (Lat -22.006860° | Long 16.926620°)
OKAHANDJA, OTJONZDJIJUPA REGION, NAMIBIA

REMAINDER OF PORTION F (OKAHANDJA)

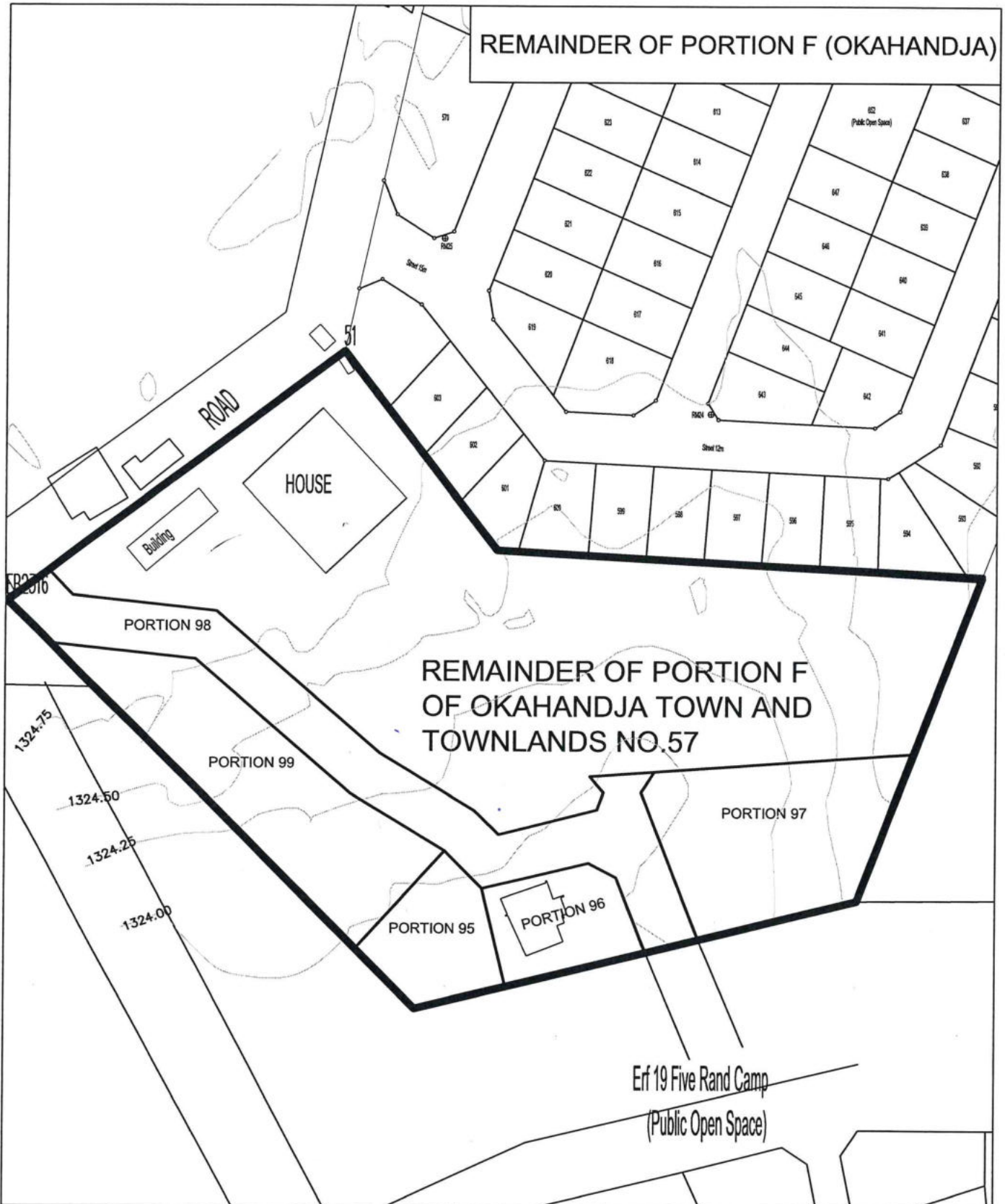

REMAINDER OF PORTION F= 19829 = 1.9 ha

Portion 95= 800m²

Portion 96 = 784m²

Portion 97 = 2000m²

Portion 98= 2495m²

Portion 99 = 2223m²

Remainder= 11527.19m²

SCALE 1:1200



OCT.2022

Plan Africa
Consulting cc



Tel : (061) 212096
Cell : 0812716189
P.O.Box 4114 Windhoek
Fax : 088614626
8 Delius Street
Email: pafrica@rmweb.com.na

PROPOSED SUBDIVISION PLAN OF THE
REMAINDER OF PORTION F OF THE FARM
OKAHANDJA TOWN AND TOWNLANDS NO.57
INTO PORTIONS 95 TO 99 AND REMAINDER