

Annexure A: Proof of Site Notices/ Posters

PUBLIC NOTICE ENVIRONMENTAL IMPACT ASSESSMENT

Stubenrauch Planning Consultants (SPC) hereby give notice to all potentially Interested and Affected Parties (I&APs) that an application will be made to the Environmental Commissioner in terms of the Environmental Management Act (No 7 of 2007) and the Environmental Impact Assessment Regulations (GN 30 of 6 February 2012) for the following

PROJECT DETAILS:

- Subdivision of Portion 5 (Ondekaremba Kleinsiedlung) of Farm Ondekaremba No.78 into Portions A to J and Remainder;
- Registration of a 20 meter Right of Way Servitude over Farm Neudam No 63 in favour of Portion 5 of Farm Ondekaremba No 78;
- Registration of a 20 meter Right of Way Servitude over the Remainder of Portion 5 of Farm Ondekaremba No 78 in favour of proposed Portions A to J.

The proponent intends on subdividing Portion 5 of Farm Ondekaremba No.78 into 10 smaller portions and the Remainder, with the aim of selling the newly created portions and retaining ownership of the Remainder. The proposed right of ways to be created is to allow access to the newly created portions.

PROJECT LOCATION: Ondekaremba, Khomas Region

The Proponent: Gisela Elke Müller

Environmental Assessment Practitioner (EAP): Stubenrauch Planning Consultants (SPC)



REGISTRATION OF I&APs AND SUBMISSION OF COMMENTS:

In line with Namibia's Environmental Management Act (No. 7 of 2007) and EIA regulations (GN 30 of 6 February 2012), all I&APs are hereby invited to register and submit their comments, concerns or questions in writing via
Email: bromwynn@spc.com.na; Fax: 061 25 21 57 or Tel: 061 25 11 89 on or before 5 August 2021.

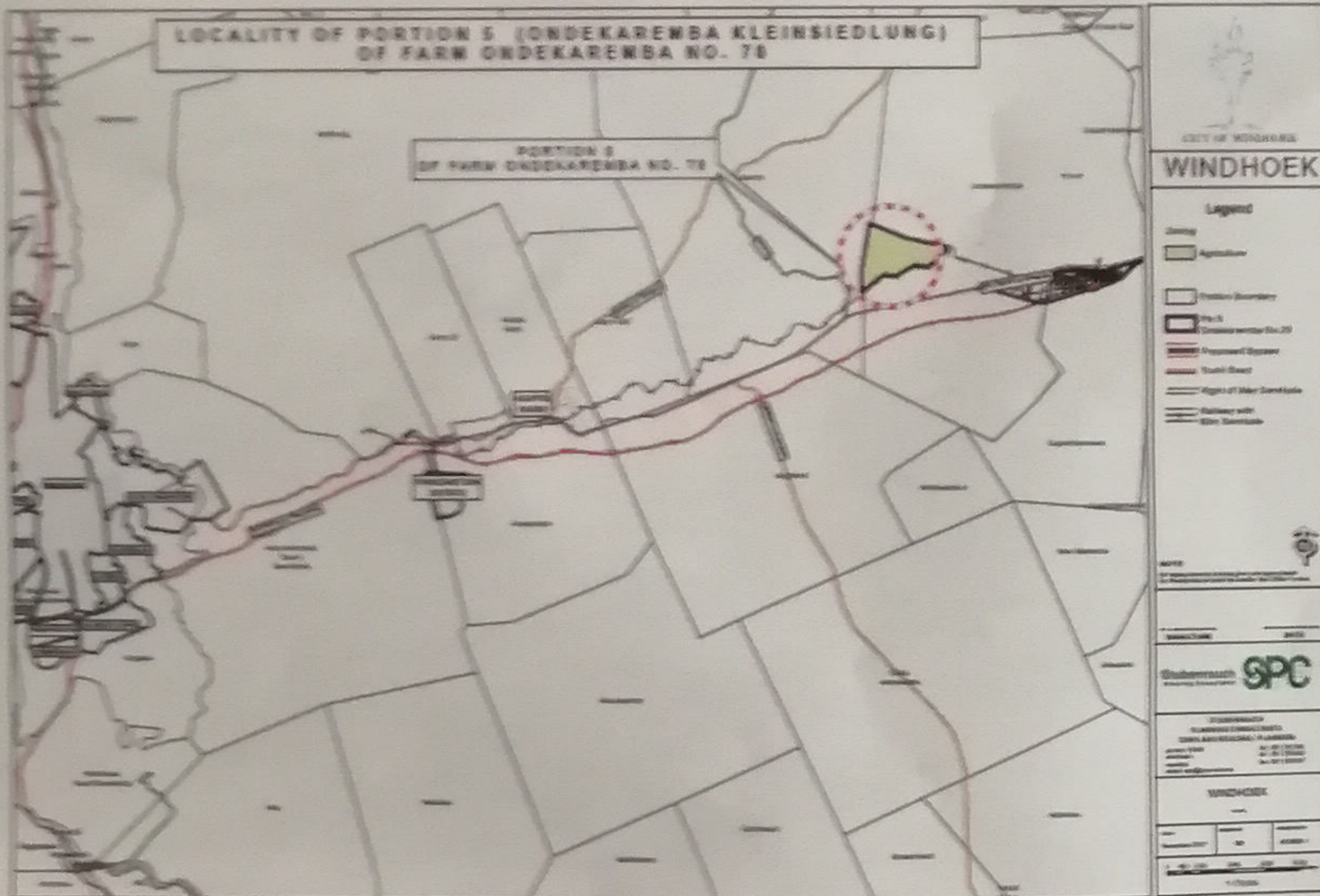

PUBLIC NOTICE ENVIRONMENTAL IMPACT ASSESSMENT

Stubenrauch Planning Consultants (SPC) hereby give notice to all potentially interested and Affected Parties (I&APs) that an application will be made to the Environmental Commissioner in terms of the Environmental Management Act (No 7 of 2007) and the Environmental Impact Assessment Regulations (GN 30 of 6 February 2012) for the following:

PROJECT DETAILS:

- Subdivision of Portion 5 (Ondekaremba Kleinsiedlung) of Farm Ondekaremba No.78 into Portions A to J and Remainder;
- Registration of a 20 meter Right of Way Servitude over Farm Neudam No 63 in favour of Portion 5 of Farm Ondekaremba No 78;
- Registration of a 20 meter Right of Way Servitude over the Remainder of Portion 5 of Farm Ondekaremba No 78 in favour of proposed Portions A to J.

The proponent intends on subdividing Portion 5 of Farm Ondekaremba No.78 into 10 smaller portions and the Remainder, with the aim of selling the newly created portions and retaining ownership of the Remainder. The proposed right of ways to be created is to allow access to the newly created portions.

PROJECT LOCATION: Ondekaremba, Khomas Region

The Proponent: Gisela Elke Müller
Environmental Assessment Practitioner (EAP): Stubenrauch Planning Consultants (SPC)

REGISTRATION OF I&APs AND SUBMISSION OF COMMENTS:
In line with Namibia's Environmental Management Act (No. 7 of 2007) and EIA regulations (GN 30 of 6 February 2012), all I&APs are hereby invited to register and submit their comments, concerns or questions in writing via
Email: bronwynn@spc.com.na; Fax: 061 25 21 57 or Tel: 061 25 11 89 on or before 5 August 2021.



Annexure B: Proof of Advertisements

Vigilantism growing in South Africa

Keeping law and order

Thousands of soldiers were deployed to provide reinforcements as the violence spread to Johannesburg, the country's financial hub.

SOFIA CHRISTENSEN

Armed community members and vigilante groups have stepped in to tackle unrest in South Africa, taking matters into their own hands and sometimes stoking violence as security forces struggle to

restore order. Understaffed and heavily reliant on private security companies, the police were rapidly overwhelmed when riots and looting first flared last week in the south-eastern province of KwaZulu-Natal (KZN), sparked by the jailing of graft-acquainted former president



Members of South Africa's military, along with community members and members of the police. PHOTO NAMP/REUTERS

Jacob Zuma. Thousands of soldiers were deployed to provide reinforcements as the violence spread to Johannesburg, the country's financial hub.

But with tensions still high in parts of KZN and a toll of over 100, some worried citizens have taken up arms to protect their communities and their property.

Such grassroots mobilisations can easily turn violent and deadly in a country where it is not uncommon to own a handgun.

AFP journalists witnessed one particularly brutal incident on Wednesday, when dozens of local commuter-minibus operators beat



Damaged ATM's. PHOTO AL JAZEERA

up seven township dwellers caught rummaging through the debris of a ransacked mall in south-eastern Johannesburg. The victims, which in-

cluded two women, crouched helplessly against a metal gate, wide-eyed and screaming in pain as the mob clamped down on them with whips, sticks and rusty metal rods.

One man who tried to escape was hit over the head with a glass bottle and dragged back, blood streaming down his neck.

Eager to show off their prowess, the group proudly paraded to police vans parked outside the mall's main entrance.

There, they handed in their captives, whose faces were swollen and

their hands were tied tightly behind their backs. Some were released on the spot.

Residents had meanwhile gathered in a nearby cemetery around the body of a teenage boy, allegedly shot earlier in the day.

Acting Minister in the Presidency Khumbuzo Ntshavheni warned against "a situation where members of the public are at loggerheads with the law after their attempts to protect their lives and their own lives".

"Do not infringe on the rights of others and do not take the law into your own

hands," she said. "South Africa is ruled by mobs," said Durban based political analyst Xolani Dube.

"When you have so many unregulated security companies and arms floating around who's going to be in control when the country ignites?" he asked, noting that both the police and army were poorly equipped.

Protection

Deadly scuffles broke out over the weekend between armed locals and alleged looters in the town of Phoenix, 25 kilometres northwest of Durban, according to witnesses.

Police Minister Bheki Cele said racial tension had fed into community protection efforts in Phoenix, where the majority of residents are of Indian descent.

Fifteen people are known to have been killed in the town since the violence started, he said. This week Cele condemned "vigilantism" and urged citizens to work with police rather than set up parallel structures.

In Pietermaritzburg, KZN's capital, local volunteers armed with anything from paintball guns to baseball bats are taking turns to watch over residential suburbs and shopping centres.

Resident Bernie Naidoo, 43, told AFP the situation had remained peaceful, with grateful civilians providing food and coffee to help their protectors face chilly winter nights.

"You will see a few [police] vehicles riding around but they are severely outnumbered," said Naidoo, an investment advisor. "It could definitely escalate into clashes," he added. "That is exactly why the guys are arming themselves."

Citizens have also gathered peacefully around shopping malls in Johannesburg and Pretoria, forming human chains to deter potential looters.

Security expert Johan Burger cautioned against labelling all community security initiatives "vigilante action".

-Nampa/AFP

PUBLIC NOTICE ENVIRONMENTAL IMPACT ASSESSMENT

Stubenrauch Planning Consultants (SPC) hereby give notice to all potentially Interested and Affected Parties (I&APs) that an application will be made to the Environmental Commissioner in terms of the Environmental Management Act (No 7 of 2007) and the Environmental Impact Assessment Regulations (GN 30 of 6 February 2012) for the following:

PROJECT DETAILS:

- Subdivision of Portion 5 (Ondekaremba Kleinsiedlung) of Farm Ondekaremba No.78 into Portions A to J and Remainder;
- Registration of a 20 meter Right of Way Servitude over Farm Neudam No 63 in favour of Portion 5 of Farm Ondekaremba No 78;
- Registration of a 20 meter Right of Way Servitude over the Remainder of Portion 5 of Farm Ondekaremba No 78 in favour of proposed Portions A to J.

The proponent intends on subdividing Portion 5 of Farm Ondekaremba No.78 into 10 smaller portions and the Remainder, with the aim of selling the newly created portions and retaining ownership of the Remainder. The proposed right of ways to be created is to allow access to the newly created portions.

The Proponent: Gisela Elke Müller
Environmental Assessment Practitioner (EAP): Stubenrauch Planning Consultants (SPC)

REGISTRATION OF I&APs AND SUBMISSION OF COMMENTS:

In line with Namibia's Environmental Management Act (No. 7 of 2007) and EIA regulations (GN 30 of 6 February 2012), all I&APs are hereby invited to register and submit their comments, concerns or questions in writing via

Email: bronwynn@spc.com.na;
Fax: 061 25 21 57 or
Tel: 061 25 11 89
 on or before **5 August 2021**

UNIVERSITIES RETIREMENT FUND INVITATION TO TENDER

The Board of Trustees of the Universities Retirement Fund, a defined contribution pension fund, in line with their objectives to ensure an ongoing high-level service to the members of the Universities Retirement Fund hereby invite Namibian domiciled and registered companies to tender for the following services:

- Actuarial
- Administration
- Auditing
- Consulting

Tender documents and further information can be obtained from the Principal Officer by sending an e mail to: uniref@nust.na.

The tender closes on Thursday, 19 August 2021 at 11.00.

The Principal Officer
 Universities Retirement Fund

EROS VACCINATION CENTRE

DO THE RIGHT THING AND VACCINATE.

REMEMBER!

Venue: Eros NG Church (Corner of Genl Murtala Muhammed Avenue & Kuiseb Street)

Operating hours (GATES OPEN): Monday to Friday: 08h00 - 16h00, Saturday: 09h00 - 15h00

Vaccine Available: Sinopharm

Call centre number: 081 870 9182

Together we can fight this virus - be a responsible citizen and get vaccinated!

**PUBLIC NOTICE
ENVIRONMENTAL IMPACT ASSESSMENT**

Stubenrauch Planning Consultants (SPC) hereby give notice to all potentially Interested and Affected Parties (I&APs) that an application will be made to the Environmental Commissioner in terms of the Environmental Management Act (No 7 of 2007) and the Environmental Impact Assessment Regulations (GN 30 of 6 February 2012) for the following:

PROJECT DETAILS:

- Subdivision of Portion 5 (Ondekaremba Kleinsiedlung) of Farm Ondekaremba No.78 into Portions A to J and Remainder;
- Registration of a 20m Right of Way Servitude over Farm Neudam No 63 in favour of Portion 5 of Farm Ondekaremba No 78;
- Registration of a 20m Right of Way Servitude over Portions A and the Remainder of Portion 5 in favour of Portions A, B and C;
- Registration of a 20m Right of Way Servitude over the Remainder of Portion 5 in favour of Portions D to J.

The proponent intends on subdividing Portion 5 of Farm Ondekaremba No.78 into 10 smaller portions and the Remainder, with the aim of selling the newly created portions and retaining ownership of the Remainder. The proposed right of ways to be created is to allow access to the newly created portions.

The Proponent: Gisela Elke Müller

Environmental Assessment Practitioner (EAP): Stubenrauch Planning Consultants (SPC)

REGISTRATION OF I&APs AND SUBMISSION OF COMMENTS:

In line with Namibia's Environmental Management Act (No. 7 of 2007) and EIA regulations (GN 30 of 6 February 2012), all I&APs are hereby invited to register and submit their comments, concerns or questions in writing via

Email: bronwynn@spc.com.na;

Fax: 061 25 21 57 or

Tel: 061 25 11 89

on or before **5 August 2021**



Element Consulting Engineers, Namibia

VACANCY

CIVIL ENGINEER

Element Consulting Engineers is one of the leading consulting companies in Namibia.

We are currently looking for the services of a Civil Engineer in our Windhoek office. The individual will be responsible for various engineering projects including civil infrastructure, municipal services and be able to do project management.

Applicants must be Namibian citizens, be registered with the Engineering Council of Namibia (ECN) as Professional / Incorporated Engineer and must have professional experience in civil infrastructure and municipal services of minimum 5 years.

Skills & knowledge for above position should also include:

Administrative and communication skills in addition to technical knowledge and project management are imperative. Good writing skills, an eye for detail and being able to work well under pressure - independently and in a team is required.

Element Consulting Engineers offer a competitive salary with pension, group life and medical aid benefits.

For applications send a complete CV to:
element@element.com.na

Closing date for applications: 22 July 2021



EMBASSY OF THE UNITED STATES OF AMERICA

The United States Embassy in Windhoek has the following vacancies as detailed below.

*Please note that applications must be submitted **electronically via the Electronic Recruitment Application (ERA)** system, by **July 16, 2021** to be considered.*

Interested applicants should visit the U.S. Embassy website at <https://na.usembassy.gov/embassy/jobs/> to apply for these vacancies.

General Maintenance Technician

Position is located in the Facilities Maintenance Office. Under the direct supervision of the Maintenance Supervisor, the incumbent's primary duties are the maintenance and repair of various facility systems and trades, including electrical, carpentry, plumbing, and painting activities located in the Chancery building, residential housing, and other operational buildings, both U.S. Government-Owned and leased.

Trades Helper

Located in the Facilities Maintenance Section and supervised by the Maintenance Supervisor, the incumbent will assist Maintenance Technicians in the completion of Work Orders in the different trades (Electrical, HVAC, and Plumbing). Works independently on semi-skilled requests and on any painting requirements. Works on all U.S. Government facilities including office buildings and residential.

FOR FURTHER INFORMATION: The complete position description listing all of the duties and responsibilities may be obtained on our website at <https://na.usembassy.gov/embassy/jobs/>

EQUAL EMPLOYMENT OPPORTUNITY: The U.S. Mission provides equal opportunity and fair and equitable treatment in employment to all people without regard to race, color, religion, sex, national origin, age, disability, political affiliation, marital status, or sexual orientation. The Department of State also strives to achieve equal employment opportunity in all personnel operations through continuing diversity enhancement programs.

TE KOOP SKOON ROLLE WIT KOERANTPAPIER VIR VELE GEBRUIKE

•PANEELKLOPPERS •NYWERHEDE •RESTAURANTE
•SKOLE •VERPAKKINGSMATERIAAL

per kg
Prys op aanvraag

SKAKEL AGNES: 330 500 OF CHANTEL: 330 502
2 - 4 EIDERSTRAAT, LAFRENS INDUSTRIEEL

NME NAMIBIA MEDIA EVENTS BROADCASTING SCHEDULE THURSDAY - 15 JULY 2021

ONLINE SHOWS FACEBOOK PAGES LIVE

NMH NAMIBIA MEDIA HOLDINGS SCAN THE QR CODE TO WATCH ALL SHOWS Or visit the website: www.networkmediahub.com

TIME	BROADCAST	Sun	Rep	AZ	Zone	WE	Erongo	Evi	S	Die Boer	tjil	NMH	Zone
06:30 - 07:00	FLEX	●	●	●	●	●	●	●	●	●	●	●	●
07:00 - 08:00	AFRICA GOOD MORNING	●	●	●	○	●	●	○	○	○	○	●	○
08:00 - 09:00	AFRICA GOOD MORNING - REPEAT	●	●	●	○	●	●	○	○	○	○	●	○
08:00 - 08:30	EVENING REVIEW REPEAT	●	○	○	○	●	●	○	○	○	○	●	○
08:30 - 09:00	NMH AD SPOTTER	●	●	●	○	●	●	○	○	○	○	●	○
09:00 - 09:30	ACTIVE KIDS	○	●	○	●	●	●	○	○	○	○	●	●
10:30 - 11:00	WE TALK	●	●	●	○	●	●	○	○	○	○	●	○
11:00 - 11:30	KLETSKOMPAS	○	●	○	○	○	●	○	○	○	○	●	○
12:00 - 12:30	ERONGO TALK	●	●	●	○	●	●	○	○	○	○	●	○
13:00 - 13:30	NMH @1 LIVE	●	●	●	●	●	●	○	○	○	○	●	○
14:00 - 14:30	MY ZONE - VARSITY CHAT ROOM	○	○	○	●	●	●	○	○	○	○	●	●
15:30 - 16:00	SPORT WRAP	●	●	●	○	●	●	○	●	○	○	●	○
17:30 - 18:00	FLEX - REPEAT	●	●	●	○	●	●	○	○	○	○	●	○
18:00 - 18:30	EVENING REVIEW	●	○	○	○	●	●	○	○	○	○	●	○

Annexure C: Public Participation process
I&AP Database & Registered List
Notification Emails sent of BID
Notification Emails sent of DESR
Comments received (if any)

POTENTIAL I&APs AND STAKEHOLDERS INVITATION LIST

	STAKEHOLDERS NAME	ORGANIZATION
PRE-IDENTIFIED		
1	Mbeuta Ua-Ndjarakana	Ministry of Information and Communication Technology
2	P Misika	Ministry of Agriculture, Water and Land Reform (MAWLR) -Executive Director
3	M. Amakali	MAWLR - Director Water Resource Management
4	B Swartz	MAWLR- Deputy Director of Geohydrology
5	P Mufeti	MAWLRDeputy Director- Hydrology
6	C Orthman	MAWLR- Deputy Director Water Environment
7	B. Shinguadja	Ministry of Labour Industrial Relations and employment creation- Executive Director
8	B Namgombe	Ministry of Health and Social Services- Executive Director
9	E. Shivolo	Ministry of Mines and Energy (MME) - Mining Commissioner
10	Ndamona Elias	MME - Inspector
11	W Goeieman	Ministry of Works and Transport- Executive Director
12	T. Nghitila	Ministry of Environment Forestry and Tourism (MEFT) - Executive Director
13	T. Mufeti	MEFT - Environmental Comissioner
14	Tobias Nwaya	Ministry of Urban and Rural Development
15	N. P Du Plessis	NamWater Senior Environmentalist
16	Jolanda Murangi	Namwater Environmentalist In Training
17	C. Sisamu	Nampower Senior Enviromentalist
18	Gert Fourie	Nampower - Engineering, Planning and Design
19	B. Korhs	Earth life Namibia
20	F Kreitz	Namibian Environment and Wildlife Society - Media, website and newsletter
21	Sonja Loots	Manager: Threatened Plants Programme, National Botanical Research Institute
22	Conrad Lutombi	Roads Authority - Chief Executive Officer
23	Elina Lumbu	Roads Authority - Specialised road Legislation, Advise & Compliance
25	Vanessa Stein	Forester: National Botanical Research Institute (NBRI)
26	Fransiska Nghitila	NWR-Environmental and Compliance Specialist

POTENTIAL I&APs AND STAKEHOLDERS INVITATION LIST

	STAKEHOLDERS NAME	ORGANIZATION
27	Robert Nandaa Kahimise	City of Windhoek :CEO
28	P van Rensburg	City of Windhoek:Urban and Transport Planning
29	Grazy Tshipo	City of Windhoek: Environmental Officer
30		Ondekarmeba Lodge
31	Ms. Sibeso Mudabeti	UNAM Neudam Campus Campus Administrator Portion B Farm Neudam No 63
32	Bisey /Uirab	Namibia Airports Company: CEO Farm Ondekaremba No 78, Portion 6 (B)
33	U Rückleben	

Stephanie Strauss

From: Bronwynn Basson <bronwynn@spc.com.na>
Sent: Friday, July 16, 2021 2:10 PM
Subject: Environmental Impact Assessment: Subdivision of Portion 5 (Ondekaremba Kleinsiedlung) of Farm Ondekaremba No. 78 - RESEND
Attachments: 21-0611 BID Ondekaremba.pdf

Dear Potential Interested and Affected Party

Stubenrauch Planning Consultants (SPC) hereby give notice to all potentially Interested and Affected Parties (I&APs) that an application will be made to the Environmental Commissioner in terms of the Environmental Management Act (No 7 of 2007) and the Environmental Impact Assessment Regulations (GN 30 of 6 February 2012) for the following:

- **Subdivision of Portion 5 (Ondekaremba Kleinsiedlung) of Farm Ondekaremba No.78 into Portions A to J and Remainder;**
- **Registration of a 20 meter Right of Way Servitude over Farm Neudam No 63 in favour of Portion 5 of Farm Ondekaremba No 78;**
- **Registration of a 20 meter Right of Way Servitude over the Remainder of Portion 5 in favour of Portions A to J.**

The proposed activities trigger listed activities as per the List of Activities requiring Environmental Clearance (Government Notice 29 of 6 February 2012) and accordingly require an Environmental Impact Assessment (EIA) to be conducted.

In line with Regulation 21(2) of the mentioned EIA Regulations, a Background Information Document (BID) is distributed to pre-identified Interested and Affected Parties as part of the public consultation process for this EIA.

An Environmental Assessment will be undertaken to determine the potential impact of the development on the environment and to determine all environmental, safety, health and social impacts associated with the proposed development activities. A background information document is attached detailing the activity and the intended environmental assessment process.

In line with Namibia's Environmental Management Act (No. 7 of 2007) and EIA regulations (GN 30 of 6 February 2012), all I&APs are hereby invited to register and submit their comments, concerns or questions in writing via Email: bronwynn@spc.com.na; Tel: 061 25 11 89 or Fax: 061 25 21 57 on or before **5 August 2021**.

Kind regards

Bronwynn Basson | Stubenrauch Planning Consultants

Tel: +264 61 251189 | Fax: +264 61 252157 | PO Box 41404



Disclaimer

The information contained in this communication from the sender is confidential. It is intended solely for use by the recipient and others authorized to receive it. If you are not the recipient, you are hereby notified that any disclosure, copying, distribution or taking action in relation of the contents of this information is strictly prohibited and may be unlawful.

This email has been scanned for viruses and malware, and may have been automatically archived by **Mimecast Ltd**, an innovator in Software as a Service (SaaS) for business. Providing a **safer** and **more useful** place for your human generated data. Specializing in; Security, archiving and compliance. To find out more [Click Here](#).

Reg. No. 95/00909
Feld Str. 45
PO Box 41404
Windhoek
Namibia

Tel: +264 61 251189
+264 61 252490
Fax: +264 61 252157
gunther@spc.com.na
www.spc.com.na

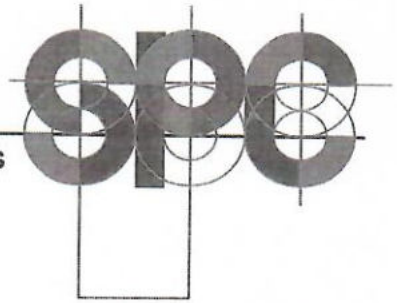

Our Ref: W/19063
Enquiries: Bronwynn Basson

24 August 2021

The Chief Executive Officer
City of Windhoek
PO Box 59
Windhoek



Dear Sir/Madam

**AVAILABILITY OF DRAFT ENVIRONMENTAL ASSESSMENT REPORT FOR COMMENT
Subdivision of Portion 5 (Ondekaremba Kleinsiedlung) of Farm Ondekaremba No. 78**

Stubenrauch Planning Consultants cc (SPC) has been appointed to undertake the above environmental assessment. SPC hereby give notice to all registered Interested and Affected Parties (I&APs) that the Draft Environmental Scoping Report (DESR) is now available for the above proposed project for public comment from **30 August 2021 until 13 September 2021**. Please find attached a copy of the report for review and comment by the Municipality.

Should you wish to comment on the proposed project, kindly do so in writing on or before **13 September 2021** by one of the following means:

Addressed to: Stubenrauch Planning Consultants (SPC)

Address: PO Box 41404, Windhoek

Email: Bronwynn@spc.com.na

Tel no.: +264 61 25 11 89

Fax no.: +264 61 25 21 57

The DESR will be finalised in light of feedback from I&APs and Stakeholders and will then be submitted to Ministry of Environment, Forestry and Tourism: Department of Environmental Affairs (MEFT: DEA) for consideration and decision making. If MEFT: DEA approves or requests additional information/ studies, all registered I&APs and Stakeholders will be kept informed of progress throughout the assessment process.

Yours faithfully

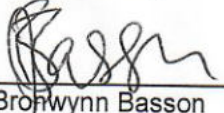
Bronwynn Basson

Stephanie Strauss

From: Bronwyn Basson <bronwyn@spc.com.na>
Sent: Monday, August 30, 2021 4:31 PM
Subject: AVAILABILITY OF DRAFT ENVIRONMENTAL ASSESSMENT REPORT FOR COMMENT:
Subdivision of Portion 5 (Ondekaremba Kleinsiedlung) of Farm Ondekaremba No. 78
21-0611_Ondekaremba_Executive Summary.pdf
Attachments:
Importance: High

Dear Potential Interested and Affected Party

Stubenrauch Planning Consultants cc (SPC) hereby give notice to all Registered Interested and Affected Parties (I&APs) that the Draft Environmental Scoping Report (DESR) is now available for the above proposed project for public comment from **30 August 2021 until 13 September 2021** at the following venues:

Stubenrauch Planning Consultants
45 Feld Street
Windhoek

Windhoek National Library
130 Robert Mugabe Avenue
Windhoek

An electronic copy of the report is available for download for your review at the below Dropbox link:
<https://www.dropbox.com/s/jx3xi4rfsnzxl0s/21-0611%20Ondekaremba%20DESR.pdf?dl=0>

Should you wish to comment on the proposed project, kindly do so in writing on or before **13 September 2021** by one of the following means:

Addressed to: Stubenrauch Planning Consultants (SPC)
Address: PO Box 41404, Windhoek
Email: Bronwyn@spc.com.na
Tel No.: +264 61 25 11 89
Fax No.: +264 61 25 21 57

The DESR will be finalised in light of feedback from I&APs and Stakeholders and will then be submitted to Ministry of Environment Forestry and Tourism (MEFT): Department of Environmental Affairs (DEA) for consideration and decision making. If MEFT: DEA approves or requests additional information/ studies, all registered I&APs and Stakeholders will be kept informed of progress throughout the assessment process.

Please feel free to contact our office should you need any additional information.

Bronwyn Basson | Stubenrauch Planning Consultants

Tel: +264 61 251189 | Fax: +264 61 252157 | PO Box 41404



Disclaimer

The information contained in this communication from the sender is confidential. It is intended solely for use by the recipient and others authorized to receive it. If you are not the recipient, you are hereby notified that any disclosure, copying, distribution or taking action in relation of the contents of this information is strictly prohibited and may be unlawful.

This email has been scanned for viruses and malware, and may have been automatically archived by **Mimecast Ltd**, an innovator in Software as a Service (SaaS) for business. Providing a **safer** and **more useful** place for your human generated data. Specializing in; Security, archiving and compliance. To find out more [Click Here](#).

Annexure D: Curriculum Vitae and ID of Environmental Assessment Practitioner

STEPHANIE STRAUSS

PERSONAL INFORMATION

DATE OF BIRTH 24 JULY 1987
ID NUMBER 87072400017
CITIZENSHIP NAMIBIAN (PRP HOLDER)
DRIVERS LICENSE CODE 08
MARITAL STATUS MARRIED

LANGUAGES

ENGLISH: READING WRITING SPEAKING - EXCELLENT
AFRIKAANS: READING WRITING SPEAKING - EXCELLENT

EMPLOYMENT RECORD

APRIL 2019- PRESENT-

ENVIRONMENTAL ASSESSMENT PRACTITIONER, GCS WATER AND ENVIRONMENTAL ENGINEERING

Project co-ordination
Environmental Assessment
Client Liaison
Stakeholder Engagement
Authority Liaison
Environmental auditing and monitoring.

JULY 2016-MARCH 2019

JUNIOR EAP, AFRICA PLANNING FORUM

Technical Report Writing
Impact Assessment Environmental Management Planning
Environmental Compliance and Monitoring
Stakeholder Engagement

JULY 2013-JUNE 2016

TOWN PLANNER TRAINEE, STUBENRAUCH PLANNING CONSULTANTS

Statutory Planning
Structure Plan Baseline research and Report Writing
Environmental Assessment
GIS Base Mapping Structure Plans

2010

STUDENT ASSISTANT, UNIVERSITY OF NAMIBIA

TECHICAL EXPERTISE

- Project management
- Impact assessment
- Public participation and stakeholder engagement
- Environmental management and mitigation
- Environmental monitoring and auditing
- Client engagement

EDUCATIONAL QUALIFICATION

2019- PRESENT

MPHIL ENVIRONMENTAL MANAGEMENT, STELLENBOSCH UNIVERSITY

2018

POST GRADUATE IPLOMA ENVIRONMENTAL MAANGEMENT (CUM LAUDE),
STELLENBOSCH UNIVERSITY

2012

HONOURS DEGREE IN GEOGRAPHY AND ENVIRONMENTAL STUDIES),
UNIVESRITY OF NAMIBIA

PROFESSIONAL AFFILIATIONS

Environmental Assessment Practitioners of Namibia (EAPAN) [Exco member 2020]

Namibia Institute of Town and Regional Planners (NITRP)

SKILLS

- Computer literate and equipped with skills in Microsoft Word, PowerPoint and Excel
- GIS and Remote sensing- ArcView, ArcMap and ILWIS
- ReGis- Basic Knowledge