

APPROVED

No. A723/2017

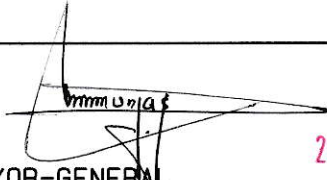

2017 -11- 14

SURVEYOR-GENERAL

SHEET 1 OF 2 SHEETS

SIDES Metres	ANGLES OF DIRECTION ° ' "		CO-ORDINATES System 22/17		DESIGNATION	
			y	x		
AB	748, 10	264 41 10	A	25 017, 48	72 230, 54	1001
BC	3531, 25	12 53 28	B	24 272, 59	72 161, 24	5733
CD	703, 21	113 25 20	C	25 060, 40	75 603, 50	H006
DE	740, 25	54 23 00	D	25 705, 66	75 323, 96	LAAG
EF	60, 47	100 13 30	E	26 307, 43	75 755, 06	Lank
FG	402, 49	196 53 20	F	26 366, 94	75 744, 33	1016
GH	84, 22	177 10 30	G	26 250, 01	75 359, 20	1015
HJ	351, 14	197 20 10	H	26 254, 17	75 275, 08	1014
JK	199, 35	179 45 20	J	26 149, 53	74 939, 89	1013
KL	116, 33	167 35 30	K	26 150, 38	74 740, 54	1012
LM	258, 24	164 30 00	L	26 175, 37	74 626, 93	1009
MN	323, 03	185 43 30	M	26 244, 39	74 378, 07	1008
NP	213, 53	195 36 00	N	26 212, 16	74 056, 66	1007
PQ	524, 38	223 56 00	P	26 154, 73	73 850, 99	1004
QR	393, 23	230 31 00	Q	25 790, 91	73 473, 36	104
RS	291, 37	196 35 30	R	25 487, 42	73 223, 33	1003
ST	247, 57	224 04 50	S	25 404, 21	72 944, 08	103
TA	577, 05	201 49 20	T	25 231, 98	72 766, 24	1002
CONNECTING DATA						
Bb	103, 60	264 41 10	b	24 169, 44	72 151, 65	RIVER1
Cc	241, 45	270 13 20	C	24 818, 95	75 604, 43	RIVER2
		No. 123	△	34 214, 08	73 234, 93	LANDMISTER
		No. 257	△	16 946, 03	72 931, 36	FRIED

DESCRIPTION OF BEACONS

- B - Square peg in cairn
- C D E - Iron peg next to standard
- b c - Not Marked
- All Other - Y Iron Fencing Standard in cairn

The figure A B b middle of river c C D E F G H J K L M N P Q R S T represents 353,2588 Hectares of land being

FARM 569 (a Portion of FARM LANDMISTER No.331)

situate in the Registration Division K
KHOMAS Region
REPUBLIC OF NAMIBIA

Surveyed in October 2016 by me



.....
Land Surveyor
G. Marwa (Reg. No. 034)

This diagram is annexed to	The original diagram is	S.R. No.E264/2017
Transfer No.	No.A457/60 annexed to	Noting Plan.MFS
dated	Grant No. GG65/1961	Lat. 22° 39' S
	Registered of Deeds dated 3-08-1961	Long. 16° 45'E

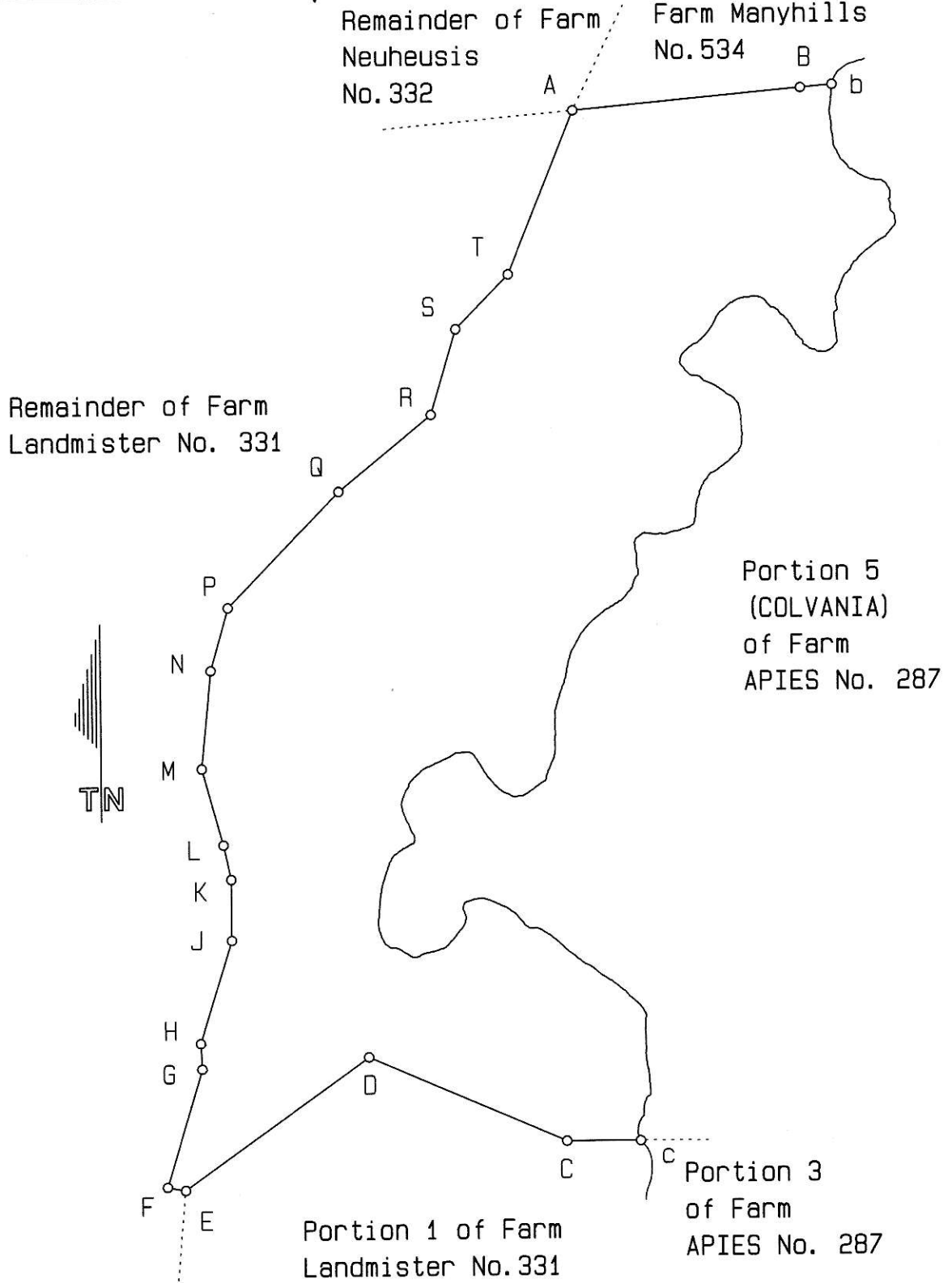

Surveyed in May 2016 by me

G. Marwa

 Land Surveyor
 G. Marwa (Reg. No. 034)