

POTENTIAL I&APs AND STAKEHOLDERS INVITATION LIST – GOBABIS DEVELOPMENT STAR MERCHANDISING PHASE 2

	NAME	ORGANIZATION	TEL:	E-MAIL/OR ADDRESS
1	D Nghidinua	MURD PS	061297511	akamupembe@murd.gov.na
2	C. Tubalike	MURD	0612975062	ctubalike@murd.gov.na
3	M. Amakali	MAWF - Acting Director of Water and Environment	061 208 7158	amakalim@mawf.gov.na
4	H. Koch	MAWF - Director of Resource Management	061 208 7266	KochH@mawf.gov.na
5	P. Mufeti	MAWF - Acting deputy Director of Hydrology	061 208 7257	mufetip@mawf.gov.na
6	T. Mufeti	MET - Environmental Commissioner	061 284 2701	Timoteus.Mufeti@met.gov.na
7		Town Planner - Gobabis Municipality		
8	J Endyala	Town Engineer - Gobabis Municipality	062 562 551	jendyala@yahoo.com
9	S Adonis	Acting CEO- Gobabis Municipality	062 562 551	info@gobabis.org
10	M. Mberira	Planner - Gobabis Municipality	062 562 551	mmberira@gobmun.com.na
11	Willem Venter	NamWater - Senior Manager: Fixed Asset Management	061712039	venterw@namwater.com.na
12	Gert Fourie	Nampower - Engineering, Planning and Design	0612054111	gert.fourie@nampower.com.na
13	Conrad Lutombi	Roads Authority - CEO	264 61 284 7000	pr@ra.org.na
14	De Paauw	Roads Authority - Specialist Road Legislation, Advise and Compliance	061 284 7027	depaauwe@ra.org.na
15	B. Korhs	Earth life Namibia	061 202 2041	earthl@iway.na
16	B. Eimbeck	Wildlife Society	061 306 450	Information@NEWS-Namibia.org
17	Esmeralda Strauss	National Botanical Research Institute (Namibia)	061 - 202 9111	essies@nbri.org.na
18	Christian Ita	Star Merchandising	0812553299	christianita4@gmail.com
19	Augustinus Tebele	Constituency Councillor - Gobabis	+264 62 564 780	kopangtebele@yahoo.com
20	Mr. Karukirue Tjijenda	Acting Chief Regional Officer - Omaheke Regional Council	+264 62 566 504	vaendwanawam@gmail.com
21	Percy W. Misika	MAWF - Executive Director	061 208 7111	nehemiaa@mawf.gov.na
22	Cynthia Orthman	MAWF - Deputy Director of Water Environment	061 208 7158	Cynthia.Ortmann@mawf.gov.na
23	A Nehemia	CEO - Namwater	+264 61 71 0000	NehemiaA@namwater.com.na
24	S Haulofu	MD - Nampower	061 205 4111	simson.haulofu@nampower.com.na

POTENTIAL I&APs AND STAKEHOLDERS INVITATION LIST – GOBABIS DEVELOPMENT STAR MERCHANDISING - PHASE 1

	NAME	ORGANIZATION	TEL:	E-MAIL/OR ADDRESS
1	D Nghidinua	MURD PS	061297511	akamupembe@murd.gov.na
2	C. Tubalike	MURD	0612975062	ctubalike@murd.gov.na
3	M. Amakali	MAWF - Acting Director of Water and Environment	061 208 7158	amakalim@mawf.gov.na
4	H. Koch	MAWF - Director of Resource Management	061 208 7266	KochH@mawf.gov.na
5	P. Mufeti	MAWF - Acting deputy Director of Hydrology	061 208 7257	mufetip@mawf.gov.na
6	T. Mufeti	MET - Environmental Commissioner	061 284 2701	Timoteus.Mufeti@met.gov.na
7	Patrick Mbala	Town Planner - Gobabis Municipality	062 562 551	psm223@gmail.com
8	J Endyala	Town Engineer - Gobabis Municipality	062 562 551	jendyala@yahoo.com
9	I K Thudinyane	CEO- Gobabis Municipality	062 562 551	info@gobabis.org ; ikthudi@gmail.com
10	M. Mberira	Planner - Gobabis Municipality	062 562 551	mmberira@gobmun.com.na
11	Willem Venter	NamWater - Senior Manager: Fixed Asset Management	061712039	venterw@namwater.com.na
12	Gert Fourie	Nampower - Engineering, Planning and Design	0612054111	gert.fourie@nampower.com.na
13	Conrad Lutombi	Roads Authority - CEO	264 61 284 7000	pr@ra.org.na
14	De Paauw	Roads Authority - Specialist Road Legislation, Advise and Compliance	061 284 7027	depaauwe@ra.org.na
15	B. Korhs	Earth life Namibia	061 202 2041	earthl@iway.na
16	B. Eimbeck	Wildlife Society	061 306 450	Information@NEWS-Namibia.org
17	Esmeralda Strauss	National Botanical Research Institute (Namibia)	061 - 202 9111	essies@nbri.org.na
18	Christian Ita	Star Merchandising	0812553299	christianita4@gmail.com
19	Augustinus Tebele	Constituency Councillor - Gobabis	+264 62 564 780	kopangtebele@yahoo.com
20	Mr. Karukirue Tjjenda	Acting Chief Regional Officer - Omaheke Regional Council	+264 62 566 504	vaendwanawam@gmail.com
21	Percy W. Misika	MAWF - Executive Director	061 208 7111	nehemiaa@mawf.gov.na
22	Cynthia Orthman	MAWF - Deputy Director of Water Environment	061 208 7158	Cynthia.Ortmann@mawf.gov.na
23	A Nehemia	CEO - Namwater	+264 61 71 0000	NehemiaA@namwater.com.na
24	S Haulofu	MD - Nampower	061 205 4111	simson.haulofu@nampower.com.na



Wed 30/06/2021 21:11

Colin P Namene <colin@environam.com>

Township Establishment on a Portion of Portion 143 of Gobabis Town and Townlands No. 114, Nossobville, Gobabis

To

Cc 'kgalemangmakgone@gmail.com'

Bcc 'akamupembe@murd.gov.na'; 'ctubalike@murd.gov.na'; 'amakalim@mawf.gov.na'; 'KochH@mawf.gov.na'; 'mufetip@mawf.gov.na'; 'Timoteus.Mufeti@met.gov.na'; 'psm223@gmail.com'; 'jendyala@yahoo.com'; 'info@gobabis.org'; 'kthudi@gmail.com'; 'mberira@gobmun.com.na'; 'venterw@namwater.com.na'; 'gert.fourie@nampower.com.na'; 'pr@ra.org.na'; 'depaauwe@ra.org.na'; 'earthl@way.na'; 'information@NEWS-Namibia.org'; 'essies@nbri.org.na'; 'christianita4@gmail.com'; 'kopangtebele@yahoo.com'; 'vaendwanawam@gmail.com'; 'nehemiaa@mawf.gov.na'; 'Cynthia.Ortmann@mawf.gov.na'; 'NehemiaA@namwater.com.na'; 'simson.haulofu@nampower.com.na'; 'kgalemangmakgone@gmail.com'

Message BID URP.pdf (583 KB)

Dear Interested and Affected Party

Environam Consultants Trading is a wholly Namibian owned environmental management consultancy providing an array of environmental services to our clients including: Strategic Environmental Assessments; Environmental Assessments; Strategic Environmental Management Plans; Environmental Management Plans; Environmental Management Systems; Environmental Auditing, Monitoring and Evaluation; Solid Waste Management; and Project Management. Our daily activities are underpinned by excellent environmental outcomes aimed at achieving a symbiotic relationship between development and the environment.

We have been appointed by Star Merchandising cc to undertake the environmental scoping exercise and apply for an environmental clearance certificate from the Environmental Commissioner for the project below:

The Township Establishment on a Portion of Portion 143 of Gobabis Town and Townlands No. 114, Nossobville, Gobabis.

The construction of - oil, water, gas and petrochemical and other bulk supply pipelines; the construction of - Public roads; The route determination of roads and design of associated physical infrastructure where - it is a public road are listed activities as per the *List of Activities requiring Environmental Clearance* (Government Notice 29 of 6 February 2012) and accordingly require an Environmental Impact Assessment (EIA) to be conducted.

In line with Regulation 21(2) of the mentioned EIA Regulations, a Background Information Document (BID) is distributed to pre-identified Interested and Affected Parties as part of the public consultation process for this Environmental Impact Assessment.

An Environmental assessment will be undertaken to determine the potential impact of the development on the environment and to determine all safety, health and social impacts associated with the proposed development activities.

Should you require any additional information or would like to register as an I&AP, please contact our office, Tel: +264 814 584 297, Fax: +264 61 258 470 or E-Mail: colin@environam.com; P.O. Box 24056, Windhoek, on or before 16 July 2021.

Regards,

Colin P Namene

FILE

MESSAGE



Wed 30/06/2021 21:11

Colin P Namene <colin@environam.com>

Township Establishment on a Portion of Portion 143 of Gobabis Town and Townlands No. 114, Nossobville, Gobabis

To

Cc 'kgalemangmakgone@gmail.com'

Bcc 'akamupembe@murd.gov.na'; 'ctubalike@murd.gov.na'; 'amakalim@mawf.gov.na'; 'KochH@mawf.gov.na'; 'mufetip@mawf.gov.na'; 'Timoteus.Mufeti@met.gov.na'; 'psm223@gmail.com'; 'jendyala@yahoo.com'; 'info@gobabis.org'; 'kthudi@gmail.com'; 'mberira@gobmun.com.na'; 'venterw@namwater.com.na'; 'gert.fourie@nampower.com.na'; 'pr@ra.org.na'; 'depaauwe@ra.org.na'; 'earthl@way.na'; 'information@NEWS-Namibia.org'; 'essies@nbri.org.na'; 'christianita4@gmail.com'; 'kopangtebele@yahoo.com'; 'vaendwanawam@gmail.com'; 'nehemiaa@mawf.gov.na'; 'Cynthia.Ortmann@mawf.gov.na'; 'NehemiaA@namwater.com.na'; 'simson.haulofu@nampower.com.na'; 'kgalemangmakgone@gmail.com'

Message BID URP.pdf (583 KB)

Should you require any additional information or would like to register as an I&AP, please contact our office, Tel: +264 814 584 297, Fax: +264 61 258 470 or E-Mail: colin@environam.com; P.O. Box 24056, Windhoek, on or before 16 July 2021.

Regards,

Colin P Namene

Managing Director



Unit 14, Barleo Park, Kudugas Street • Windhoek, Namibia
Environam Consultants Trading cc

+264-814-584-297

colin@environam.com



MESSAGE



Fri 23/07/2021 12:30

John Endyala <jendyala@yahoo.com>

Re: TOWNSHIP ESTABLISHMENT ON A PORTION OF PORTION 143 OF GOBABIS TOWN AND TOWNLANDS NO. 114, NOSSOBVILLE, GOBABIS, OMAHEKE REGION

To: Colin P Namene

Mr. Colin

Your email is well received.

Regards

John Endyala
Civil Manager: Technical Services
Gobabis Municipality

Tel: +264 62 577300
Cell: +264 81 1291 293 / 81 4730 207
Fax: +264 62 562410

On Friday, July 23, 2021, 10:14:05 AM GMT+2, Colin P Namene <colin@environam.com> wrote:

Dear Mr Endyala

We have the pleasure to inform you that the draft Environmental Scoping Report (DESR) and draft Environmental Management Plan (EMP) for the abovementioned project have been completed. We herewith notify all registered Interested and Affected Parties that the document is available for public comment from **22 July 2021 to 06 August 2021**.

Copies of the DESR and EMP are attached to this communication.

Kindly provide your written comments and input to Environam Consultants Trading on or before **06 August 2021**, using any of the following methods:

P.O. Box 24056, Windhoek



MESSAGE



Wed 21/07/2021 18:30

Colin P Namene <colin@environam.com>

TOWNSHIP ESTABLISHMENT ON A PORTION OF PORTION 143 OF GOBABIS TOWN AND TOWNLANDS NO. 114, NOSSOBVILLE, GOBABIS, OMAHEKE REGION

To

Bcc: [] 'akamupembe@murd.gov.na'; [] 'ctubalike@murd.gov.na'; [] 'amakalim@mawf.gov.na'; [] 'KochH@mawf.gov.na'; [] 'mufetip@mawf.gov.na'; [] 'Timoteus.Mufeti@met.gov.na'; [] 'info@gobabis.org'; [] 'venterw@namwater.com.na'; [] 'gert.fourie@nampower.com.na'; [] 'pr@ra.org.na'; [] 'depauwe@ra.org.na'; [] 'earth@iway.na'; [] 'Information@NEWS-Namibia.org'; [] 'essies@nbri.org.na'; [] 'christianita4@gmail.com'; [] 'kopangtebele@yahoo.com'; [] 'vaendwanawam@gmail.com'; [] 'nehemiaa@mawf.gov.na'; [] 'Cynthia.Ortmann@mawf.gov.na'; [] 'NehemiaA@namwater.com.na'; [] 'simson.haulofu@nampower.com.na'

You replied to this message on 23/07/2021 10:12.

Message Portion 143 Exec Summary.pdf (95 KB)

Dear Interested and Affected Party

We have the pleasure to inform you that the draft Environmental Scoping Report (DESR) and draft Environmental Management Plan (EMP) for the abovementioned project have been completed. We herewith notify all registered Interested and Affected Parties that the document is available for public comment from **22 July 2021 to 06 August 2021**.

An executive summary of the DESR is attached to this communication. A soft copy of the DESR will be made available electronically on request.

Kindly provide your written comments and input to Environam Consultants Trading on or before **06 August 2021**, using any of the following methods:

P.O. Box 24056, Windhoek

Email: colin@environam.com

Cell: +264 814 584 297

Fax: +264 61 258 470

Input received during the comment period will be incorporated into the Final Environmental Scoping Report that will be submitted to the Office of the Environmental Commissioner in the Ministry of Environment, Forestry and Tourism for consideration and decision making.

FILE

MESSAGE



Wed 21/07/2021 18:30

Colin P Namene <colin@environam.com>

TOWNSHIP ESTABLISHMENT ON A PORTION OF PORTION 143 OF GOBABIS TOWN AND TOWNLANDS NO. 114, NOSSOBVILLE, GOBABIS, OMAHEKE REGION

To

Bcc 'akamupembe@murd.gov.na'; 'ctubalike@murd.gov.na'; 'amakalim@mawf.gov.na'; 'KochH@mawf.gov.na'; 'mufetip@mawf.gov.na'; 'Timoteus.Mufeti@met.gov.na'; 'info@gobabis.org'; 'venterw@namwater.com.na'; 'gert.fourie@nampower.com.na'; 'pr@ra.org.na'; 'depaauwe@ra.org.na'; 'earth@iway.na'; 'Information@NEWS-Namibia.org'; 'essies@nbri.org.na'; 'christianita4@gmail.com'; 'kopangtebele@yahoo.com'; 'vaendwanawam@gmail.com'; 'nehemiaa@mawf.gov.na'; 'Cynthia.Ortmann@mawf.gov.na'; 'NehemiaA@namwater.com.na'; 'simson.haulofu@nampower.com.na'

You replied to this message on 23/07/2021 10:12.

Message Portion 143 Exec Summary.pdf (95 KB)

PO BOX 27000, WINDHOEK

Email: colin@environam.com

Cell: +264 814 584 297

Fax: +264 61 258 470

Input received during the comment period will be incorporated into the Final Environmental Scoping Report that will be submitted to the Office of the Environmental Commissioner in the Ministry of Environment, Forestry and Tourism for consideration and decision making.

Regards,

Colin P Namene

Managing Director



Unit 14, Barleo Park, Kudugas Street • Windhoek, Namibia
Environam Consultants Trading cc

+264-814-584-297
colin@environam.com



Wed 21/07/2021 18:30

Colin P Namene <colin@environam.com>

TOWNSHIP ESTABLISHMENT ON A PORTION OF PORTION 143 OF GOBABIS TOWN AND TOWNLANDS NO. 114, NOSSOBVILLE, GOBABIS, OMAHEKE REGION

To

Bcc 'akamupembe@murd.gov.na'; 'ctubalike@murd.gov.na'; 'amakalim@mawf.gov.na'; 'KochH@mawf.gov.na'; 'mufetip@mawf.gov.na'; 'Timoteus.Mufeti@met.gov.na'; 'info@gobabis.org'; 'venterw@namwater.com.na'; 'gert.fourie@nampower.com.na'; 'pr@ra.org.na'; 'depauwe@ra.org.na'; 'earth@iway.na'; 'Information@NEWS-Namibia.org'; 'essies@nbri.org.na'; 'christianita4@gmail.com'; 'kopangtebele@yahoo.com'; 'vaendwanawam@gmail.com'; 'nehemiaa@mawf.gov.na'; 'Cynthia.Ortmann@mawf.gov.na'; 'NehemiaA@namwater.com.na'; 'simson.haulofu@nampower.com.na'

Message Portion 143 Exec Summary.pdf (95 KB)

Dear Interested and Affected Party

We have the pleasure to inform you that the draft Environmental Scoping Report (DESR) and draft Environmental Management Plan (EMP) for the abovementioned project have been completed. We herewith notify all registered Interested and Affected Parties that the document is available for public comment from **22 July 2021 to 06 August 2021**.

An executive summary of the DESR is attached to this communication. A soft copy of the DESR will be made available electronically on request.

Kindly provide your written comments and input to Environam Consultants Trading on or before **06 August 2021**, using any of the following methods:

P.O. Box 24056, Windhoek

Email: colin@environam.com

Cell: +264 814 584 297

Fax: +264 61 258 470

Input received during the comment period will be incorporated into the Final Environmental Scoping Report that will be submitted to the Office of the Environmental Commissioner in the Ministry of Environment, Forestry and Tourism for consideration and decision making.

Regards,

FILE

MESSAGE



Wed 21/07/2021 18:30

Colin P Namene <colin@environam.com>

TOWNSHIP ESTABLISHMENT ON A PORTION OF PORTION 143 OF GOBABIS TOWN AND TOWNLANDS NO. 114, NOSSOBVILLE, GOBABIS, OMAHEKE REGION

To

Bcc 'akamupembe@murd.gov.na'; 'ctubalike@murd.gov.na'; 'amakalim@mawf.gov.na'; 'KochH@mawf.gov.na'; 'mufetip@mawf.gov.na'; 'Timoteus.Mufeti@met.gov.na'; 'info@gobabis.org'; 'venterw@namwater.com.na'; 'gert.fourie@nampower.com.na'; 'pr@ra.org.na'; 'depauwe@ra.org.na'; 'earth@iway.na'; 'Information@NEWS-Namibia.org'; 'essies@nbri.org.na'; 'christianita4@gmail.com'; 'kopangtebele@yahoo.com'; 'vaendwanawam@gmail.com'; 'nehemiaa@mawf.gov.na'; 'Cynthia.Ortmann@mawf.gov.na'; 'NehemiaA@namwater.com.na'; 'simson.haulofu@nampower.com.na'

Message Portion 143 Exec Summary.pdf (95 KB)

P.O. BOX 24030, WINDHOEK

Email: colin@environam.com

Cell: +264 814 584 297

Fax: +264 61 258 470

Input received during the comment period will be incorporated into the Final Environmental Scoping Report that will be submitted to the Office of the Environmental Commissioner in the Ministry of Environment, Forestry and Tourism for consideration and decision making.

Regards,

Colin P Namene

Managing Director



Unit 14, Barleo Park, Kudugas Street • Windhoek, Namibia
Environam Consultants Trading cc

+264-814-584-297
colin@environam.com

PUBLIC NOTICE

Please take note that KAMAU TOWN PLANNING AND DEVELOPMENT SPECIALIST has been appointed by the owner of Erf 3170 (a portion of consolidated Erf 3150) Windhoek, to apply to the local authority of Windhoek for the rezoning of the respective Erf from 'Residential' with a density of 1:900sqm to 'Business' with a bulk of 1:0and subsequently consent to use the respective Erf for a guesthouse purposes and consent to use the respective Erf as "Business" while the rezoning is in progress, as per terms of the Windhoek Town Planning Scheme.

Erf 3170 (a portion of consolidated Erf 3150) Windhoek, is located within the Windhoek West suburb in Windhoek, Salk Street. Considering its use and services offered, the subject property is ideally located central of the city with ease of access to other suburbs and one of prime and sought-after area of Windhoek. The Erf lies on a slope toward the back of the property. The respective Erf measures 1006m2 in extent and is currently built up according to the respective zoning. The respective Erf is currently zoned "Residential" with a density of 1:900m2 as per the Windhoek Town Planning Scheme.



Please further take note that -

- (a) the plan of the Erf or land lies for inspection at of the offices of the local authority (City of Windhoek);
- (b) any person having objections to the rezoning concerned or who wants to comment, may in writing lodge such objections and comments, together with the grounds, with the Chief Executive Officer Local Authority of Walvis Bay, and with the applicant within 14 days of the last publication of this notice, i.e. no later than **22 July 2021**.

FOR MORE INFORMATION AND QUERIES, KINDLY CONTACT:



No. 04 Wagner street | Windhoek west |
c: +264 81 3290584
P.O. Box 22296 | Windhoek | t: +264 61251975 |
f: +264 61 304219 |
yeli@kamau-tpds.com w: www.kamau-architects.com

PUBLIC NOTICE

Please take note that KAMAU TOWN PLANNING AND DEVELOPMENT SPECIALIST has been appointed by the owner of Erf 676 Theodor Gawaseb Street, Extension 1, Grootfontein, to apply to the local authority of Grootfontein for the rezoning of the respective Erf from 'Residential' with a density of 1:300sqm to 'General Residential' with a density of 1:100sqm and Consent to commence with construction while rezoning is in progress.

Erf 676 is located in Theodor Gawaseb Street, Extension 1 of Grootfontein and measures an extent of 473m2. The residential suburb where this Erf is found has the majority of activities taking place in terms of land use as 'Residential' and 'General Residential' (as per Grootfontein Zoning Map). Furthermore, as indicated on the respective zoning map, there is a suburb business center. Additional land use activities include the Makalani Primary School (educational), Hakahana Enterprises (business) which are located 5 blocks away from the respective Erf.



Please further take note that -

- (a) the plan of the Erf or land lies for inspection at the Grootfontein Town Councils public notice board;
- (b) any person having objections to the rezoning concerned or who wants to comment, may in writing lodge such objections and comments, together with the grounds, with the Chief Executive Officer Local Authority of Grootfontein, and with the applicant within 14 days of the last publication of this notice, i.e. no later than **22 July 2021**.

FOR MORE INFORMATION AND QUERIES, KINDLY CONTACT:



No. 04 Wagner street | Windhoek west |
c: +264 81 3290584
P.O. Box 22296 | Windhoek | t: +264 61251975 |
f: +264 61 304219 |
yeli@kamau-tpds.com w: www.kamau-architects.com



NOTICE FOR PUBLIC PARTICIPATION ENVIRONMENTAL IMPACT ASSESSMENT

Environam Consultants Trading cc (ECT) hereby gives notice to all potentially Interested and Affected Parties (I&APs) that an application will be made to the Environmental Commissioner in terms of the Environmental Management Act (No 7 of 2007) and the Environmental Impact Assessment Regulations (GN 30 of 6 February 2012) for the following:

PROJECT NAME:

Township Establishment on a Portion of Portion 143 of Gobabis Town and Townlands No. 114, Nossobville, Gobabis

PROJECT LOCATION:

Nossobville, Gobabis, Omaheke Region

PROJECT DESCRIPTION:

The proposed township will consist of approximately 270 erven, comprising Residential, General Residential, Local Business, Institutional, Public Open Space and Street land uses.

PROponent:

Star Merchandising CC

ENVIRONMENTAL ASSESSMENT PRACTITIONER (EAP):

Environam Consultants Trading cc (ECT)

REGISTRATION OF I&APs AND SUBMISSION OF COMMENTS:

In line with Namibia's Environmental Management Act (No. 7 of 2007) and EIA regulations (GN 30 of 6 February 2012), all I&APs are hereby invited to register and submit their comments, concerns or questions in writing.

Kindly contact:

Colin P Namene

Email: colin@environam.com

Fax: 061 258 470 or

Mobile: 0814 584 297 on or before **09 July 2021**.

Due to the Covid-19 situation a public meeting will not be held. Interested and affected parties are advised to provide input and comments via the contact details mentioned above.

OXYGEN CYLINDERS, CONCENTRATORS AND ACCESSORIES SUPPLY



Oxygen Cylinder with respiratory



Oxygen Concentrator with respiratory

ALL AVAILABLE IN STOCK



Oxygen Cylinder with Respiratory and Oxi Meter

DPI HEALTH
Contact: 0812029137
Email: destinyplannerinv@gmail.com
Location: Number 9 Rossini Street Windhoek West



Fish Shops

Powered by Ongudi

Locations:

HAVANA (Windhoek)	081 468 8716
OMBILI (Windhoek)	081 468 8716
GOREANGAB OKAPALE (Windhoek)	081 468 8716
OLD POWER STATION (Windhoek)	081 242 6194
GOREANGAB WOERMANNBROK (Whk)	081 499 2704
TAUBEN GLEN (Windhoek)	081 242 6194
AMAGOESA (Okahandja)	081 244 2654

A variety of fish available

PUBLIC NOTICE

ENVIRONMENTAL IMPACT ASSESSMENT

Notice is hereby given to all interested and Affected Parties (I & AP's) that an application will be made to the Environmental Commissioner for the Environmental Clearance in terms of the Environmental Management Act (No. 7 of 2007) and Environmental Impact Assessment Regulations (GN No. 30 of 6 February 2012) for the following intended activity:

PROJECT DETAILS:

- Construction and Operation of a Fuel Retail Facility on Erf 1132, Ohangwena Extension no. 5, Helao Nafidi Town.

Project Location: Erf 1132, Ohangwena Extension no. 5, Helao Nafidi Town, Ohangwena Region.

Project Description: Construction and Operation of a Fuel Retail Facility on Erf 1132, Ohangwena Extension no. 5, Helao Nafidi Town.

Proponent: One Way Investment CC

Environmental Consultants: Nghivelwa Planning Consultants

All I&APs are encouraged to register and raise concerns or provide comments and opinions. All I&APs will be provided with a Background Information Document (BID) comprising of detailed information for the intended activity. An Open day public meeting about the development will be held at:

Venue: Erf 1132, Ohangwena Extension no. 5

Date and Time: 08 JULY 2021 @ 16H00-17H00

NB: DUE TO COVID-19, THE MEETING IS CONDITIONAL TO GOVERNMENT REGULATIONS.

Should you wish to register as an I&AP and receive BID, please contact:

Nghivelwa Planning Consultants

Tel: +264 61 269697

Cell: +264 85 3232 230

Email: planning@nghivelwa.com.na

Web: www.nghivelwa.com.na

DEADLINE FOR COMMENTS: 15 JULY 2021



CALL FOR REGISTRATION AS INTERESTED AND AFFECTED PARTIES

ENVIRONMENTAL ASSESSMENT FOR THE CONSTRUCTION AND OPERATION OF A CROCODILE FARM AND PARK ON A PORTION OF THE REMAINDER OF FARM USAKOS AND TOWNLANDS NO. 93 SOUTHWEST OF THE KHAN RIVER, ERONGO REGION

1. PROJECT SITE AND DESCRIPTION

Reptilia Crocodile Farm and Park cc, intends to apply in order to obtain an Environmental Clearance Certificate for its proposed construction and operation of a Crocodile Farm on ERF on a 3 Ha land area. The key component of the proposed activity includes the construction of the farm, and operation of the facility including crocodile husbandry, lodging and tours.

2. PUBLIC PARTICIPATION PROCESS

Enviro-Leap Consulting invites all Interested and Affected Party (I & AP) to register and receive Environmental Assessment (BID, Scoping and EMP) documents relating to the proposed project for their comments and input.

Enviro-Leap Consulting invites all Interested and Affected Party (I & AP) to register and receive Environmental Assessment (BID, Scoping and EMP) documents relating to the proposed project for their comments and input.

3. COMMENTS AND QUERIES

Interested and Affected Parties are herewith request to register by writing to us at the address below no later than **30 JULY 2020**.

3. COMMENTS AND QUERIES

Please register and direct all comments, queries to:
Mr. Vilho Mtuleni, Environmental Assessment Practitioner
Email: eap.trigen@gmail.com - Cell: +264 81 232 6843



CALL FOR REGISTRATION AS INTERESTED AND AFFECTED PARTIES

ENVIRONMENTAL ASSESSMENT FOR THE PROPOSED EXPLORATION ACTIVITIES IN RESPECT TO BASE AND RARE METALS, AND PRECIOUS METALS ON EPL 7413 SITUATED IN ORUPEMBE CONSERVANCY, KUNENE REGION

1. PROJECT SITE AND DESCRIPTION

Unanisa Hei Investment cc, intends to apply in order to obtain an Environmental Clearance Certificate for its proposed Base and Rare Metals, and Precious Metals prospecting activities on EPL 7413. The key component of the proposed activity entails geological mapping and survey and manual sample collection for laboratory analysis. Access to the sampling or survey sites will be by existing tracks and on foot where vehicle access is limited.

2. PUBLIC PARTICIPATION PROCESS

Enviro-Leap Consulting invites all Interested and Affected Party (I & AP) to register and receive Environmental Assessment (BID, Scoping and EMP) documents relating to the proposed project for their comments and input.

Enviro-Leap Consulting invites all Interested and Affected Party (I & AP) to register and receive Environmental Assessment (BID, Scoping and EMP) documents relating to the proposed project for their comments and input.

3. COMMENTS AND QUERIES

Interested and Affected Parties are herewith request to register by writing to us at the address below no later than **30 JULY 2020**.

3. COMMENTS AND QUERIES

Please register and direct all comments, queries to:
Mr. Vilho Mtuleni, Environmental Assessment Practitioner
Email: eap.trigen@gmail.com - Cell: +264 81 232 6843

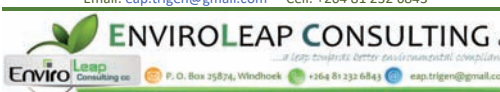

PUBLIC NOTICE

Please take note that KAMAU TOWN PLANNING AND DEVELOPMENT SPECIALIST has been appointed by the owner of Erf 3170 (a portion of consolidated Erf 3150) Windhoek, to apply to the local authority of Windhoek for the rezoning of the respective Erf from 'Residential' with a density of 1:900sqm to 'Business' with a bulk of 1:0and subsequently consent to use the respective Erf for a guesthouse purposes and consent to use the respective Erf as "Business" while the rezoning is in progress, as per terms of the Windhoek Town Planning Scheme.

Erf 3170 (a portion of consolidated Erf 3150) Windhoek, is located within the Windhoek West suburb in Windhoek, Salk Street. Considering its use and services offered, the subject property is ideally located central of the city with ease of access to other suburbs and one of prime and sought-after area of Windhoek. The Erf lies on a slope towards the back of the property. The respective Erf measures 1006m2 in extent and is currently built up according to the respective zoning. The respective Erf is currently zoned "Residential" with a density of 1:900m2 as per the Windhoek Town Planning Scheme.



Please further take note that -

- (a) the plan of the Erf or land lies for inspection at of the offices of the local authority (City of Windhoek);
- (b) any person having objections to the rezoning concerned or who wants to comment, may in writing lodge such objections and comments, together with the grounds, with the Chief Executive Officer Local Authority of Walvis Bay, and with the applicant within 14 days of the last publication of this notice, i.e. no later than **22 July 2021**.

FOR MORE INFORMATION AND QUERIES, KINDLY CONTACT:



No. 04 Wagner street | Windhoek west |
c: +264 81 3290584
P.O. Box 22296 | Windhoek | t: +264 61251975 |
f: +264 61 304219 |
yeli@kamau-tpds.com w: www.kamau-architects.com

PUBLIC NOTICE

Please take note that KAMAU TOWN PLANNING AND DEVELOPMENT SPECIALIST has been appointed by the owner of Erf 676 Theodor Gawaseb Street, Extension 1, Grootfontein, to apply to the local authority of Grootfontein for the rezoning of the respective Erf from 'Residential' with a density of 1:300sqm to 'General Residential' with a density of 1:100sqm and Consent to commence with construction while rezoning is in progress.

Erf 676 is located in Theodor Gawaseb Street, Extension 1 of Grootfontein and measures an extent of 473m2. The residential suburb where this Erf is found has the majority of activities taking place in terms of land use as 'Residential' and 'General Residential' (as per Grootfontein Zoning Map). Furthermore, as indicated on the respective zoning map, there is a suburb business center. Additional land use activities include the Makalani Primary School (educational), Hakahana Enterprises (business) which are located 5 blocks away from the respective Erf.

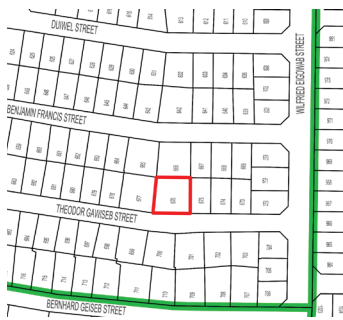

Please further take note that -

- (a) the plan of the Erf or land lies for inspection at the Grootfontein Town Councils public notice board;
- (b) any person having objections to the rezoning concerned or who wants to comment, may in writing lodge such objections and comments, together with the grounds, with the Chief Executive Officer Local Authority of Grootfontein, and with the applicant within 14 days of the last publication of this notice, i.e. no later than **22 July 2021**.

FOR MORE INFORMATION AND QUERIES, KINDLY CONTACT:



No. 04 Wagner street | Windhoek west |
c: +264 81 3290584
P.O. Box 22296 | Windhoek | t: +264 61251975 |
f: +264 61 304219 |
yeli@kamau-tpds.com w: www.kamau-architects.com

LOOKING FOR AN AGENT?

My name is Palmira Hamutenya and I want to help you sell your home.

If you are looking to sell a property in and around

Otjomuise & Katutura

TALK TO ME TODAY
PALMIRA
+264 81 295 5329
palmira@bvlproperty.com.na

WITH OUR TEAM YOU ARE IN GOOD HANDS

Ongudi INVESTMENTS

Fish Shops
Powered by Ongudi

Locations:

- HAVANA (Windhoek) 081 468 8716
- OMBILI (Windhoek) 081 468 8716
- GOREANGAB OKAPALE (Windhoek) 081 468 8716
- OLD POWER STATION (Windhoek) 081 242 6194
- GOREANGAB WOERMANNBROK (Whk) 081 499 2704
- TAUBEN GLEN (Windhoek) 081 242 6194
- AMAGOESA (Okahandja) 081 244 2654

A variety of fish available



NOTICE FOR PUBLIC PARTICIPATION ENVIRONMENTAL IMPACT ASSESSMENT

Environam Consultants Trading cc (ECT) hereby gives notice to all potentially Interested and Affected Parties (I&APs) that an application will be made to the Environmental Commissioner in terms of the Environmental Management Act (No 7 of 2007) and the Environmental Impact Assessment Regulations (GN 30 of 6 February 2012) for the following:

PROJECT NAME:

Township Establishment on a Portion of Portion 143 of Gobabis Town and Townlands No. 114, Nossobville, Gobabis

PROJECT LOCATION: Nossobville, Gobabis, Omaheke Region

PROJECT DESCRIPTION:

The proposed township will consist of approximately 270 erven, comprising Residential, General Residential, Local Business, Institutional, Public Open Space and Street land uses.

PROPONENT:

Star Merchandising CC

ENVIRONMENTAL ASSESSMENT PRACTITIONER (EAP): Environam Consultants Trading cc (ECT)
REGISTRATION OF I&APs AND SUBMISSION OF COMMENTS: In line with Namibia's Environmental Management Act (No. 7 of 2007) and EIA regulations (GN 30 of 6 February 2012), all I&APs are hereby invited to register and submit their comments, concerns or questions in writing, Kindly contact:

Colin P Namene

Email: colin@environam.com

Fax: 061 258 470 or

Mobile: 0814 584 297 on or before **09 July 2021**.

Due to the Covid-19 situation a public meeting will not be held. Interested and affected parties are advised to provide input and comments via the contact details mentioned above.

CALL FOR REGISTRATION AS INTERESTED AND AFFECTED PARTIES

ENVIRONMENTAL ASSESSMENT FOR THE CONSTRUCTION AND OPERATION OF A CROCODILE FARM AND PARK ON A PORTION OF THE REMAINDER OF FARM USAKOS AND TOWNLANDS NO. 93 SOUTHWEST OF THE KHAN RIVER, ERONGO REGION

1. PROJECT SITE AND DESCRIPTION

Reptilia Crocodile Farm and Park cc, intends to apply in order to obtain an Environmental Clearance Certificate for its proposed construction and operation of a Crocodile Farm on ERF on a 3 Ha land area. The key component of the proposed activity includes the construction of the farm, and operation of the facility including crocodile husbandry, lodging and tours.

2. PUBLIC PARTICIPATION PROCESS

Enviro-Leap Consulting invites all Interested and Affected Party (I & AP) to register and receive Environmental Assessment (EIA, Scoping and EMP) documents relating to the proposed project for their comments and input.

Enviro-Leap Consulting invites all Interested and Affected Party (I & AP) to register and receive Environmental Assessment (EIA, Scoping and EMP) documents relating to the proposed project for their comments and input.

3. COMMENTS AND QUERIES

Interested and Affected Parties are herewith request to register by writing to us at the address below no later than **30 JULY 2020**.

3. COMMENTS AND QUERIES

Please register and direct all comments, queries to:
Mr. Vilho Mtuleni, Environmental Assessment Practitioner
Email: eap.trigen@gmail.com - Cell: +264 81 232 6843



CALL FOR REGISTRATION AS INTERESTED AND AFFECTED PARTIES

ENVIRONMENTAL ASSESSMENT FOR THE PROPOSED EXPLORATION ACTIVITIES IN RESPECT TO BASE AND RARE METALS, AND PRECIOUS METALS ON EPL 7413 SITUATED IN ORUPEMBE CONSERVANCY, KUNENE REGION

1. PROJECT SITE AND DESCRIPTION

Unanisa Hei Investment cc, intends to apply in order to obtain an Environmental Clearance Certificate for its proposed Base and Rare Metals, and Precious Metals prospecting activities on EPL 7413. The key component of the proposed activity entails geological mapping and survey and manual sample collection for laboratory analysis. Access to the sampling or survey sites will be by existing tracks and on foot where vehicle access is limited.

2. PUBLIC PARTICIPATION PROCESS

Enviro-Leap Consulting invites all Interested and Affected Party (I & AP) to register and receive Environmental Assessment (EIA, Scoping and EMP) documents relating to the proposed project for their comments and input.

Enviro-Leap Consulting invites all Interested and Affected Party (I & AP) to register and receive Environmental Assessment (EIA, Scoping and EMP) documents relating to the proposed project for their comments and input.

3. COMMENTS AND QUERIES

Interested and Affected Parties are herewith request to register by writing to us at the address below no later than **30 JULY 2020**.

3. COMMENTS AND QUERIES

Please register and direct all comments, queries to:
Mr. Vilho Mtuleni, Environmental Assessment Practitioner
Email: eap.trigen@gmail.com - Cell: +264 81 232 6843



ENVIRONMENTAL IMPACT ASSESSMENT (EIA)

INVITATION TO COMMENT / PARTICIPATION

The following Namibian company (Erongo Marble and Granite Pty Ltd - EPL 5625) and Namibian citizens has applied for Mining Claims and exploration of Dimension stone in Karibib district - Namibia

- 1: Sidney S Cloethe (Mining Claim: 68364-68365)
- 2: Fanuel .Kharuxab (Mining Claims: 68366,68367,68368,68369,68370,68371)
- 3: Erongo Marble and Granite Pty Ltd (EPL 5625)

CENTRE FOR GEOSCIENCES RESEARCH cc has been appointed to undertake an Environmental Impact Assessment (EIA) in accordance with the Namibian Environmental Management Act (2007) and it Regulations (2012).

Sidney Cloethe & Fanuel .Kharuxab are proposing to quarry the marble in the above listed mining claims respectively as described above, within the vicinity of Karibib in Erongo region. And that Erongo Marble and Granite Pty Ltd (EPL 5626) is proposing to undertake exploration of dimension stone within the same vicinity as the claims above in Karibib area.

Hence, a joint advertisement calling for the Interested and affected parties are encouraged to register via email in order to receive the Background Information Document (BID) to the email below within a period of seven days from the date of advert to the email below. Due the current COVID-19 pandemic the public is encouraged to consult via email. Unless other wise no physical public meeting is necessary.

All comments and concerns should be submitted to CENTRE FOR GEOSCIENCES RESEARCH.

Please contact:

Mulife Siyambango

CENTRE FOR GEOSCIENCES RESEARCH cc

P.O. Box 31423 Pioneerspark

Windhoek, Namibia, 128A Bach Street

Tel: 061-307157/ Cell: 0856419511

Email: cegeomam@gmail.com



For all Northern advertising do not hesitate to contact our Sales Executive

Mandy Mumba

CELL:
+264 81 895 8296

EMAIL:
mandy@confidentenamibia.com



Leroy Sane

Loew faces calls to drop Leroy Sane for England clash

Germany head coach Joachim Loew is under pressure to shake up his starting side for Tuesday's blockbuster Euro 2020 last 16 clash against England at Wembley and drop under-performing winger Leroy Sane.

As a replacement for Thomas Mueller, who was sidelined by a knee injury, Sane struggled on his first start of the tournament in the 2-2 draw against Hungary, with Germany needing a late equaliser to reach the knockout stages.

Sane made little impact up front, reflecting an inconsistent first season for Bayern Munich where the flashes of brilliance were all too few and far between.

When Sane failed to convert a chance from a corner against Hungary, whistles echoed around Munich's Allianz Arena on Wednesday.

Former Germany midfielder Stefan Effenberg says Loew must react by dropping the 25-year-old for the

England showdown.

"Loew shouldn't start Sane, he is not doing the team any favours, but neither is Sane himself," Effenberg told t-online.

"He (Sane) lacks self-confidence - and that means that he can't use his fantastic abilities."

Both Effenberg and Germany legend Lothar Matthaeus urge Loew to reconsider his midfield options and turn to players from Bundesliga powerhouse Bayern Munich.

"Jogi (Loew) trusts the wrong players. Above all, it was the Bayern players who pushed us through," said Matthaeus.

Leon Goretzka, who came off the bench to score the crucial late goal against Hungary, is expected to start at Wembley having shaken off a leg injury.

Effenberg also wants to see more of 18-year-old Bayern midfielder Jamal Musiala, a substitute against Hungary, who "created more danger in the last

eight minutes than Sane in the whole game".

Matthaeus wants the Bayern midfield to start en masse against England with Joshua Kimmich switched from right-back to central midfield.

"I don't just recommend Loew starts with Jamal Musiala, I recommend the whole Bayern midfield start," said Matthaeus who captained West Germany to the World Cup title in 1990.

"Joshua Kimmich plays the ball deep, Leon Goretzka makes runs into the penalty area and Thomas Mueller organises the team - for me, that midfield has the quality to set the tone against any team," explained Matthaeus.

To make way for Goretzka and Kimmich, Matthaeus suggested Loew drop two regulars in midfield.

"Nothing against Ilkay Gundogan and Toni Kroos, but with them, some things are missing that are urgently needed," he added.

Zambia surprise with Mweene recall for Cosafa Cup

Zambia coach Milutin 'Micho' Sredojevic has recalled veteran goalkeeper Kennedy Mweene after naming a 30-man provisional squad for the 2021 COSAFA Cup that will be staged in Nelson Mandela Bay from July 6-18.

Mweene's recall is something of a surprise given that he has not played international football for three years, though he never retired and has previously stated he was open to a return to the national team.

The 36-year-old is one of four goalkeepers in the squad alongside Polokwane City gloveman Cyril Chibwe, and Gregory Sanjase (Young Green Eagles) and Lameck Siame (Kabwe Warriors).

Sredojevic has not called any of his players from Europe, but there is a strong contingent of South African-based stars to choose from, including in-form forward Augustine Mulenga (AmaZulu), strikers Justin Shonga (Cape Town City) and Gamphani Lungu (SuperSport United), and midfielder Salulani Phiri (Polokwane City).

Zambia are the defending champions from the last competition held in 2019, and begin their Group B campaign this year against Comoros Islands on July 7.

They face Madagascar three days later, before a final pool game against Malawi on June 13. Only the top team in each of the three pools and the best runner-up advance to the semifinals.

Sredojevic has previously said he wants to use the competition as a build-up to the 2022 Fifa World Cup group stage qualifiers that start in September.

SQUAD:

Goalkeepers: Kennedy Mweene (Mamelodi Sundowns, South Africa), Gregory Sanjase (Young Green Eagles), Cyril Chibwe (Polokwane City, South Africa), Lameck Siame (Kabwe Warriors)

Defenders: Isaac Shamujompa, Roderick Kembo (both Buildcon),



Kennedy Mweene

Simon Silwimba, Adrian Chama (both Zesco United), Dominic Chanda (Kabwe Warriors), Kabaso Chongo (TP Mazembe, DR Congo), Prosper Chiluya, Benedict Chepeshi (both Red Arrows), Zachariah Cholongoshi (Power Dynamos)

Midfielders: Roderick Kabwe (Black Leopards, South Africa), Spencer Sautu, Benson Sakala (both Power Dynamos), Felix Bulaya, Paul Katema (both Red Arrows), Salulani Phiri (Polokwane City, South Africa), Collins Sikombe (Lusaka Dynamos), Prince Mumba (Kabwe Warriors), Augustine Mulenga (AmaZulu, South Africa), Kelvin Mubanga Kampamba (Zesco United), Jimmy Mukeya (NAPSA Stars)

Forwards: Moses Phiri, Rodger Kola (both Zanaco), Gamphani Lungu (SuperSport United, South Africa), Brian Mwila (Buildcon), Justin Shonga (Cape Town City, South Africa), Friday Samu (Green Buffaloes)



NOTICE FOR PUBLIC PARTICIPATION ENVIRONMENTAL IMPACT ASSESSMENT

Environam Consultants Trading cc (ECT) hereby gives notice to all potentially Interested and Affected Parties (I&APs) that an application will be made to the Environmental Commissioner in terms of the Environmental Management Act (No 7 of 2007) and the Environmental Impact Assessment Regulations (GN 30 of 6 February 2012) for the following:

PROJECT NAME: Township Establishment on a Portion of Portion 143 of Gobabis Town and Townlands No. 114, Nossobville, Gobabis

PROJECT LOCATION: Nossobville, Gobabis, Omaheke Region

PROJECT DESCRIPTION: The proposed township will consist of approximately 270 erven, comprising Residential, General Residential, Local Business, Institutional, Public Open Space and Street land uses.

PROPONENT: Star Merchandising CC

ENVIRONMENTAL ASSESSMENT PRACTITIONER (EAP): Environam Consultants Trading cc (ECT)

REGISTRATION OF I&APs AND SUBMISSION OF COMMENTS: In line with Namibia's Environmental Management Act (No. 7 of 2007) and EIA regulations (GN 30 of 6 February 2012), all I&APs are hereby invited to register and submit their comments, concerns or questions in writing. Kindly contact:

Colin P Namene
Email: colin@environam.com
Fax: 061 258 470 or
Mobile: 0814 584 297 on or before 09 July 2021.

Due to the Covid-19 situation a public meeting will not be held. Interested and affected parties are advised to provide input and comments via the contact details mentioned above.

JH TECHNICAL SERVICES CC

WINDHOEK \ OMUTHIYA

We sell & fix this:



Call us: 081 341 7253

E-mail: info@jhtechnical.com.na

Portugal talents stall to leave questions over style, approach

Fernando Santos framed Portugal's Euro 2020 exit as a tale of bad luck and missed chances but the failure to extract the best from a wealth of attacking talents was ultimately what cost his team dear.

Belgium were left hanging on to their 1-0 win in Seville, decided by Thorgan Hazard's swerving strike at the end of the first half which earns them a quarterfinal meeting with Italy in Munich on Friday.

They might have scored a second with more precision on the break and instead a slender advantage was always going to give way to a Portugal onslaught at the end of breathless tie in the last 16.

"I think it's an unfair result but they scored and we didn't," said Santos. "Their goal was a shot from nothing, from outside the box. We can't control everything."

But while the statistics would show Portugal had 24 shots, six of them on target, the flow of the match had Belgium as the more ambitious team until they had to defend and their opponents grew increasingly desperate.

Portugal started with just over 200 million euros (\$238 million) worth of talent in their front three, with Cristiano Ronaldo flanked by Liverpool's Diogo Jota and Bernardo Silva of Manchester City.

When the game was getting away from them, another trio worth another 200 million euros entered, Bruno Fernandes, Joao Felix and Andre Silva coming on for Jota, Bernardo Silva and



Fernando Santos

Joao Moutinho.

France's Kylian Mbappe, Karim Benzema and Antoine Griezmann might be the sharpest starting trident but even the world champions cannot match Portugal's depth of attacking options.

And yet there was a lack of fluidity about them at La Cartuja as players that sparkle for their clubs looked weighed down by a need to put defensive shape and organisation first.

There are mitigating circumstances, with Fernandes clearly fatigued in this tournament as his appearances for the season ticked past 70 in the group stage.

'NO ISSUE WITH RONALDO'

Felix has been drifting for months and needs rejuvenating after watching most of Atletico Madrid's LaLiga success from the sidelines before being dropped by Portugal too.

And they were up against an experienced Belgian back line, whose best days might be behind them but who still delivered a throwback demonstration of organised, committed defence under pressure.

Facing Belgium, the team ranked No 1 in the world rankings for the last three years, after encountering Germany and France in their group, was about as tough a draw as could be imagined.

"Toby Alderweireld, Jan Vertonghen,

Thomas Vermaelen, they are the masters," said Roberto Martinez. "The talent they have makes defending an art." Yet there was reason to expect more from Portugal, who prioritised suppression for most of the first half, a tactic that proved successful in France five years ago but jarred when adopted by this current crop.

When the push came late on, it felt frantic rather than planned, players thrown on off the bench and balls lofted towards the area in hope more than expectation. At one point, Felix was playing right wing-back and Fernandes in defensive midfield.

If the plan was to service Ronaldo, it worked to some extent, after the 36-year-old scored five goals - his best ever Euro tally - but the sacrifices made by those around him come at a cost.

At the final whistle, Ronaldo hurled his captain's armband to the ground, Portugal's early exit now added to his disappointment with Juventus last season in both the Champions League and Serie A. "He scored five goals in the tournament and OK, he didn't score today but he was a true captain in every sense of the word," said Santos. "He tried to turn the game around. There is no issue with Ronaldo."

When Ronaldo eventually brings his immense international career to an end, a more progressive coach than Santos might compensate the loss by shifting the balance and approach.

For now, Portugal turn to next year's World Cup in Qatar, needing to find a way to illuminate not just Ronaldo but those coming up behind him.



Antonio Ruediger and Ilkay Gundogan returned for Germany's final training session on Monday

Gundogan, Ruediger back training before England tie

Antonio Ruediger and Ilkay Gundogan returned for Germany's final training session on Monday before their Euro 2020 last-16 clash against England, with coach Joachim Loew expected to make changes to his starting line-up.

Chelsea centre-back Ruediger had missed training on Sunday with a cold while Manchester City midfielder Gundogan was sidelined with a head knock. Both recovered to take part at their Euro 2020 base in Bavaria before the flight to London for Tuesday's fixture with England at Wembley.

Thomas Mueller is tipped to replace Leroy Sane, having shaken off a knee injury. His Bayern Munich teammate Leon Goretzka, who scored the crucial equaliser against Hungary in Germany's final group-stage match, is expected to take over from Gundogan in midfield.

Left-back Robin Gosens described

the 31-year-old Mueller as "worth his weight in gold" and said that "he lifts us up a level".

Mueller scored twice against England in the Germans' 4-1 last-16 win at the 2010 World Cup - the last meeting of the countries at a major tournament.

"I want to confirm this threat that the English might feel when a Mueller is on the pitch," Mueller joked on Saturday.

"(But) it won't do me any good to

tell my opponents about 2010 out on the pitch."

On Saturday, the German FA claimed Joachim Loew's squad were blocked from holding their final training session at Wembley.

In a statement, a Uefa spokesman said any training would have been "restricted to certain areas of the pitch" to help the turf recover after four Euro 2020 games, but added that "Germany, however, did not ask to train in the stadium".

JH TECHNICAL SERVICES CC

WINDHOEK \ OMUTHIYA

We sell & fix this:



Call us: 081 341 7253

E-mail: info@jhtechnical.com.na



NOTICE FOR PUBLIC PARTICIPATION ENVIRONMENTAL IMPACT ASSESSMENT

Environam Consultants Trading cc (ECT) hereby gives notice to all potentially Interested and Affected Parties (I&APs) that an application will be made to the Environmental Commissioner in terms of the Environmental Management Act (No. 7 of 2007) and the Environmental Impact Assessment Regulations (GN 30 of 6 February 2012) for the following:

PROJECT NAME: Township Establishment on a Portion of Portion 143 of Gobabis Town and Townlands No. 114, Nossobville, Gobabis

PROJECT LOCATION: Nossobville, Gobabis, Omaheke Region

PROJECT DESCRIPTION: The proposed township will consist of approximately 270 erven, comprising Residential, General Residential, Local Business, Institutional, Public Open Space and Street land uses.

PROPONENT: Star Merchandising CC

ENVIRONMENTAL ASSESSMENT PRACTITIONER (EAP): Environam Consultants Trading cc (ECT)

REGISTRATION OF I&APs AND SUBMISSION OF COMMENTS: In line with Namibia's Environmental Management Act (No. 7 of 2007) and EIA regulations (GN 30 of 6 February 2012), all I&APs are hereby invited to register and submit their comments, concerns or questions in writing. Kindly contact:

Colin P Namene
Email: colin@environam.com
Fax: 061 258 470 or
Mobile: 0814 584 297 on or before 09 July 2021.

Due to the Covid-19 situation a public meeting will not be held. Interested and affected parties are advised to provide input and comments via the contact details mentioned above.