

Rupara Campsite

Leasehold Land Right, Sangwali Communal Area of Linyanti Constituency (Caprivi Region)

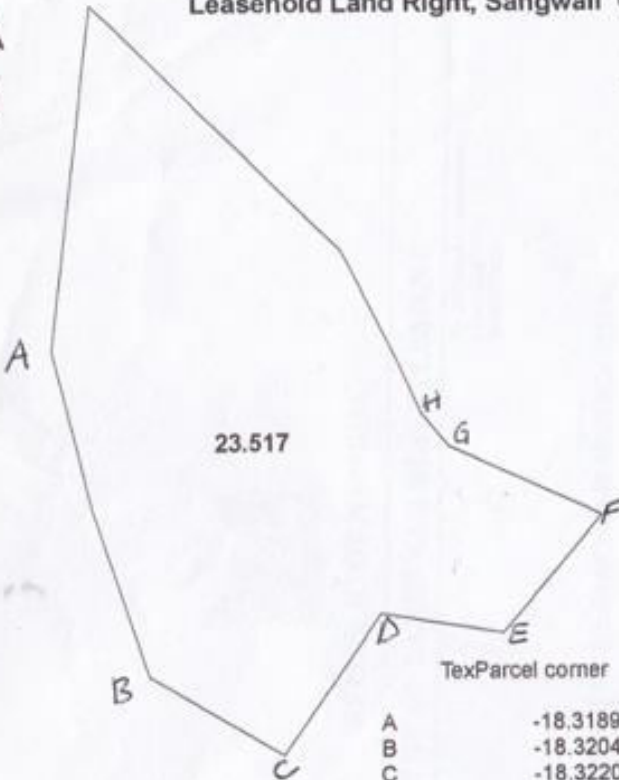

The figure below represents a Leasehold Land Right for Rupara Community Campsite for Tourism purposes in the Caprivi Communal Land Board comprising of 23.517 ha

The land parcel as described above is situated within Sangwali Communal Area of Linyanti Constituency, Caprivi Region

Map Producer
 Name: Gift Sinyepe
 Position: Development Planner
 Division: LBTA
 Ministry of Lands and Resettlement
 Katima Mulilo Regional Office

Date of Survey: 31 January 2011

TexParcel	corner	LAT	LONG	OWNER
A		-18.31891	23.65974	Rupara Com Campsite
B		-18.32046	23.66020	Rupara Com Campsite
C		-18.32208	23.66083	Rupara Com Campsite
D		-18.32281	23.66224	Rupara Com Campsite
E		-18.32139	23.66320	Rupara Com Campsite
F		-18.32154	23.66447	Rupara Com Campsite
G		-18.32035	23.66545	Rupara Com Campsite
H		-18.31972	23.66385	Rupara Com Campsite
I		-18.31939	23.66355	Rupara Com Campsite
J		-18.31881	23.66325	Rupara Com Campsite
K		-18.31784	23.66269	Rupara Com Campsite
L		-18.31550	23.66004	Rupara Com Campsite

Legend

land right plots

TexProjection: Transverse Mercator
 False Easting: 600000
 False Northing: 10000000
 Central Meridian: 17
 Scale Factor: 1
 Latitude of Origin: 0
 Linear Unit: Meter
 Datum: WGS 1984

