

The proposed township establishment of Katima Mulilo Extension 39 on Portion D of Katima Mulilo Townlands No. 1328, Zambezi Region

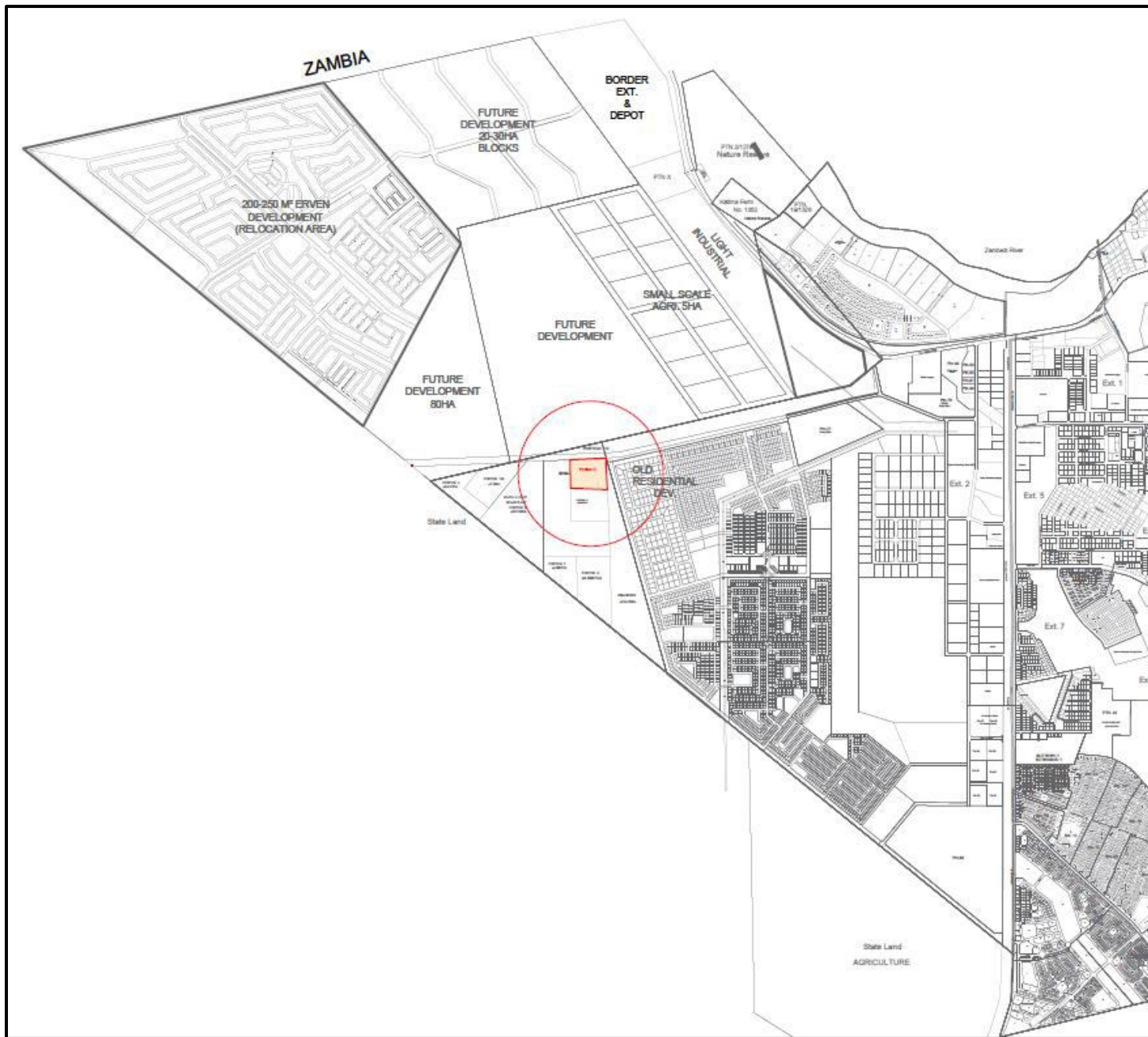

**Site Coordinates**  
*-17.503989" S, 24.525447" E*

APPROVED

No. A 53/92

1992-03-19 SURVEYOR-GENERAL

SIDES Metres	ANGLES OF DIRECTION " ' "	CO-ORDINATES System 22/25		DESIG.	
		y	x		
AB	579,27	Constant	+ 70 000,00	- 490 000,00	FB 476
BC	661,89	257 08 27	A + 11 496,99	- 7 525,60	AJ 3
CD	1 693,81	257 12 45	B + 10 932,25	- 7 654,52	Bn 1.o.l.
DA	2 150,00	344 16 30	C + 10 286,78	- 7 801,02	Bn 2
		129 04 02	D + 9 827,72	- 6 170,60	

DESCRIPTION OF BEACONS

A...Iron standard in concrete.  
 B...30 mm Iron pipe.  
 C,D...Iron standard.

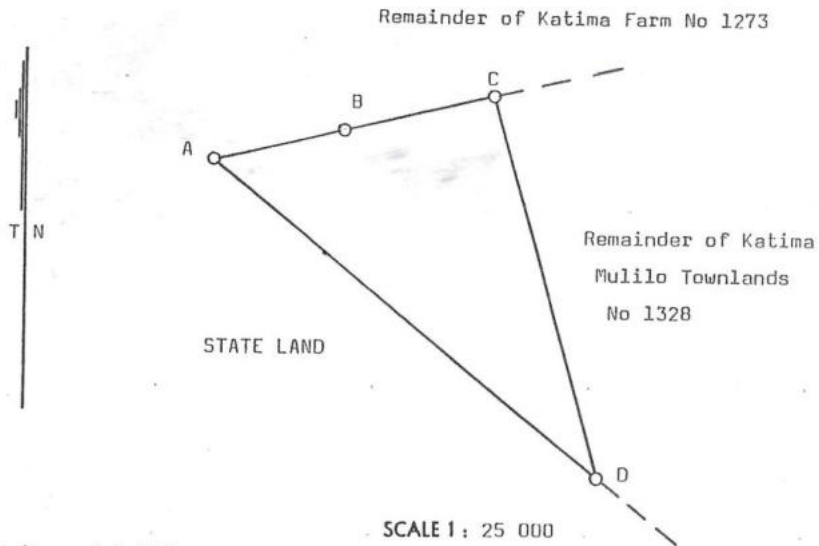

The figure A B C D

represents 105,0032 hectares

of land, being

PORTION 3 of the farm KATIMA MULILO TOWNLANDS No 1 328  
 situate in the Eastern Caprivi, Registration Division B, NAMIBIA

Surveyed in February 1992 by us

*[Signature]*  
*[Signature]*

Land Surveyor S

This diagram is annexed to No.  dated  Registrar of Deeds	The original diagram is No A 332/91 annexed to	S.R. No. E. 19/92
		Noting Plan File No. B 1328 Lat. 17° 31' S Long. 24° 15' E