

# **PROOF OF CONSULTATION**

1. PERSONAL HAND DELIVERY
2. NAMIBIAN
3. NAMIB TIMES
4. GOVERNMENT GAZETTE
5. ON SITE
6. MUNICIPAL NOTICE BOARD



**STEWART PLANNING**  
TOWN & REGIONAL PLANNERS

First Floor CLA Building  
84 Theo Ben Gurirab Street  
Walvis Bay

P.O. Box 2095  
Tel: (064) 280 770  
Email: [otto@sp.com.na](mailto:otto@sp.com.na)

**Reference: PTN188**

**31 July 2020**

Letter to the Owner/Occupier  
Erf 7 Narraville  
No. 142 Sam Nujoma Avenue  
Walvis Bay

Per hand delivery

**NOTICE: PERMANENT CLOSURE OF PORTION A OF ERF 5238 WALVIS BAY EXTENSION 14 (FLAMINGO PRIMARY STATION) AS PUBLIC OPEN SPACE**

Dear Sir or Madam,

Notice is hereby given to the owner/occupier that the Municipality of Walvis Bay intends to permanently close Portion A, a 360m<sup>2</sup> portion of Erf 5238 Walvis Bay Extension 14, as "Public Open Space" situated next to Sam Nujoma Avenue.

The proposed permanent closure is to enable Erongo RED to acquire the closed portion containing the Flamingo Primary Station in Narraville from the Municipality of Walvis Bay. The intention is to subdivide to create Portion A and to subsequently rezone it to "Utility Services" in terms of the Walvis Bay Town Planning Scheme.

For additional information, refer to the attached particulars notice.

Take note that any interested person who wishes to object to the permanent closure as indicated above may lodge such objection together with grounds thereof, with the Chief Executive Officer, Municipality of Walvis Bay and with the applicant, in writing, on or before **Friday, 21 August 2020**.

Yours sincerely,

Johann Otto  
Town & Regional Planner in Training  
**STEWART PLANNING**

<b>Council</b> Chief Executive Officer Municipality of Walvis Bay Civic Centre Private Bag 5017 Walvis Bay
---

<b>Applicant</b> Stewart Planning Town & Regional Planners P.O. Box 2095 Walvis Bay <a href="mailto:otto@sp.com.na">otto@sp.com.na</a> Tel: 064 280 773
--



# PERMANENT CLOSURE OF PORTION A OF ERF 5238 WALVIS BAY

PERMANENT CLOSURE OF PORTION A, A PORTION OF ERF 5238 WALVIS BAY EXTENSION 14, AS PUBLIC OPEN SPACE

Notice is hereby given in terms of Section 50(3)(a)(ii) and Section 50(3)(a)(iv) of the Local Authorities Act, 1992 (Act No. 23 of 1992), that the Municipality of Walvis Bay intends to permanently close Portion A, a 360m<sup>2</sup> portion of Erf 5238 Walvis Bay Extension 14, as a "Public Open Space" situated next to Sam Nujoma Avenue (opposite the Total Service Station), Narraville.

The proposed permanent closure is to enable Erongo RED to acquire the closed portion containing the Flamingo Primary Station in Narraville from the Municipality of Walvis Bay. The intention is to subdivide to create Portion A and to subsequently rezone it to "Utility Services" in terms of the Walvis Bay Town Planning Scheme.

Take note that any interested person who wishes to object to the permanent closure as indicated above may lodge such objection together with the grounds thereof, with the Chief Executive Officer, Municipality of Walvis Bay and with the applicant, in writing, on or before **Friday, 21 August 2020**.

Erongo RED has entered into a transfer agreement with the Municipal Council of Walvis Bay to acquire various electrical substation and switching station assets in Walvis Bay.

Portion A, containing the Flamingo Primary Station is switching station situated on land owned by the Council. The locality of Portion A is shown below. It is situated along Sam Nujoma Avenue, opposite the road from the Total Service Station in Narraville. It is a ±20 x ±18 metre site situated on land currently zoned "Public Open Space" in terms of the Walvis Bay Town Planning Scheme.

Before this switching station can be transferred, it is necessary to permanently close Portion A as "Public Open Space" and to subsequently subdivide to allow the switching station to be alienated separately from Erf 5238 Walvis Bay Extension 14. It is also the intention to rezone Portion A to "Utility Services" which has been considered a suitable zoning for a switching station.

The proposed permanent closure, subdivision, and rezoning will not affect the existing switching station. The Remainder of Erf 5238 Walvis Bay Extension 14 will continue to remain "Public Open Space".

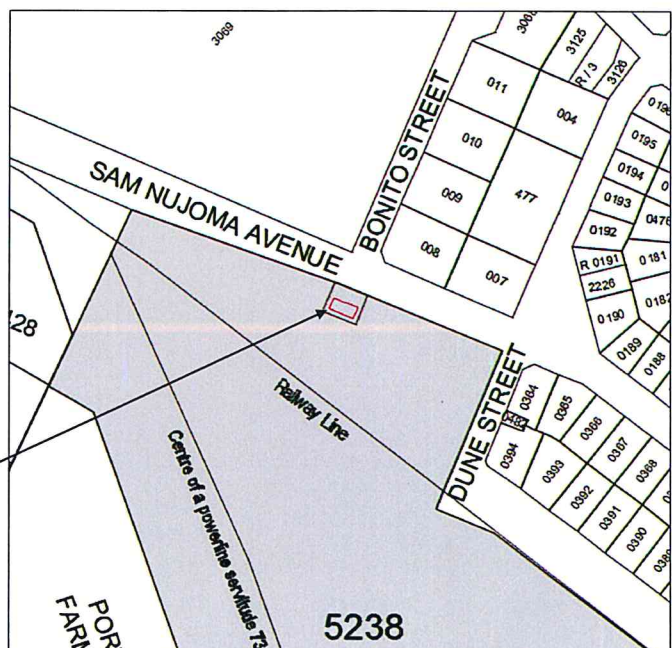
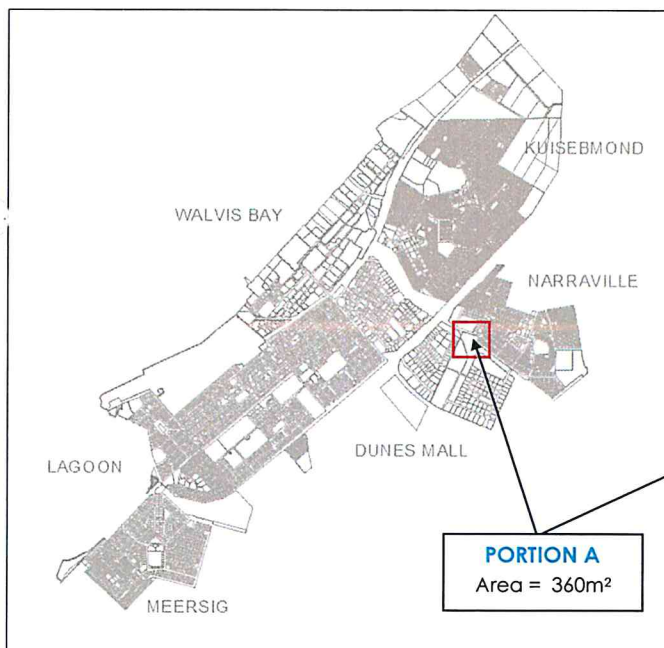

Chief Executive Officer  
Municipality of Walvis Bay  
Civic Centre  
Private Bag 5017  
Walvis Bay

Stewart Planning  
Town & Regional Planners  
P.O. Box 2095 Walvis Bay  
otto@sp.com.na  
Tel: 064 280 773



**STEWART PLANNING**  
TOWN & REGIONAL PLANNERS

31 July 2020

HAND DELIVERY RECEIPT: PLEASE SIGN BELOW TO CONFIRM RECEIPT OF THE ENVELOPE/LETTER FROM STEWART PLANNING DATED 31 JULY 2020 WITH THE FOLLOWING NOTICE:

PERMANENT CLOSURE OF PORTION A OF ERF 5238 WALVIS BAY EXTENSION 14 (FLAMINGO PRIMARY STATION) AS PUBLIC OPEN SPACE

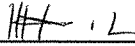
NO	RECIPIENT	NAME	SURNAME	SIGNATURE
1	Owner/Occupier NARRAVILLE MEAT Erf 7 Narraville SUPPLIES. No. 142 Sam Nujoma Avenue	Danci	Hartzenberg	
2	Owner/Occupier (Total Service Station) Erf 8 Narraville No. 140 Sam Nujoma Avenue	Leci	Kambwale	

**STEWART PLANNING**

P.O.Box 2095 Walvis Bay

Tel: (064) 280-770

Email: bruce@sp.com.na



# Coastal Office National Winners Announcement

Thank you to everyone who participated in our Covid-19 School Learner Competition. With the unexpected high volumes and standard of entries we have decided to increase the prizes.

HUGE Congratulations to our winners!!

**Primary School:**

- 1st Place - Justina Ndataha Ashivudhi (The Dolphin School)
- Middle School: 1st Place - Shay Labuschagne (Westside High)
- 2nd Place - Andrew Ross (Home School)

**Secondary School:**

- 1st Place: Melitha Hashiyana (Namib High School)
- 2nd Place: Jenna Lyn Meyer (Private School Swakopmund)

Be sure to like our page Coastal Office National to stay in the loop on all future competitions and promotions.



2. Shay Labuschagne



3. Justina Ndahafa Ashivudhi

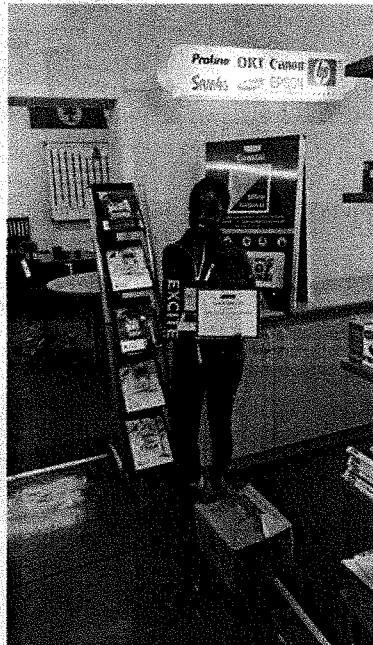

1. Melitha Hashiyana

**NAMWATER**  
 Namibia Water Corporation Ltd  
 NAMWATER SWAKOPMUND OFFICE  
 ACCESS RESTRICTION FOR PAYMENT  
 AND ENQUIRIES

NamWater takes the health and safety of its customers and employees as its first priority and has therefore taken the following measures in order to comply with the health and safety guidelines as provided for by the State of Emergency Covid-19 Regulations:

1. Access to NamWater Swakopmund office is hereby restricted to any visitor until further notice
2. Any enquiry should be made by telephone or e-mail
3. Payments should be made using the following methods: **Electronic Funds Transfer (EFT), Online Banking, NamPost, Shoprite/Checkers, Woermann Brock** and at any vending machine and kiosk found at petrol stations.

Technical queries should be directed to the following NamWater officials:

1. Erwin Shiluama  
 Cell: +264 81 122 1699  
 Email: [ShiluamaE@namwater.com.na](mailto:ShiluamaE@namwater.com.na)
2. Nico Ndemwiimba  
 Cell: +264 81 145 5267  
 Email: [NdemwiimbaN@namwater.com.na](mailto:NdemwiimbaN@namwater.com.na)

General company queries should be directed to:

Johannes Shigwedha  
 Cell: +264 81 122 2858  
 Email: [ShigwedhaJ@namwater.com.na](mailto:ShigwedhaJ@namwater.com.na)

The Water Utility urges its customers, stakeholders and all the Namibian people to comply with the health and safety guidelines as provided for by the State of Emergency Covid-19 Regulations.



**STEWART PLANNING**  
 TOWN & REGIONAL PLANNERS

**PERMANENT CLOSURE NOTICE**

**PERMANENT CLOSURE OF PORTION X (A PORTION OF THE REMAINDER OF CONSOLIDATED ERF 1597 WALVIS BAY EXTENSION 5), AND PORTION M OF JOHANNES NAMPALA AVENUE (A PORTION OF PORTION 72 OF WALVIS BAY TOWN AND TOWNLANDS NO.1), MEASURING ±281M² IN TOTAL, AS A STREET**

Notice is hereby given in terms of Section 50(3)(a)(ii) and Section 50(3)(a)(iv) of the Local Authorities Act, 1992 (Act No. 23 of 1992), that the Municipality of Walvis Bay intends to permanently close Portion X, a 50m² portion of the Remainder of Consolidated Erf 1597 Walvis Bay Extension 5, and Portion M, a 231m² portion of Portion 72 of Walvis Bay Town and Townlands No.1 (Johannes Nampala Avenue) as a "Street".

The proposed permanent street closure is to enable the adjacent owner to purchase a portion of Johannes Nampala Avenue from the Municipality of Walvis Bay. The adjacent owner intends to consolidate the street portions with a portion of Erf 2005 Walvis Bay Extension 5 to enlarge the property for "Industrial" purposes and to realign the cadastral boundary along the existing boundary wall.

Portion X and M together form a triangular land parcel which is part of the road reserve but is not used as a street. Traffic will continue to use Johannes Nampala Avenue without interference from the proposed permanent closure.

Take notice that the plan showing the locality and nature of the permanent street closure lies open for inspection during normal office hours on the Roads & Building Control notice board of the Municipality of Walvis Bay, Civic Centre, Walvis Bay.

Further take note that any interested person who wishes to object to the permanent closure as indicated above may lodge such objection together with the grounds thereof, with the Chief Executive Officer, Municipality of Walvis Bay and with the applicant, in writing, on or before **Friday, 21 August 2020**.

<b>Applicant:</b> Stewart Planning Town & Regional Planners PO Box 2095 Walvis Bay otto@sp.com.na Tel: 064 280 773	<b>Council:</b> The Chief Executive Officer Municipality of Walvis Bay Private Bag 5017 Civic Centre Walvis Bay
---	--



**STEWART PLANNING**  
 TOWN & REGIONAL PLANNERS

**PERMANENT CLOSURE NOTICE**

**PERMANENT CLOSURE OF PORTION A, A PORTION OF THE REMAINDER OF PORTION 188 OF WALVIS BAY TOWN AND TOWNLANDS NO.1, AS A STREET, AND PERMANENT CLOSURE OF PORTION A, A PORTION OF ERF 5238 WALVIS BAY EXTENSION 14, AS PUBLIC OPEN SPACE**

Notice is hereby given in terms of Section 50(3)(a)(ii) and Section 50(3)(a)(iv) of the Local Authorities Act, 1992 (Act No. 23 of 1992), that the Municipality of Walvis Bay intends to permanently two portions as follow:

- Portion A, a 120m² portion of the Remainder of Portion 188 of Walvis Bay Town and Townlands No.1 as a "Street" situated in Unity Street, Meersig Extension 1; and
- Portion A, a 360m² portion of Erf 5238 Walvis Bay Extension 14 as "Public Open Space" situated next to Sam Nujoma Avenue (opposite the Total Service Station), Narraville.

The proposed permanent closure is to enable Erongo RED to acquire the closed portions containing the Narra Substation in Meersig, and the Flamingo Primary Station in Narraville from the Municipality of Walvis Bay. The intention is to subdivide to create the respective portions and to subsequently rezone to "Utility Services" in terms of the Walvis Bay Town Planning Scheme.

Take notice that the plans showing the locality and nature of the permanent closure lie open for inspection during normal office hours on the Roads & Building Control notice board of the Municipality of Walvis Bay, Civic Centre, Walvis Bay.

Further take note that any interested person who wishes to object to the permanent closure as indicated above may lodge such objection together with the grounds thereof, with the Chief Executive Officer, Municipality of Walvis Bay and with the applicant, in writing, on or before **Friday, 21 August 2020**.

<b>Applicant:</b> Stewart Planning Town & Regional Planners PO Box 2095 Walvis Bay otto@sp.com.na Tel: 064 280 773	<b>Council:</b> The Chief Executive Officer Municipality of Walvis Bay Private Bag 5017 Civic Centre Walvis Bay
---	--

Portions X and M together form a triangular land parcel which is part of the road reserve but is not used as a street. Traffic will continue to use Johannes Nampala Avenue without interference from the proposed permanent closure.

Take notice that the plan showing the locality and nature of the permanent street closure lies open for inspection during normal office hours on the Roads & Building Control notice board of the Municipality of Walvis Bay, Civic Centre, Walvis Bay.

**PERMANENT CLOSURE OF PORTION X (A PORTION OF THE REMAINDER OF CONSOLIDATED ERF, 1597 WALVIS BAY EXTENSION 5), AND PORTION M OF JOHANNES NAMPALA AVENUE (A PORTION OF PORTION 72 OF WALVIS BAY TOWN AND TOWNLANDS NO. 1), MEASURING ±281M<sup>2</sup> IN TOTAL, AS A STREET**

Further take note that any interested person who wishes to object to the permanent closure as indicated above may lodge such objection together with the grounds thereof, with the Chief Executive Officer, Municipality of Walvis Bay and with the applicant, in writing, on or before **Friday, 21 August 2020**.

**Applicant: Stewart Planning  
Town & Regional Planners  
PO Box 2095 Walvis Bay  
otto@sp.com.na  
Tel: 064 280 773**

**The Chief Executive Officer  
Municipality of Walvis Bay  
Civic Centre  
Private Bag 5017  
Walvis Bay**

No. 304

2020

**PERMANENT CLOSURE OF PORTION A, A PORTION OF THE REMAINDER OF PORTION 188 OF WALVIS BAY TOWN AND TOWNLANDS NO. 1, AS A STREET, AND PERMANENT CLOSURE OF PORTION A, A PORTION OF ERF 5238, WALVIS BAY EXTENSION 14, AS PUBLIC OPEN SPACE**

Notice is hereby given in terms of Section 50(3)(a)(ii) and Section 50(3)(a)(iv) of the Local Authorities Act, 1992 (Act No. 23 of 1992), that the Municipality of Walvis Bay intends to permanently close two portions as follow:

- Portion A, a 120m<sup>2</sup> portion of the Remainder of Portion 188 of Walvis Bay Town and Townlands No. 1 as a “Street” situated in Unity Street, Meersig Extension 1; and
- Portion A, a 360m<sup>2</sup> portion of Erf 5238 Walvis Bay Extension 14 as “Public Open Space” situated next to Sam Nujoma Avenue (opposite the Total Service Station), Narraville.

The proposed permanent closure is to enable Erongo RED to acquire the closed portions containing the INarra Substation in Meersig, and the Flamingo Primary Station in Narraville from the Municipality of Walvis Bay. The intention is to subdivide to create the respective portions and to subsequently rezone to “Utility Services” in terms of the Walvis Bay Town Planning Scheme.

- Take notice that the plans showing the locality and nature of the permanent closure lie open for inspection during normal office hours on the Roads and Building Control notice board of the Municipality of Walvis Bay, Civic Centre, Walvis Bay.

**PERMANENT CLOSURE OF PORTION A, A 120M<sup>2</sup> PORTION OF THE REMAINDER OF PORTION 188 OF WALVIS BAY TOWN AND TOWNLANDS NO. 1, AS A STREET; AND PERMANENT CLOSURE OF PORTION A, A 360M<sup>2</sup> PORTION OF THE REMAINDER OF ERF 5238 WALVIS BAY EXTENSION 14, AS PUBLIC OPEN SPACE**

Further take note that any interested person who wishes to object to the permanent closure as indicated above may lodge such objection together with the grounds thereof, with the Chief Executive Officer, Municipality of Walvis Bay and with the applicant, in writing, on or before **Friday, 21 August 2020**.

**Applicant: Stewart Planning  
Town & Regional Planners  
PO Box 2095 Walvis Bay  
otto@sp.com.na  
Tel: 064 280 773**

**The Chief Executive Officer  
Municipality of Walvis Bay  
Civic Centre  
Private Bag 5017  
Walvis Bay**

No. 305

2020

PERMANENT CLOSURE OF THE REMAINDER OF ERF 87, LAFRENZ AS "PUBLIC OPEN SPACE" (THE REMAINDER OF ERF 87, LAFRENZ IS ±3834M<sup>2</sup> IN EXTENT) AND WILL BE REZONED TO GOVERNMENT

Notice is hereby given in terms of section 50(1)(a)(ii) of the Local Authorities Act, 1992 (Act No. 23 of 1992) that the City of Windhoek proposes to close permanently the under-mentioned portion as indicated on locality plan, which lies for inspection during office hours at the office of Urban Policy, Room 513, Municipal Offices, Independence Avenue.

PERMANENT CLOSURE OF THE REMAINDER OF ERF 87, LAFRENZ AS "PUBLIC OPEN SPACE" (THE REMAINDER OF ERF 87, LAFRENZ IS ±3834M<sup>2</sup> IN EXTENT) AND WILL BE REZONED TO GOVERNMENT

Objections to the proposed closing are to be served on the Secretary: Townships Board, Private Bag 13289, and the Chief Executive Officer, P O Box 59, Windhoek, within 14 days after the appearance of this notice in accordance with Section 50(1)(c) of the above Act.

**Issued by: Office of the Chief Executive Officer  
Corporate Communication, Marketing and Public Participation  
Tel: +264 61 290 2365/2044  
Email: communication@windhoekcc.org.na**

**Enquiries: Department of Urban and Transport Planning  
Strategic Executive: Pere Van Rensburg  
Tel: +264 61 290 3544  
Email: Mathilda.Moncho@windhoekcc.org.na**



Flamingo Primary Station

PERMANENT CLOSURE  
The following information is provided for your information:  
1. The station is closed to the public.  
2. The station is closed to the public.  
3. The station is closed to the public.  
4. The station is closed to the public.  
5. The station is closed to the public.  
6. The station is closed to the public.  
7. The station is closed to the public.  
8. The station is closed to the public.  
9. The station is closed to the public.  
10. The station is closed to the public.



# PERMANENT CLOSURE

## PERMANENT CLOSURE OF PORTION A, A PORTION OF THE REMAINDER OF PORTION 188 OF WALVIS BAY TOWN AND TOWNLANDS NO.1, AS A STREET, AND PERMANENT CLOSURE OF PORTION A, A PORTION OF ERF 5238 WALVIS BAY EXTENSION 14, AS PUBLIC OPEN SPACE

Notice is hereby given in terms of Section 50(3)(a)(ii) and Section 50(3)(a)(iv) of the Local Authorities Act, 1992 (Act No. 23 of 1992), that the Municipality of Walvis Bay intends to permanently close two portions as follow:

- Portion A, a 120m<sup>2</sup> portion of the Remainder of Portion 188 of Walvis Bay Town and Townlands No.1 as a “Street” situated in Unity Street, Meersig Extension 1; and
- Portion A, a 360m<sup>2</sup> portion of Erf 5238 Walvis Bay Extension 14 as “Public Open Space” situated next to Sam Nujoma Avenue (opposite the Total Service Station), Narraville.

The proposed permanent closure is to enable Erongo RED to acquire the closed portions containing the !Narra Substation in Meersig, and the Flamingo Primary Station in Narraville from the Municipality of Walvis Bay. The intention is to subdivide to create the respective portions and to subsequently rezone to “Utility Services” in terms of the Walvis Bay Town Planning Scheme.

Take notice that the plans showing the locality and nature of the permanent closure lie open for inspection during normal office hours on the Roads & Building Control notice board of the Municipality of Walvis Bay, Civic Centre, Walvis Bay.

Further take note that any interested person who wishes to object to the permanent closure as indicated above may lodge such objection together with the grounds thereof, with the Chief Executive Officer, Municipality of Walvis Bay and with the applicant, in writing, on or before **Friday, 21 August 2020**.

**Applicant: Stewart Planning  
Town & Regional Planners  
PO Box 2095 Walvis Bay  
otto@sp.com.na  
Tel: 064 280 773**

**The Chief Executive Officer  
Municipality of Walvis Bay  
Civic Centre  
Private Bag 5017  
Walvis Bay**