

Test- (Test-1785)

Test Areas (Exploration)

Application (Pre-Application)

General

Jurisdiction: Namibia
Official Area: 17.9024 Ha

Coordinates

17.9024 Ha

Official Area:

GCS Bessel 1841

Coordinate system:

Longitude

Part 1

	Latitude	Longitude
1	24° 18' 13.12" S	016° 51' 17.69" E
2	24° 18' 09.10" S	016° 51' 40.34" E
3	24° 18' 18.03" S	016° 51' 41.93" E
4	24° 18' 21.97" S	016° 51' 19.83" E

License Shape

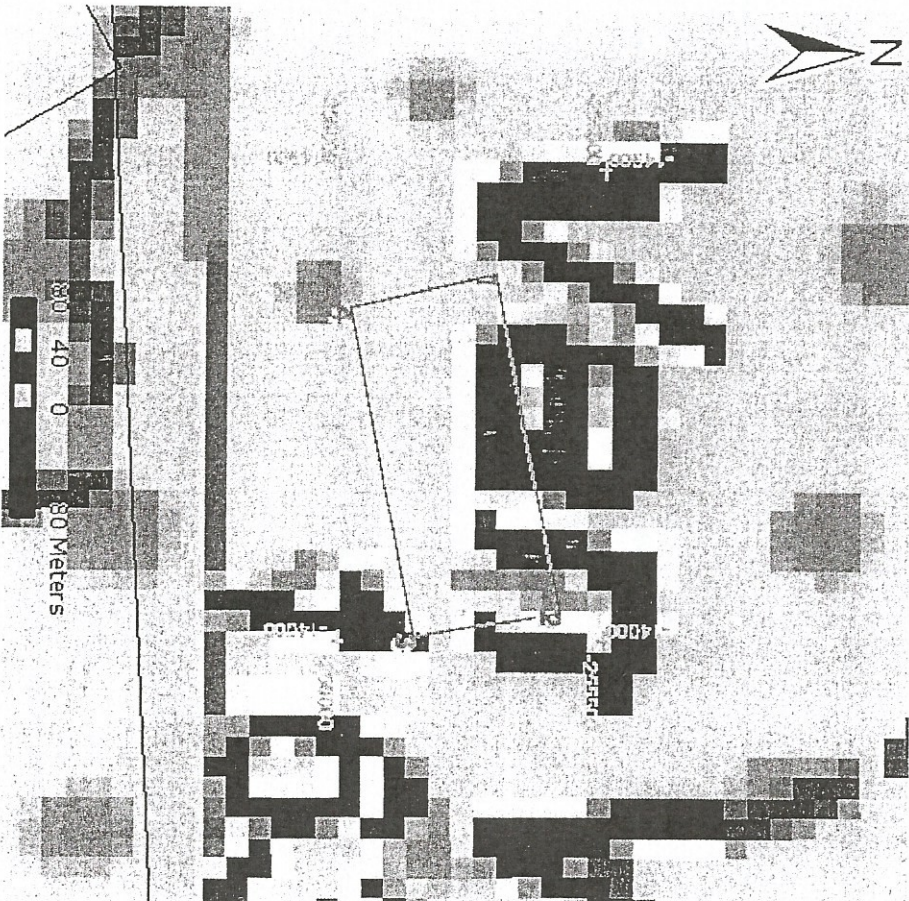

BA

License > Details

70538

License Type: Mining Claim
Status: Application

Application Date: 18/01/2018 00:00:00
Grant Date:
Expiry Date:

License Parties: Romeo Nel
Official Area: 17,9815 Ha
Last Renewal Date:

- General
- Parties (1)
- Conditions
- Shape (1)
- Map References (5)
- Documents
- Reference Codes (2)
- Commodities**
- Agreements
- Groups (1)
- Related Licenses
- Actions Open (1)
- Actions Closed (5)
- Roles (4)
- Discussions

There are 3 Commodities in the list

All	Name	Code	Group
<input type="checkbox"/>	Dimension Stone (applied for)	DS (applied for)	
<input type="checkbox"/>	Industrial Minerals	IM	
<input type="checkbox"/>	Semi-Precious Stones	SPS	

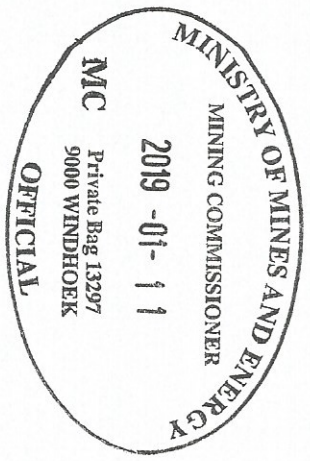

License > Details

70539

License Type: Mining Claim
Status: Application

Application Date: 18/01/2018 00:00:00
Grant Date:
Expiry Date:

License Parties: Romeo Nel
Official Area: 15,4245 Ha
Last Renewal Date:

- General
- Parties (1)
- Conditions
- Shape (1)
- Map References (5)
- Documents
- Reference Codes (2)
- Commodities**
- Agreements
- Groups (1)
- Related Licenses
- Actions Open (1)
- Actions Closed (6)
- Roles (4)
- Discussions
- Audit

There are 3 Commodities in the list

All	Name	Code	Group
<input type="checkbox"/>	Dimension Stone (applied for)	DS (applied for)	
<input type="checkbox"/>	Industrial Minerals (applied for)	IM (applied for)	
<input type="checkbox"/>	Semi-Precious Stones	SPS	

