

ANNEXURE 1
FORMS

Form 1

REPUBLIC OF NAMIBIA
ENVIRONMENTAL MANAGEMENT ACT, 2007

(Section 32)

APPLICATION FOR ENVIRONMENTAL CLEARANCE CERTIFICATE



PART A: DETAILS OF APPLICANT

1. Name: (person or business)	ALBERT ALBERTUS DIERGAARDT
2. Business Registration / Identity No. (if applicable)	63101001854
3. Correspondence Address:	P.O. BOX 3467, REHOBOTH
4. Name of Contact Person:	ALBERT ALBERTUS DIERGAARDT
5. Position of Contact Person:	OWNER
6. Telephone No.:	081 238 4643
7. Fax No.:	N/A.
8. E-mail Address : (if any)	albertdiergaardt72@gmail.com.

 Tick () the appropriate box

PART B: SCOPE OF THE ENVIRONMENTAL CLEARANCE CERTIFICATE

1. The environmental clearance certificate is for:

2. Details of the activity(s) covered by the environmental clearance certificate:

[Note: Please attach plans to show the location and scope of the designated activity(s), and use additional sheets if necessary:

Title of Activity: MINING

Nature of Activity: MINING CLAIM NO. 72004 - 72008

Location of Activity: ROSH PINAH, KARAS REGION

Scale and Scope of Activity: EXPLORATION

PART C: DECLARATION BY APPLICANT

I hereby certify that the particulars given above are correct and true to the best of my knowledge and belief. I understand the environmental clearance certificate may be suspended, amended or cancelled if any information given above is false, misleading, wrong or incomplete.

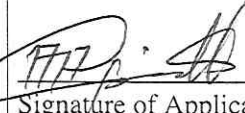
 Signature of Applicant

HIBEU ALBERTUS AIERGARDI
 Full Name in Block Letters

OWNER
 Position

on behalf of ENON MINING 6TH JUNE 2023
 Date



**REPUBLIC OF NAMIBIA
MINISTRY OF ENVIRONMENT, FORESTRY AND TOURISM**

OFFICE OF THE ENVIRONMENTAL COMMISSIONER

ENVIRONMENTAL CLEARANCE CERTIFICATE

ISSUED

In accordance with Section 37(2) of the Environmental
Management Act (Act No. 7 of 2007)

11 JUL 2022

TO

Albert Albertus Diergaardt
P. O. BOX 3467, Rehoboth

TO UNDERTAKE THE FOLLOWING LISTED ACTIVITY

**Mining Activities on Mining Claim No. 72004-72008 at Rosh Pina , Karas
Region**

Issued on the date: 2020-09-08
Expires on this date: 2023-09-08

(See conditions printed over leaf)





REPUBLIC OF NAMIBIA

MINISTRY OF MINES AND ENERGY
Office of the Mining Commissioner

Tel: +264 61 294 5000
Fax: +264 61 294 9000
E-mail: office@mining.gov.na
Website: www.mining.gov.na

Location: Windhoek
Boreas Road 11, 1100
Windhoek

CERTIFICATE OF REGISTRATION OF MINING CLAIMS
Registered in terms of Section 38 of the Minerals (Prospecting and Mining) Act, No. 33 of 1992 ("the Act")

PARTICULARS OF MINING CLAIM HOLDER

Reference Number	14/27/17/5168
Registered To	Albert Albertus Biergaardt
Address	Erf 835, Block C, Rehoboth
Postal Address	PO Box 3467, Rehoboth
Cell Phone	264812364443

PARTICULARS OF MINING CLAIMS

Ordinal No.	Date Pegged	Registered No.	Group of Minerals
1	01 July 2020	72004	Semi Precious Stones
2	01 July 2020	72005	Semi Precious Stones
3	01 July 2020	72006	Semi Precious Stones
4	01 July 2020	72007	Semi Precious Stones
5	01 July 2020	72008	Semi Precious Stones

VALIDITY OF MINING CLAIMS

Date of Renewal	Date of Expiry
05 August 2021	04 August 2024

SECTION 38 OF THE ACT: AN APPLICATION FOR THE RENEWAL REGISTRATION OF A MINING CLAIM SHALL BE MADE NOT LATER THAN 90 DAYS BEFORE THE DATE OF EXPIRY.

PARTICULARS OF LOCATION OF MINING CLAIMS

Name of Location	Owned By	District	Region
State Land	Government of the Republic of Namibia	Ukarus	Karas

Registered and issued at Windhoek on this 05th day of August 2021



MR EL SHIVOLO
MINING COMMISSIONER

05 AUG 2021
Official Date Stamp

ALBERT DIERGAARD PROJECT LATITUDE AND LONGITUDINAL COORDINATES

LATITUDE	LONGITUDE	NAME	DESCRIPTION	ICON
E 28° 05' 21" S 28° 05' 16" S 28° 05' 31" S 28° 05' 36" S	17° 10' 25" E 20	1	CORNER BEACON	208
	17° 10' 34" E 19	2	CORNER BEACON	208
	17° 10' 47" E 18	3	CORNER BEACON	208
	17° 10' 38" E 17	4	CORNER BEACON	208
D 28° 05' 40" S 28° 05' 47" S 28° 05' 58" S ✓ 28° 05' 50" S	17° 09' 42" E 16	5	CORNER BEACON	208
	17° 09' 48" E 15	6	CORNER BEACON	208
	17° 09' 29" E 14	7	CORNER BEACON	208
	17° 09' 23" E 13	8	CORNER BEACON	208
3 28° 05' 40" S 28° 05' 40" S 28° 05' 59" S 28° 05' 59" S	17° 09' 48" E 12	9	CORNER BEACON	208
	17° 09' 58" E 11	10	CORNER BEACON	208
	17° 09' 58" E 10	11	CORNER BEACON	208
	17° 09' 48" E 9	12	CORNER BEACON	208
2 28° 05' 39" S 28° 05' 39" S 28° 05' 58" S ✓ 28° 05' 57" S	17° 10' 00" E 8	13	CORNER BEACON	208
	17° 10' 11" E 7	14	CORNER BEACON	208
	17° 10' 09" E 6	15	CORNER BEACON	208
	17° 09' 58" E 5	16	CORNER BEACON	208
1 28° 05' 39" S 28° 05' 39" S 28° 05' 59" S 28° 05' 58" S ✓	17° 10' 11" E 4	17	CORNER BEACON ①	208
	17° 10' 21" E 3	18	CORNER BEACON ②	208
	17° 10' 20" E 2	19	CORNER BEACON ③	208
	17° 10' 09" E 1	20	CORNER BEACON ④	208

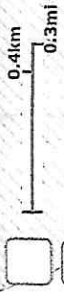
ORIGINAL NUMBER



- Active
 - Mining Licences
 - Mining Claims
 - Mineral Deposit Retention Licences
 - Exclusive Prospecting Licences
 - Reconnaissance Licences
 - Exclusive Reconnaissance Licences
- Applications
 - Administration
 - Withdrawn Areas
 - Environmentally Sensitive Areas
- Farms
- Geology
- Mineral Occurrences
- Heritage Sites
- Satellite Imagery

28°55' S 17°10'33" E

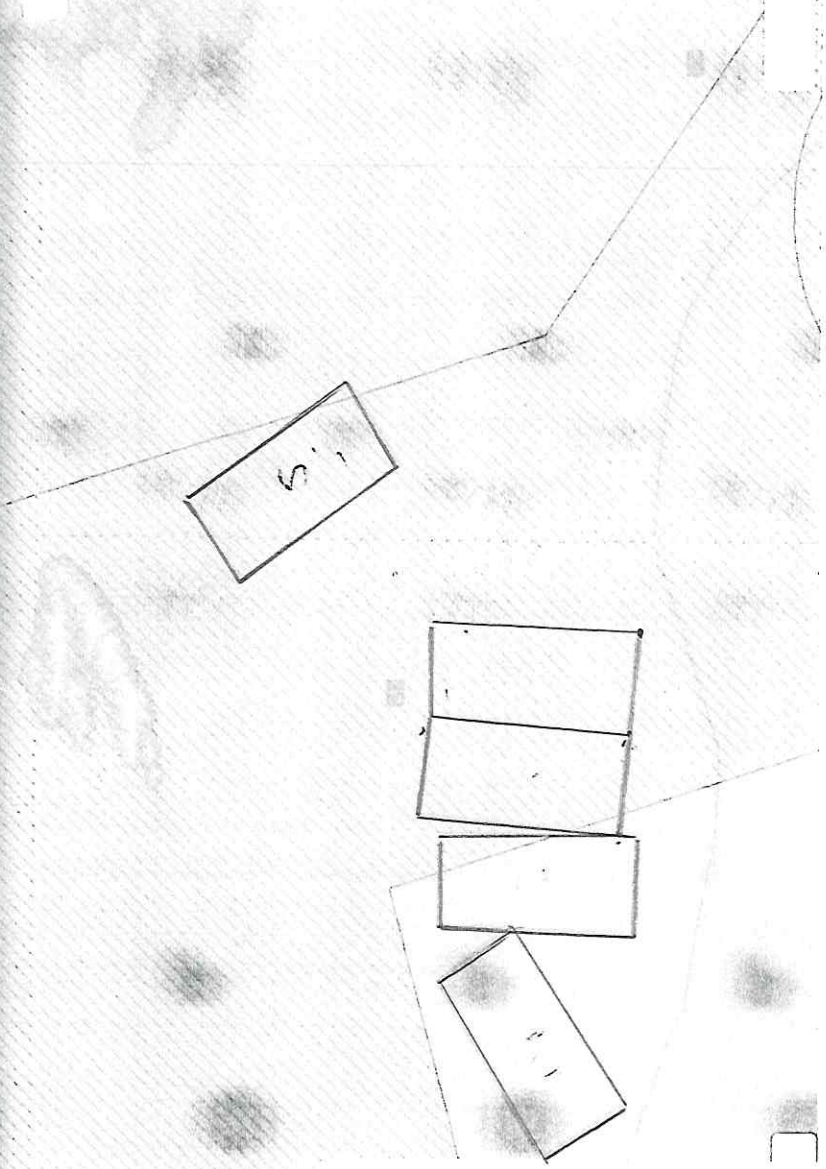

albert albertus diergaardt

Application (s)	Application
72004 Albert Albertus Diergaardt Mining Claim	Application
72006 Albert Albertus Diergaardt Mining Claim	Application
72005 Albert Albertus Diergaardt Mining Claim	Application
72007 Albert Albertus Diergaardt Mining Claim	Application
72008 Albert Albertus Diergaardt Mining Claim	Application

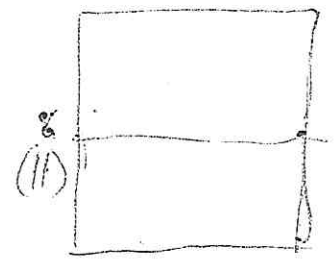

BUSINESS AND INTELLECTUAL PROPERTY AUTHORITY - BIPA

COMPANIES ACT 2004
(Section 50(3)) (Regulation 16(1))
(to be lodged in duplicate)



CM9

CERTIFICATE OF CHANGE OF NAME OF COMPANY

Registration Number of Company
2021/0783

This is to certify that

**OPUNTIA TRADING ENTERPRISES
(PROPRIETARY) LIMITED**

has changed its name by SPECIAL RESOLUTION and is now called

**ENON MINING EXPLORATION
(PROPRIETARY) LIMITED**

and that the new name has this day been entered in the Register of Companies

Signed and sealed at WINDHOEK this 10 day of May of the year 2020

Registrar of Business

Seal of Business Registration Office

This certificate is not valid unless sealed by the seal of the Business Registration Office



REPUBLIC OF NAMIBIA

MINISTRY OF MINES AND ENERGY
Office of the Mining Commissioner

Tel.: +264 61 284-8276/77
Fax: +264 61 284-8299
E-mail: info@mme.gov.na
Website: www.mme.gov.na

1 Aviation Road
Private Bag 13297
WINDHOEK

Enquiries	Mr Asser /Goagoseb
Reference Number	14/2/1/1/5168
Date	05 August 2021

Mr Albert Diergaardt
PO Box 3467
REHOBOTH

Dear Mr Diergaardt,

APPLICATION OF MINING CLAIMS WITH REGISTRATION NUMBERS 72004 – 72008 IN TERMS OF SECTION 36(1) OF THE MINERALS (PROSPECTING AND MINING) ACT, No. 33 OF 1992 (HEREINAFTER "the Act").

With reference to your application of 15 July 2020 to register the above-mentioned mining claims we attach the Certificate of Registration of Mining Claims issued in respect of the approval of such registration.

Please note that this registration is subject to certain general terms and conditions as set out on page 2 of the said certificate. Acquaint yourself with these terms and conditions as well as the general provisions of the Act with respect to mineral licences and mining claims in particular.

In addition, the National Heritage Council is concerned with the protection and conservation of places and objects of heritage significance. Thus, you are to familiarise yourself with the provisions of the National Heritage Act, No. 27 of 2004 and its Regulations. Similarly, familiarise yourself with the provisions of the Environmental Management Act, No. 7 of 2007 and its Regulations.

Bear in mind that should you fail to adhere to these terms and conditions, your mining claims will be cancelled in terms of Section 44 of the Act.

Yours sincerely,

 05.08.2021
MR EI SHIVOLO
MINING COMMISSIONER





REPUBLIC OF NAMIBIA

MINISTRY OF MINES AND ENERGY
Office of the Mining Commissioner

Tel.: +264 61 284-8301
Fax: +264 61 284-8299
E-mail: info@mme.gov.na
Website: www.mme.gov.na

1 Aviation Road
Private Bag 13297
WINDHOEK

CERTIFICATE OF REGISTRATION OF MINING CLAIMS*
Registered in terms of Section 36 of the Minerals (Prospecting and Mining Act, No. 33 of 1992 ("the Act"))

PARTICULARS OF MINING CLAIM HOLDER

Table with 2 columns: Field Name, Value. Fields include Reference Number, Registered To, Address, Postal Address, Cell Phone.

PARTICULARS OF MINING CLAIMS

Table with 4 columns: Ordinal No., Date Pegged, Registered No., Group of Minerals. Lists 5 claims.

VALIDITY OF MINING CLAIMS

Table with 2 columns: Date of Renewal, Date of Expiry. Includes a section 38 of the act notice.

PARTICULARS OF LOCATION OF MINING CLAIMS

Table with 4 columns: Name of Location, Owned By, District, Region. Location is State Land.

Registered and issued at Windhoek on this 05th day of August 2021

Signature of Mr. El ShivoLO
MR EL SHIVOLO
MINING COMMISSIONER

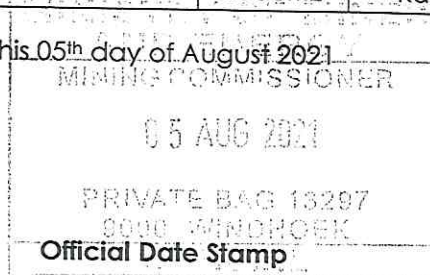

All official correspondence must be addressed to the Executive Director

Handwritten mark

General terms and conditions for the registration of mining claims 72004 – 72008

The holder of the mining claim shall –

- Acquaint him/herself with the provisions of Parts I, II, V, VI, VII, XIII, XV, XVI and XVII, and Schedule 1 of the Act.
- Exercise his rights under the mining claim reasonably and in such manner that the rights and interests of the landowner or land occupier are not adversely affected, except to the extent to which such owner is compensated (Section 41(1)(a)).
- In the instance of private land, not exercise any rights under the mining claim until a written agreement has been entered into with the owner of such land (Sections 31(2) and 52) or has been granted an ancillary right (Section 110(4)).
- Submit to the Mining Commissioner a copy of the written compensation agreement entered with the landowner (Section 52(1)(a)(i)).
- In the instance of communal- or other State land, obtain the written consent of the Chief or Head of the Traditional Authority, and submit a copy to the Mining Commissioner.
- Not drill any borehole unless such holder has given the Mining Commissioner notice of such holder's intention to drill (Section 53).
- Before the erection or construction of any accessory works, apply to the Mining Commissioner for an accessory works permit (Section 31(3)).
- Maintain in good condition and repair all accessory works in such claim area (Section 41(1)(f)) and take reasonable steps to warn persons who may be in the vicinity of any accessory works of possible hazards (Section 41(1)(h)).
- Carry on mining operations in the claim area in accordance with good mining practices (Section 41(1)(b)).
- Always maintain all beacons in a decent and readable condition (Section 41(1)(c)).
- Take all reasonable steps to secure the safety, welfare and health of all employees and prevent or minimize any pollution to the environment (Section 41(1)(e)).
- Remove from the claim area all structures, equipment and other goods not used or intended to be used (Section 41(1)(g)).
- In the case of company –
 - Give written notice to the Mining Commissioner of any change of such company (e.g., name, address, directors, shareholding, etc.) within 30 days as from such change (Section 41(1)(j)).
- In the case of a natural person –
 - Give written notice to the Mining Commissioner of any change of such natural person (e.g., name, surname, address, etc.) within 30 days as from such change (Section 41(1)(k)).
- Keep at an address in Namibia a proper record in relation to any –
 - Prospecting operations (Section 45(1)(a)(ii)), and
 - Mining operations (Section 45(1)(a)(i)),for a period of not less than 3 years.
- Submit monthly reports within 15 days after the end of each month to the Mining Commissioner (Section 45(1)(d)).
- Submit annual reports within 60 days after 31 December of each year to the Mining Commissioner (Section 45(1)(e)).
- Pay annual mining claim fees before or on the anniversary date of the date of registration of the mining claim (Section 123(1)).
- Be penalised for late payment of fees (Section 115).

It shall be generally accepted that the holder of a mining claim is acquainted with all the provisions of the Minerals (Prospecting and Mining) Act, No. 33 of 1992.

DIAGRAM – Mining Claim – 72008

Issued in favour of: Albert Albertus Diergaardt

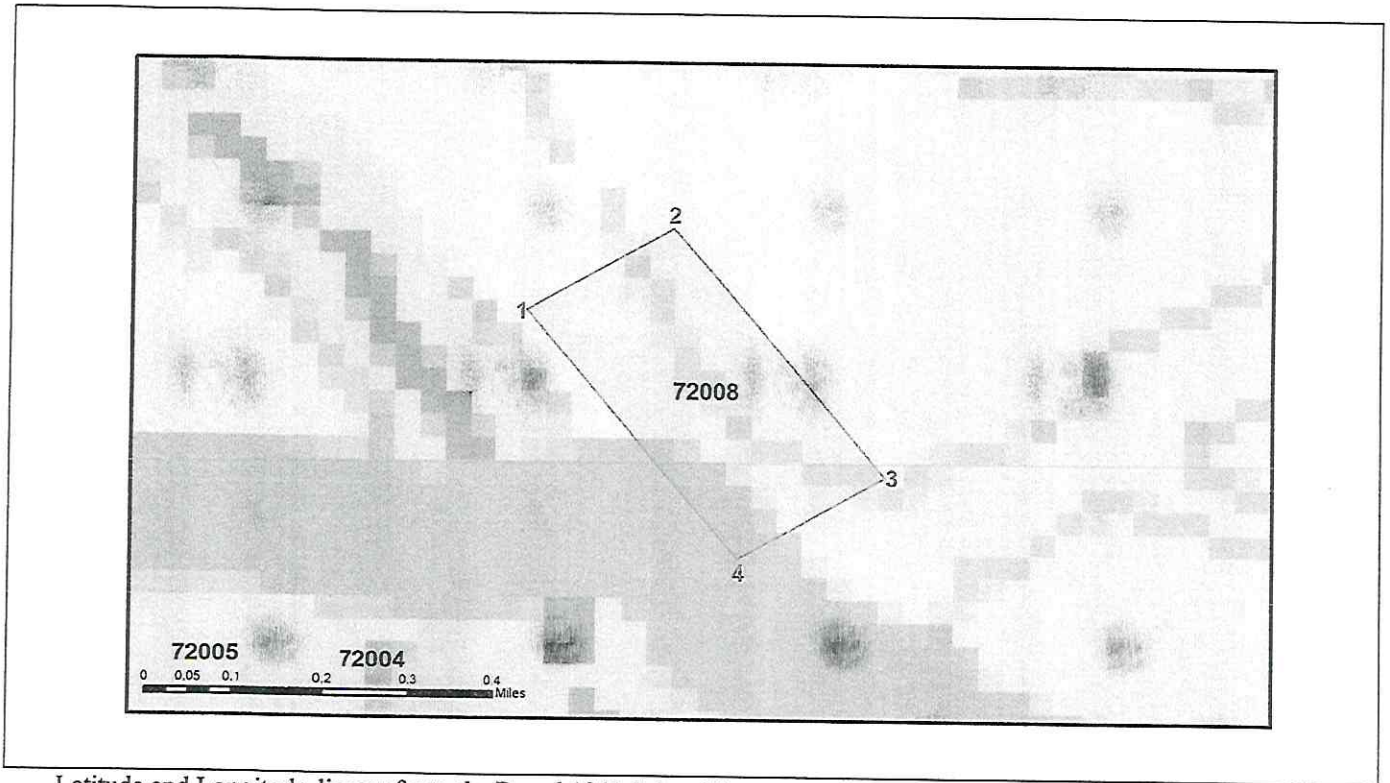

Latitude and Longitude lines refer to the Bessel 1841 Spheroid

EPL - Application	ERL - Application	Withdrawn Area	District
<input type="checkbox"/>	<input type="checkbox"/>	<input type="checkbox"/>	<input type="checkbox"/>
EPL - Active	ERL - Active	Farms	Region
<input type="checkbox"/>	<input checked="" type="checkbox"/>	<input type="checkbox"/>	<input type="checkbox"/>
ML - Application	RL - Application	Environmentally Sensitive	Division
<input type="checkbox"/>	<input type="checkbox"/>	<input type="checkbox"/>	<input type="checkbox"/>
ML - Active	RL - Active		
<input type="checkbox"/>	<input checked="" type="checkbox"/>		
MC - Application	MDRL - Application		
<input type="checkbox"/>	<input type="checkbox"/>		
MC - Active	MDRL - Active		
<input checked="" type="checkbox"/>	<input checked="" type="checkbox"/>		

Projection: Albers Conic Equal Area
 Spheroid: Bessel 1841
 Central Meridian: 17-Deg. E

AREA: 16.8131 Hectares

MAP(S):

LOCALITY:

*Regions(s): Karas

*Magisterial District(s): Karasburg

*Registration Division(s): V

DIAGRAM – Mining Claim – 72007

Issued in favour of: Albert Albertus Diergardt

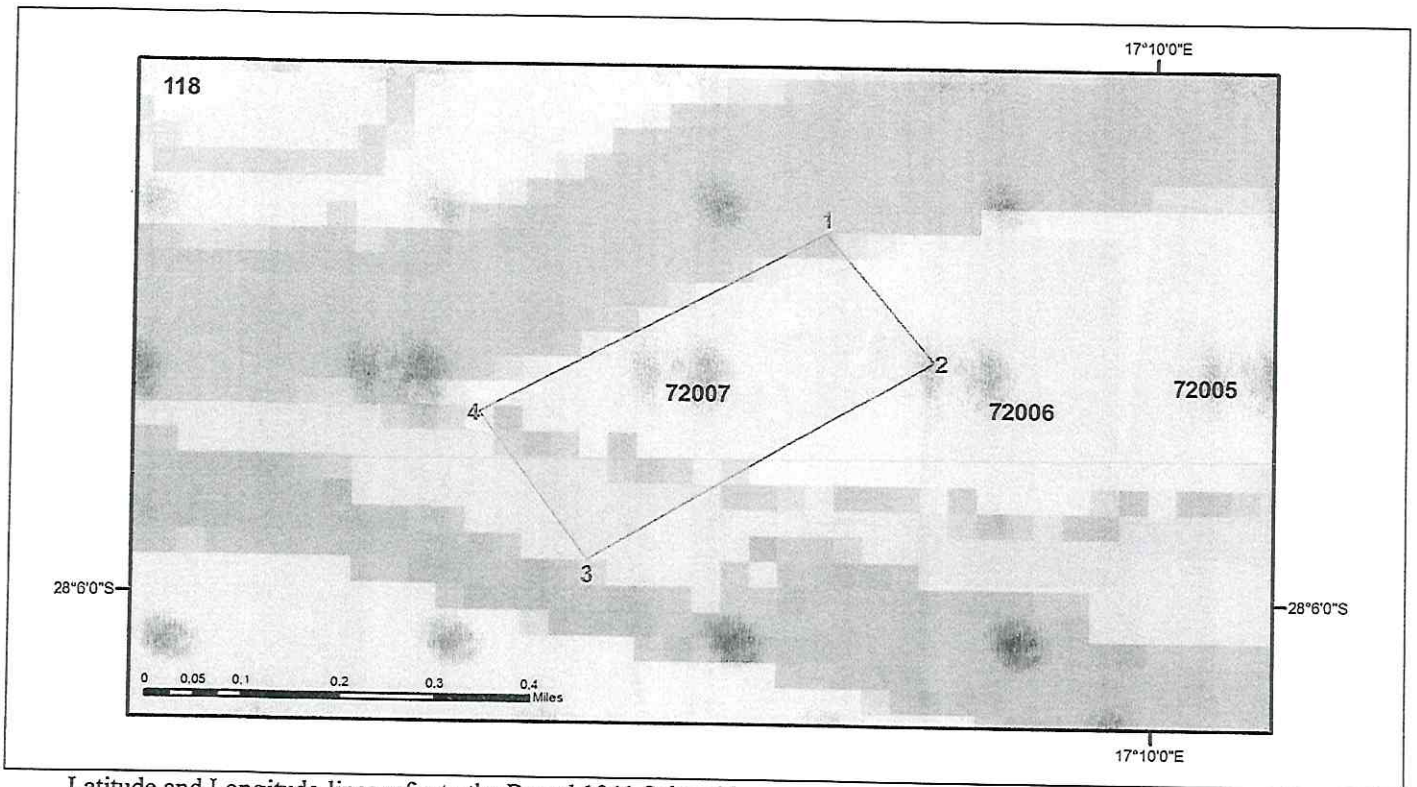

Latitude and Longitude lines refer to the Bessel 1841 Spheroid

EPL - Application	ERL - Application	Withdrawn Area	District
<input type="checkbox"/>	<input type="checkbox"/>	<input type="checkbox"/>	<input type="checkbox"/>
EPL - Active	ERL - Active	Farms	Region
<input type="checkbox"/>	<input checked="" type="checkbox"/>	<input type="checkbox"/>	<input type="checkbox"/>
ML - Application	RL - Application	Environmentally Sensitive	Division
<input type="checkbox"/>	<input type="checkbox"/>	<input type="checkbox"/>	<input type="checkbox"/>
ML - Active	RL - Active		
<input type="checkbox"/>	<input checked="" type="checkbox"/>		
MC - Application	MDRL - Application		
<input type="checkbox"/>	<input type="checkbox"/>		
MC - Active	MDRL - Active		
<input checked="" type="checkbox"/>	<input checked="" type="checkbox"/>		

Projection: Albers Conic Equal Area
 Spheroid: Bessel 1841
 Central Meridian: 17 Deg. E

AREA: 17.2743 Hectares

MAP(S):

LOCALITY:

*Region(s): Karas

*Magisterial District(s): Luderitz

*Registration Division(s): N

DIAGRAM – Mining Claim – 72006

Issued in favour of: Albert Albertus Diergaardt

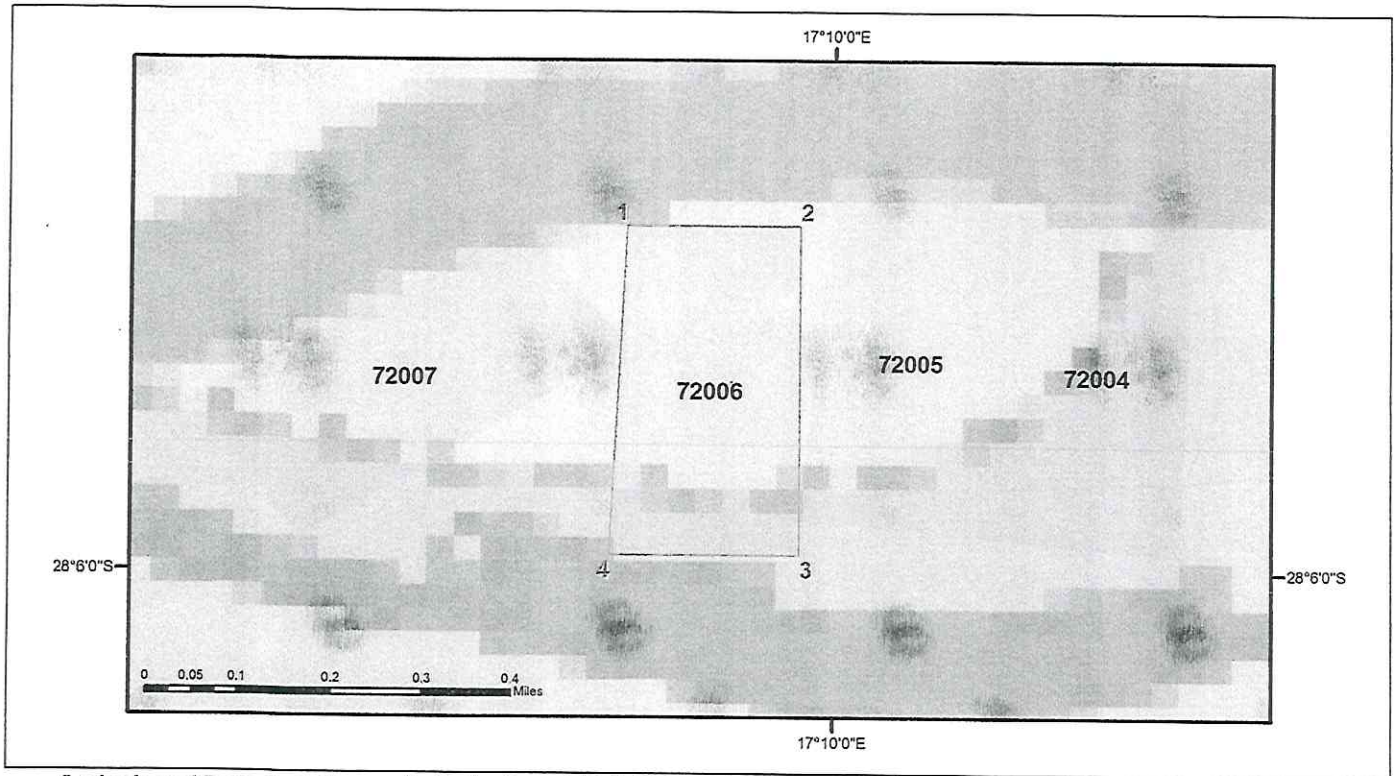

Latitude and Longitude lines refer to the Bessel 1841 Spheroid

EPL - Application	ERL - Application	Withdrawn Area	District
<input type="checkbox"/>	<input type="checkbox"/>	<input type="checkbox"/>	<input type="checkbox"/>
EPL - Active	ERL - Active	Farms	Region
<input type="checkbox"/>	<input type="checkbox"/>	<input type="checkbox"/>	<input type="checkbox"/>
ML - Application	RL - Application	Environmentally Sensitive	Division
<input type="checkbox"/>	<input type="checkbox"/>	<input type="checkbox"/>	<input type="checkbox"/>
ML - Active	RL - Active		
<input type="checkbox"/>	<input type="checkbox"/>		
MC - Application	MDRL - Application	<div style="border: 1px solid black; padding: 5px;"> Projection: Albers Conic Equal Area Spheroid: Bessel 1841 Central Meridian: 17 Deg. E </div>	
<input type="checkbox"/>	<input type="checkbox"/>		
MC - Active	MDRL - Active		
<input type="checkbox"/>	<input type="checkbox"/>		

AREA: 16.7700 Hectares

MAP(S):

LOCALITY:

- *Regions(s): Karas
- *Magisterial District(s): Luderitz
- *Registration Division(s): N

Order	Lat Deg	Lat Min	Lat Sec		Long Deg	Long Min	Long Sec	
1	-28	05	40.00	S	17	09	48.00	E
2	-28	05	40.00	S	17	09	58.00	E
3	-28	05	59.00	S	17	09	58.00	E
4	-28	05	59.00	S	17	09	47.00	E

Official Stamp

DIAGRAM – Mining Claim – 72005

Issued in favour of: Albert Albertus Diergaardt

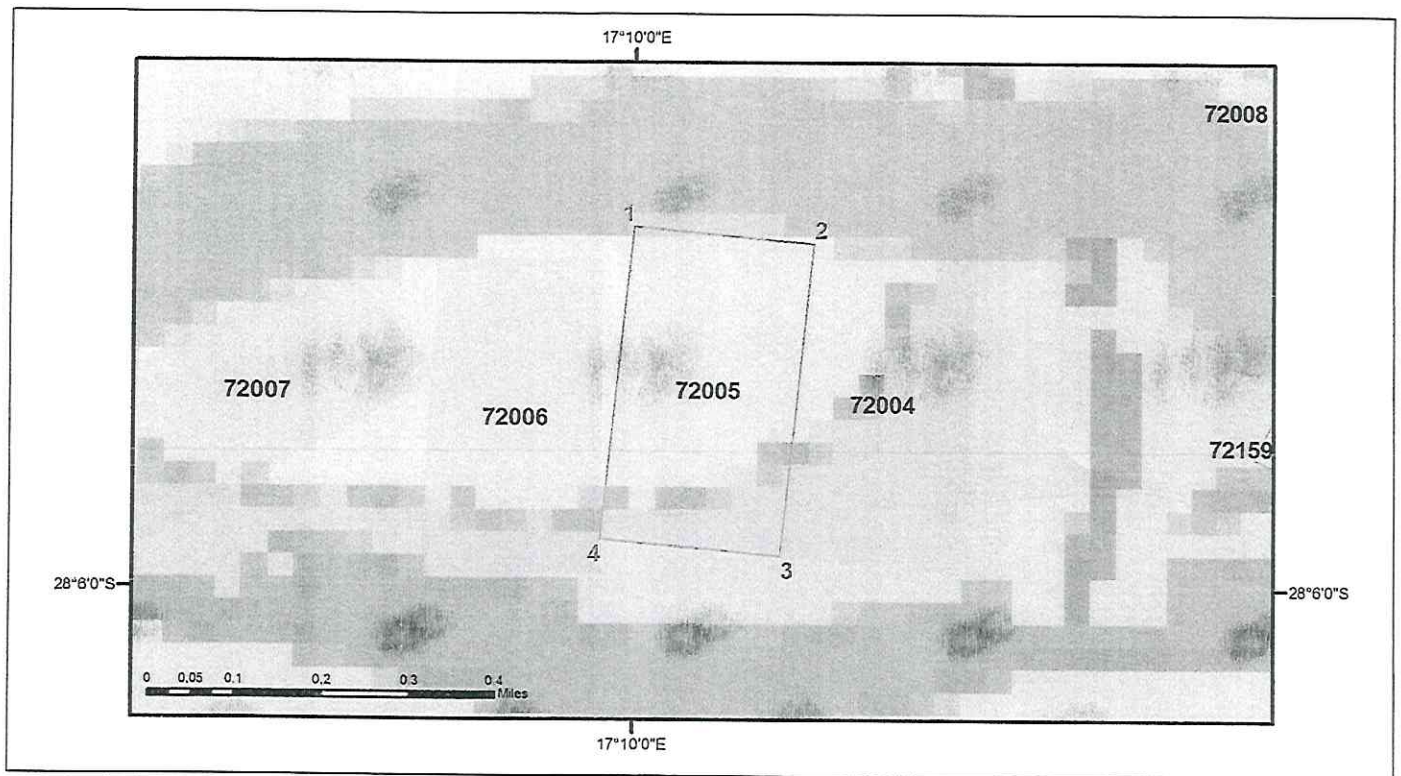

Latitude and Longitude lines refer to the Bessel 1841 Spheroid

EPL - Application	ERL - Application	Withdrawn Area	District
EPL - Active	ERL - Active	Farms	Region
ML - Application	RL - Application	Environmentally Sensitive	Division
ML - Active	RL - Active		
MC - Application	MDRL - Application	Projection: Albers Conic Equal Area Spheroid: Bessel 1841 Central Meridian: 17 Deg. E	
MC - Active	MDRL - Active		

AREA: 17.7367 Hectares

MAP(S):

LOCALITY:

*Regions(s): Karas

*Magisterial District(s): Luderitz

*Registration Division(s): N

DIAGRAM – Mining Claim – 72004

Issued in favour of: Albert Albertus Diergaardt

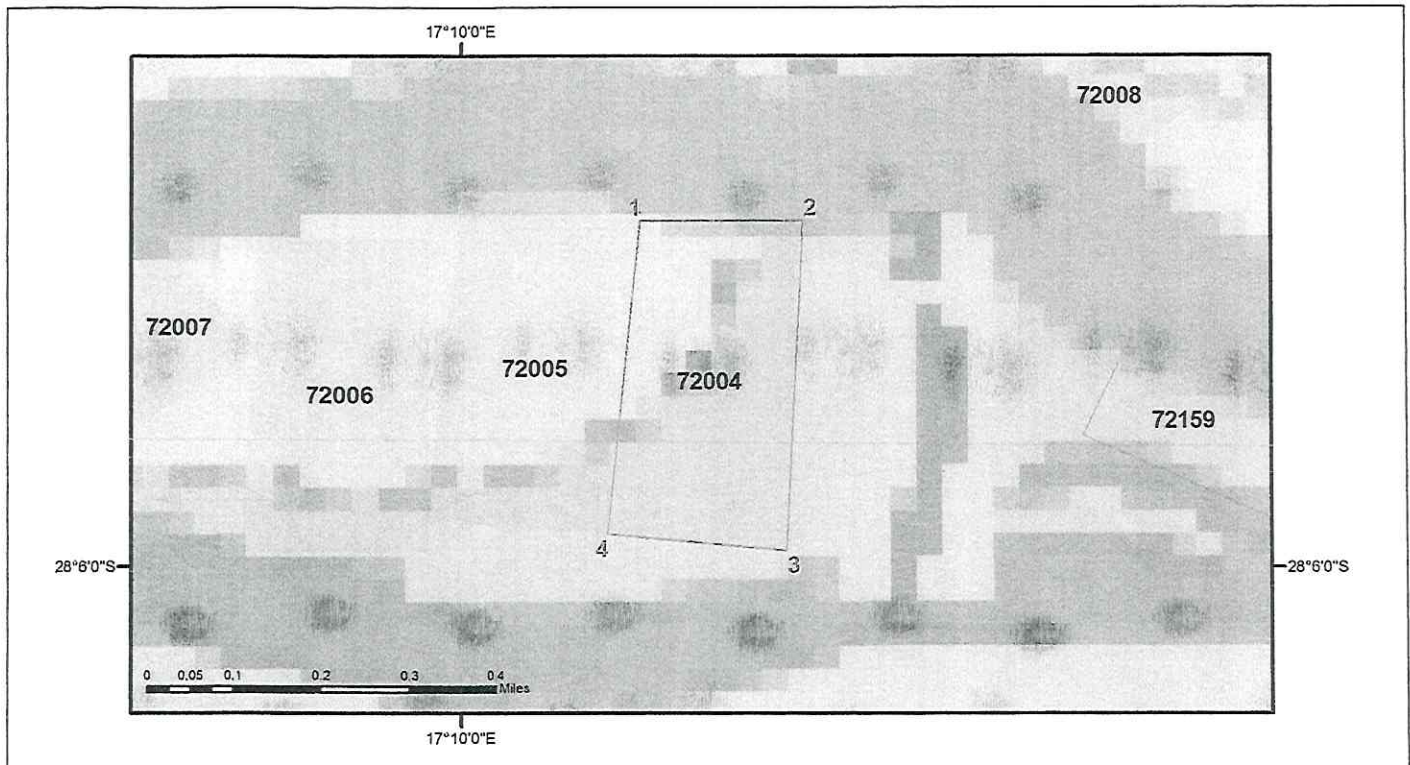

Latitude and Longitude lines refer to the Bessel 1841 Spheroid

EPL - Application □	ERL - Application □	Withdrawn Area □	District □
EPL - Active □	ERL - Active ■	Farms □	Region □
ML - Application □	RL - Application □	Environmentally Sensitive □	Division □
ML - Active □	RL - Active ■		
MC - Application □	MDRL - Application □	<div style="border: 1px solid black; padding: 5px;"> Projection: Albers Conic Equal Area Spheroid: Bessel 1841 Central Meridian: 17 Deg. E </div>	
MC - Active ■	MDRL - Active ■		

AREA: 17.2742 Hectares

MAP(S):

LOCALITY:

*Regions(s): Karas

*Magisterial District(s): Luderitz

*Registration Division(s): V, N