

MINISTRY OF ENVIRONMENT
AND TOURISM
DEPARTMENT OF ENVIRONMENTAL AFFAIRS
2020-05-27
RECEIVED

SCREENING QUESTIONNAIRE FOR PROJECTS



MINISTRY OF ENVIRONMENT & TOURISM
DIRECTORATE OF ENVIRONMENTAL AFFAIRS

The completion of this questionnaire is a requirement under section 20 (1) of the Environmental Management Act

PURPOSE OF THIS QUESTIONNAIRE

The information you provide in this questionnaire will provide the Government to gain a clear understanding of your proposed project.

Projects that are likely to have a significant impact on the environment may not go ahead unless an Environmental Assessment (EA) has been done first, and only if EA can demonstrate that it is possible and feasible to keep impacts to acceptable levels.

Nearly all projects have some impact, but some projects are so small and impacts so low, that it may not be necessary to do a full EA. On the other hand, some projects could have serious environmental impacts, and it is essential that we identify these before the projects are implemented. If an EA is not done, we may only discover the impacts after the project implementation. By then, it is usually too late to avoid the impacts. If this happens the developer might have to spend a lot of money fixing the problem or even abandon the project altogether.

The information you provide in this questionnaire can help us to make the right decision of whether an EA should be done or not, the level of detail of the EA, the main issues which should be investigated, and so on. This guides all of us in our future planning and could save money and time in the long run.

The developer must complete this questionnaire accurately, honestly and comprehensively. The Environmental Commissioner and the relevant ministry will jointly decide on whether the EA is necessary or not. Their decision based on whether the project is likely to have significant effect on the environment by virtue of its nature, size or location.

Your cooperation is essential

GENERAL INFORMATION

Name of the proposed project Namibia Girls Leadership Academy

Location of the proposed project 976 Farm Kommetje - Portion 1

Name of the Proponent/ Developer Ornambonde Estate

Contact Person Ms. Julieta Kavetuna

Address of the Proponent/ Developer 3692, Luxury Hill Windhoek
P. Box 3777, Windhoek

Tel: 0812831279 Fax: lpkavetuna@hotmail.com

NB: As stated on page 2 above, the information to be provided in this questionnaire will assist the Ministry to determine whether an EA is required or not. Therefore, such information must be as truthful and reliable as possible. It must be noted here that the proponent is accountable for any wrong and misleading information that may be provided in this questionnaire. From this perspective, any person who completes this questionnaire **must read and sign the declaratory statement provided on page 14** of this questionnaire.

PROJECT SUMMARY

Briefly describe the nature and purpose of the project. Provide key information on the projects main activities, industrial processes, raw materials, infrastructure, lifespan and closure. If available, attach a map, ground plan and a copy of pre-feasibility or feasibility reports

The Namibia Girls Leadership Academy is an envisaged only girls school to be situated on a Commercial farm land in the Grootfontein District. The planned project will entails a Primary School, with a hostel facility accommodating 320 girls by the beginning of 2026. An annual intake of 80 learners is anticipated on a gradual basis. There will be a construction of nearly 70 rooms of different size which will consist of offices, Halls, Class rooms dormitories, Bigger Rooms for a variety of activities. Furthermore a sportsfield and a swimming school will be erected on the side. The project is expected acquire electricity from a line on the Northern side of the farm, while water reservoirs on the farm is sufficient to supply the operation of project for more years. As for the sewerage a septic tank of 10x15m with a depth of 6m is planned to be constructed at the towards the North East of the farm. This project will occupy a total area of 6 HA.

Guideline for completing the questionnaire

The following questions are designed to aid the screening processes. Questions are arranged in two sections with a series of sub headings.

Project information

Page No.

(Construction, operation & decommissioning)

- General -----
- Atmospheric environment -----
- Aquatic environment-----
- Waste Generation -----
- Hazards -----
- Social -----

The questions must be answered with a simple yes, or no? (if you do not know the answer). A space for any additional comments is also provided.

The person completing the questionnaire should base his/her answers on existing information. If the answers to some questions are not available or uncertain, please state this in the details/ comments space.

Environmental information

- Legislative protection -----
- General characteristics -----
- Aquatic features -----
- Landscape & visual characteristics -----
- Atmospheric conditions -----
- Historic and cultural features -----
- Stability -----
- Ecology -----
- Land Use -----
- Declaration -----

Project Information

General		Details/ Comments
<ul style="list-style-type: none"> Is a license/ permit required for the activity? 	<input type="checkbox"/> Yes <input checked="" type="checkbox"/> No <input type="checkbox"/> ?	<hr/> <hr/> <hr/>
<ul style="list-style-type: none"> Is the project an extension of an existing activity? 	<input type="checkbox"/> Yes <input checked="" type="checkbox"/> No <input type="checkbox"/> ?	<hr/> <hr/> <hr/>
<ul style="list-style-type: none"> Will the project involve land disturbance, site clearance, earthmoving, or underground workings? 	<input checked="" type="checkbox"/> Yes <input type="checkbox"/> No <input type="checkbox"/> ?	<p>A area of 6 HA need to be cleared and sewerage/ septic tank of 6m deep need to be constructed.</p> <hr/> <hr/> <hr/>
<ul style="list-style-type: none"> Will the project involve re-zoning? 	<input type="checkbox"/> Yes <input checked="" type="checkbox"/> No <input type="checkbox"/> ?	<hr/> <hr/> <hr/>
<ul style="list-style-type: none"> Will the project involve the transport, storage, handling, production or use of toxic or hazardous substances? 	<input type="checkbox"/> Yes <input checked="" type="checkbox"/> No <input type="checkbox"/> ?	<hr/> <hr/> <hr/>
<ul style="list-style-type: none"> Will the project require the construction of facilities to bring power or water to the project? 	<input checked="" type="checkbox"/> Yes <input type="checkbox"/> No <input type="checkbox"/> ?	<p>Electricity supply (Whether from the grid or solar will be needed).</p> <hr/> <hr/> <hr/>
<ul style="list-style-type: none"> Will new roads be constructed? 	<input type="checkbox"/> Yes <input checked="" type="checkbox"/> No <input type="checkbox"/> ?	<hr/> <hr/> <hr/>
<ul style="list-style-type: none"> Will construction or operation of the project generate large volumes of traffic? 	<input type="checkbox"/> Yes <input checked="" type="checkbox"/> No <input type="checkbox"/> ?	<hr/> <hr/> <hr/>

General (Continued)		Details/ Comments
Will explosives be used?	<input type="checkbox"/> Yes <input checked="" type="checkbox"/> No <input type="checkbox"/> ?	-----
Will the project have large water requirements? (If yes, where will water be obtained?)	<input checked="" type="checkbox"/> Yes <input type="checkbox"/> No <input type="checkbox"/> ?	<p>The project will require more water, which is already available as the water storage of 60000L is constructed at the site.</p>
Will the project have significant energy requirements?	<input checked="" type="checkbox"/> Yes <input type="checkbox"/> No <input type="checkbox"/> ?	<p>For lights, and the operation of electrical academic equipments such as computers and others.</p>
Atmospheric Environment		
Will the project generate emissions to the air from fuel combustion, production processes or other sources?	<input type="checkbox"/> Yes <input checked="" type="checkbox"/> No <input type="checkbox"/> ?	-----
Will the project involve disposal of waste through burning in the open air (e.g. slash material and construction debris)?	<input type="checkbox"/> Yes <input checked="" type="checkbox"/> No <input type="checkbox"/> ?	-----
Will the project give smell/ odour emissions?	<input type="checkbox"/> Yes <input checked="" type="checkbox"/> No <input type="checkbox"/> ?	-----
Aquatic & Marine Environment		
Will the project require disposal of large volumes of sewage or industrial effluent?	<input checked="" type="checkbox"/> Yes <input type="checkbox"/> No <input type="checkbox"/> ?	<p>People who will be stationed at the site by the 2026 will be around 350 thus the volume of sewage will significantly increase.</p>
----- -----	<input type="checkbox"/> Yes <input checked="" type="checkbox"/> No <input type="checkbox"/> ?	-----

Hazards

Will the project involve regular use of substances for pest or weed control?

- Yes
- No
- ?

Social

Will project involve employment of large numbers of workers?

- Yes
- No
- ?

Will the project provide housing and other facilities for the workforce?

- Yes
- No
- ?

Any Other project information

The farm is this farm

is both suitable for crop and animals, thus a lot of planting of trees, vegetable for consumption and will be effectual to promote the green effect.

- Yes
- No
- ?

- Yes
- No
- ?

- Yes
- No
- ?

Details/ Comments

The structure is to commence with a workforce of 20 people but will gradually increase to 60 in 5 years time.

Only the 10 support staff will be residing on the farm, the rest will be transported daily from Kombot which is 55km from the farm.

General characteristics		Details/ Comments
Is the project located in or near a game reserve?	<input type="checkbox"/> Yes <input checked="" type="checkbox"/> No <input type="checkbox"/> ?	<hr/> <hr/> <hr/>
Is the project located in an area with unique landscape or scenery?	<input type="checkbox"/> Yes <input checked="" type="checkbox"/> No <input type="checkbox"/> ?	<hr/> <hr/> <hr/>
Is the project located in an area with unique wildlife?	<input type="checkbox"/> Yes <input checked="" type="checkbox"/> No <input type="checkbox"/> ?	<hr/> <hr/> <hr/>
Is the project located in an area with unique Plant life?	<input type="checkbox"/> Yes <input checked="" type="checkbox"/> No <input type="checkbox"/> ?	<hr/> <hr/> <hr/>
Are there any archaeological features nearby?	<input type="checkbox"/> Yes <input checked="" type="checkbox"/> No <input type="checkbox"/> ?	<hr/> <hr/> <hr/>
Are there any national monuments nearby?	<input type="checkbox"/> Yes <input checked="" type="checkbox"/> No <input type="checkbox"/> ?	<hr/> <hr/> <hr/>
Is the area already experiencing pollution or other environmental damage?	<input type="checkbox"/> Yes <input checked="" type="checkbox"/> No <input type="checkbox"/> ?	<hr/> <hr/> <hr/>
Will the project be located in or close to wetlands, rivers or any other waterbody (including groundwater)?	<input type="checkbox"/> Yes <input checked="" type="checkbox"/> No <input type="checkbox"/> ?	<hr/> <hr/> <hr/>
<hr/> <hr/>	<input type="checkbox"/> Yes <input checked="" type="checkbox"/> No <input type="checkbox"/> ?	<hr/> <hr/> <hr/>
<hr/> <hr/>	<input type="checkbox"/> Yes <input checked="" type="checkbox"/> No <input type="checkbox"/> ?	<hr/> <hr/> <hr/>

Aquatic Features		Details/ Comments
Will the project adversely affect the quality, flow or volume of surface or groundwater?	<input type="checkbox"/> Yes <input checked="" type="checkbox"/> No <input type="checkbox"/> ?	-----
Visual Characteristics	<input checked="" type="checkbox"/> Yes <input checked="" type="checkbox"/> No <input type="checkbox"/> ?	<i>The farm is located ^{in the close proximity of} Public Road 52902 and the project will be only 1 km from the main road.</i>
Will the project be visible to the public?	<input type="checkbox"/> Yes <input checked="" type="checkbox"/> No <input type="checkbox"/> ?	-----
Erosion	<input type="checkbox"/> Yes <input checked="" type="checkbox"/> No <input type="checkbox"/> ?	-----
Is the project likely to cause soil erosion?	<input type="checkbox"/> Yes <input checked="" type="checkbox"/> No <input type="checkbox"/> ?	-----
Ecology	<input type="checkbox"/> Yes <input checked="" type="checkbox"/> No <input type="checkbox"/> ?	-----
Will the project result in loss or disturbance of valuable habitats or ecosystems?	<input type="checkbox"/> Yes <input checked="" type="checkbox"/> No <input type="checkbox"/> ?	-----
Will the project disturb wildlife migration, feeding or breeding?	<input type="checkbox"/> Yes <input checked="" type="checkbox"/> No <input type="checkbox"/> ?	-----
Will the project cause the introduction of alien (exotic) plants or animals (excluding livestock)?	<input type="checkbox"/> Yes <input checked="" type="checkbox"/> No <input type="checkbox"/> ?	-----
Will the project significantly increase the risk of veldfires?	<input type="checkbox"/> Yes <input checked="" type="checkbox"/> No <input type="checkbox"/> ?	-----

Land Use		Details/ Comments
Will the project be located in a densely populated area or in the vicinity of residential property or other sensitive land uses (e.g. schools, hospitals, community facilities)	<input type="checkbox"/> Yes <input checked="" type="checkbox"/> No <input type="checkbox"/> ?	-----
Will the project be located on land of high agricultural value?	<input checked="" type="checkbox"/> Yes <input type="checkbox"/> No <input type="checkbox"/> ?	<i>It's on the commercial farm, which is both suitable for crop and animal husbandry.</i>
Will the project be located in an area of recreational/ tourist importance?	<input type="checkbox"/> Yes <input checked="" type="checkbox"/> No <input type="checkbox"/> ?	-----
Land & Property		-----
Will the project require any people to be moved or resettled?	<input type="checkbox"/> Yes <input checked="" type="checkbox"/> No <input type="checkbox"/> ?	-----
Will the project require any people to be removed or resettled?	<input type="checkbox"/> Yes <input checked="" type="checkbox"/> No <input type="checkbox"/> ?	-----
Will the project attract a large number of people into the area?	<input checked="" type="checkbox"/> Yes <input type="checkbox"/> No <input type="checkbox"/> ?	<i>Many parents and friends will be requesting the area to bring or take the children from school.</i>
Will the project result in demolition of structures or occupation of homes, gardens, businesses?	<input type="checkbox"/> Yes <input checked="" type="checkbox"/> No <input type="checkbox"/> ?	-----
Will the existing population be physically divided as a result of a project?	<input type="checkbox"/> Yes <input checked="" type="checkbox"/> No <input type="checkbox"/> ?	-----

Wider Consideration

- Has there been public concern about the project?
- Will the project have an impact on the neighbouring country?
- Has the public been consulted yet about the project?

Other Environmental information

- None
- _____
- _____
- _____
- _____
- _____

<input type="checkbox"/>	Yes
<input checked="" type="checkbox"/>	No
<input type="checkbox"/>	?
<input checked="" type="checkbox"/>	Yes
<input checked="" type="checkbox"/>	No
<input type="checkbox"/>	?
<input type="checkbox"/>	Yes
<input checked="" type="checkbox"/>	No
<input type="checkbox"/>	?
<input type="checkbox"/>	Yes
<input type="checkbox"/>	No
<input type="checkbox"/>	?
<input type="checkbox"/>	Yes
<input type="checkbox"/>	No
<input type="checkbox"/>	?
<input type="checkbox"/>	Yes
<input type="checkbox"/>	No
<input type="checkbox"/>	?

Details/ Comments

Yes, it will impact the neighbouring countries positively especially Zambia & Angola as they might not send the girls to South Africa for schooling any longer.

Declaration

I Julietta Kavekung (name in full) understands that the information that I have provided in this questionnaire will be used by the Ministry of Environment and Tourism to decide whether my project requires an EA or not. I also understand that any wrong information provided in this questionnaire will mislead the decision of the Ministry on my project. Should this be the case, I am well aware that the Ministry will hold me accountable for my wrong and misleading information. Therefore, I honestly declare that the information that I have provided in this questionnaire is to the best of my ability true and reliable.

Signature:

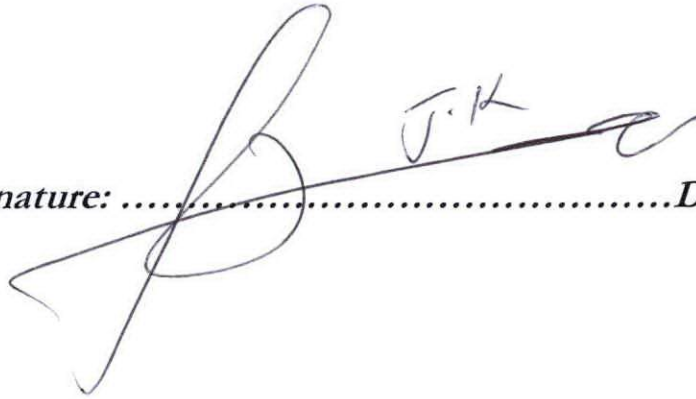
A large, stylized handwritten signature in black ink, written over a dotted line. The signature is cursive and appears to be 'Julietta Kavekung'. There is a small 'J.K.' written above the main signature.

Date:

15/05/2020

APPROVED

Pietens

S.G. NO. A97/2012

for SURVEYOR-GENERAL

2012 -06- 27

SIDES metres	ANGLES OF DIRECTION	CO-ORDINATES		DESIGNATION		
		Y	X			
		Constants 0.00				
A B	4 417,82	274.47.35	A	-66 525,72	-213 304,96	VB525
B C	2 093,10	355.43.50	B	-70 928,09	-212 935,82	VB526
C D	148,58	71.15.30	C	-71 083,92	-210 848,53	KAZ1
D E	1 209,71	343.06.45	D	-70 945,11	-210 801,43	KAZ2
E F	4 396,23	28.16.30	E	-71 296,53	-209 643,89	KAZ5
F A	7 998,08	160.21.34	F	-69 214,01	-205 772,20	EB24



-77 941,57	-203 699,29
-57 724,91	-203 652,90

Geel
Uitsig

Beacon descriptions:

B, F 50mm Round iron pipe with cairn of stones
 A 30mm Round iron peg with cairn of stones
 All other beacons .. Iron standard

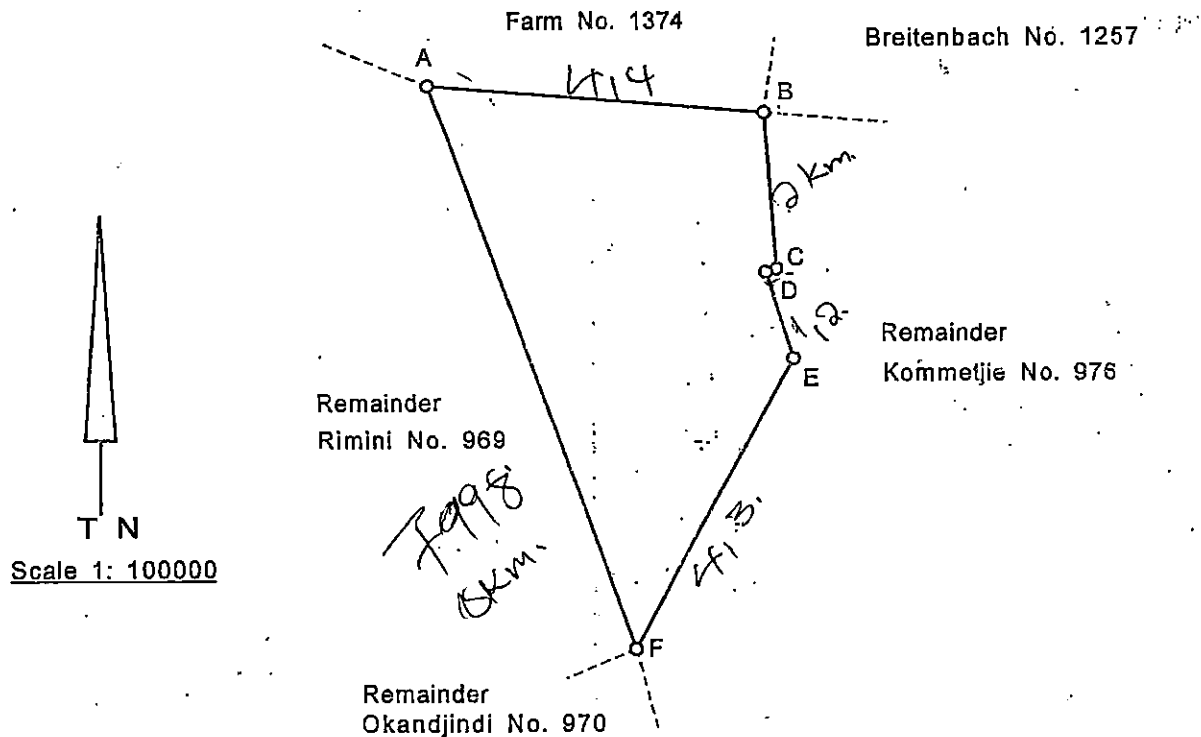

The figure A B C D E F

represents 2 000,9174 hectares of land, being.

PORTION 1 of the farm KOMMETJIE No. 976

Registration Division B

Otjozondjupa Region Namibia

Surveyed in November 2011 by me

C. de Wet

Land Surveyor
C. de Wet

This diagram is annexed to

No.
d.d.

The original diagram is

No. A709/58 annexed to
D/G No. 64/68
Dated: 22-05-68

S.R. No. E35/2012
Gen. Plan No.
Noting Plan. OG-N
File No. B976
Lat. 20° 07'S
Long. 17° 42'E

14
7313
7313

6
7313
7313.95
73