

Exclusive Prospecting Licence (Exploration)

Coordinates And Shape

Coordinates

Official Area: 45375.5446 Ha

Coordinate system: GCS Bessel 1841

	Latitude	Longitude
Part 2		
1	20° 28' 59.13" S	015° 44' 49.33" E
2	20° 28' 22.01" S	015° 39' 17.39" E
3	20° 14' 31.14" S	015° 39' 22.47" E
4	20° 14' 31.84" S	015° 48' 01.67" E
5	20° 13' 57.60" S	015° 48' 01.71" E
6	20° 13' 59.13" S	015° 59' 41.43" E
7	20° 18' 18.00" S	015° 59' 42.97" E
8	20° 18' 18.00" S	015° 45' 01.00" E

License Shape

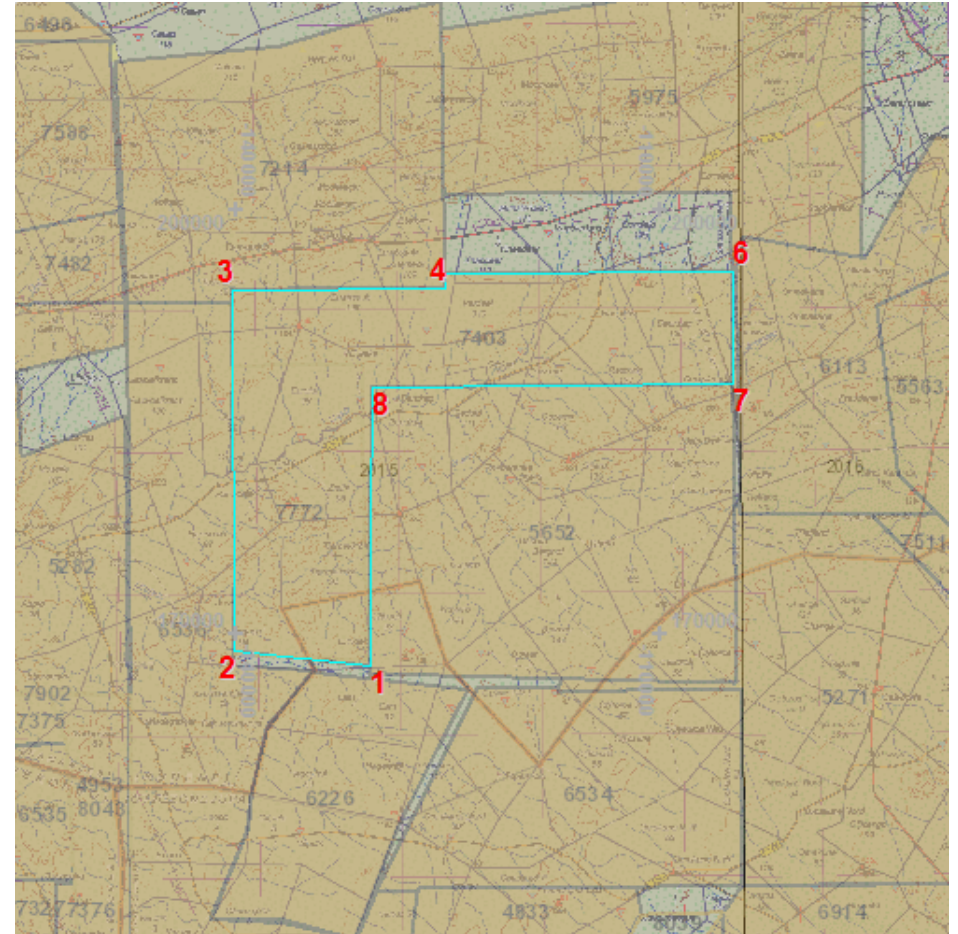

EPL-7403 (7403)

Active

Exclusive Prospecting Licence (Exploration)

General

Jurisdiction: Namibia Mines MIN
Region:
Official Area: 45375.5446 Ha
Application Number: Pre-Application_EPL_1851
Old License Code:
Accounting Code:
Renewal Period: 0
Commodities: BRM, PM
Comment:

Application Date: 23 November 2018
Closure Date:
Expiry Date: 27 October 2022
Grant Date: 28 October 2019
Last Renewal Date:
Peg Date:
Renewal Application Date: