



REPUBLIC OF NAMIBIA

---

## MINISTRY OF MINES AND ENERGY

---

Tel.: +264 61 284-8111  
Fax: +264 61 238643 / 220386  
E-mail: [info@mme.gov.na](mailto:info@mme.gov.na)  
Website: [www.mme.gov.na](http://www.mme.gov.na)

1 Aviation Road  
Private Bag 13297  
WINDHOEK

Enquiries: Mrs. F. Flavianu

Reference No: 14/2/4/1/8355

The Directors  
EagleFortune Investment CC  
P. O. Box 22686  
Windhoek

### **NOTICE TO APPLICANT OF PREPAREDNESS TO GRANT APPLICATION FOR EXCLUSIVE PROSPECTING LICENCE No. 8355.**

In terms of Section 48(4) of the Minerals (Prospecting and Mining) Act, No. 33 of 1992, notice is hereby given that the Minister is prepared to grant your new application, lodged on 07 September 2020, for an exclusive prospecting licence in respect of Dimension Stone, Base and Rare Metals, Industrial Minerals and Precious Metals Groups of Minerals over an area of land as shown in the attached diagrams, subject to the terms and conditions contained in the attached schedule, which terms and conditions supplement the terms, conditions and provisions of the said Act.

Your attention is drawn to the provisions of Section 48(5) of the said Act, which require that within one (1) month from the date of this notice, written acceptance of such terms and conditions must be received by the Commissioner, failing which the application will be deemed to have lapsed.

Kindly acknowledge your acceptance of such terms and conditions by-

- (a) completing the section at the bottom of this notice;
- (b) initialing each page of the schedule and the diagrams; and
- (c) returning such signed and initialed documents to the Commissioner.

  
30/08/2021  
**MR. E. I. SHIVOLO**  
**MINING COMMISSIONER**



**DIAGRAM – EXCLUSIVE PROSPECTING LICENCE – 8355**

**Issued in favour of: EagleFortune Investment CC**

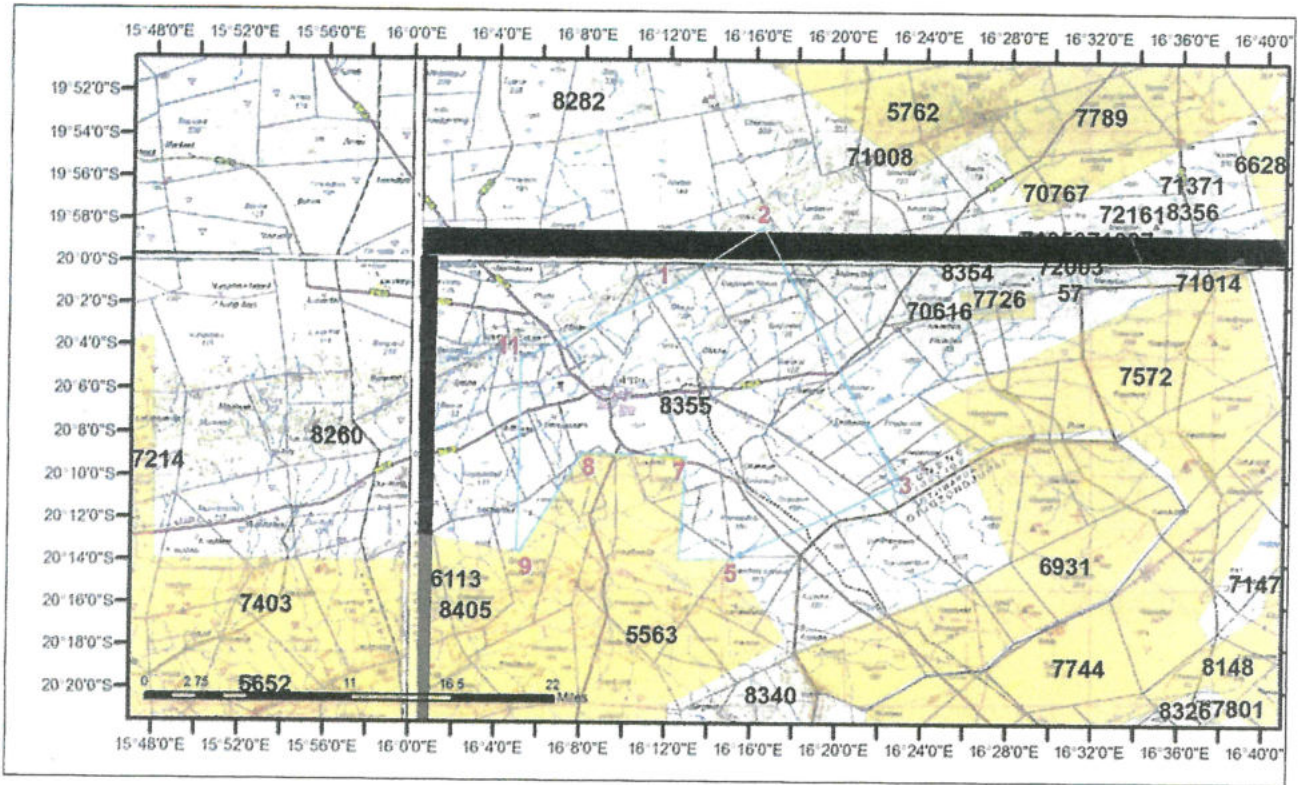

Latitude and Longitude lines refer to the Bessel 1841 Spheroid

EPL - Application	ERL - Application	Withdrawn Area	District
EPL - Active	ERL - Active	Farms	Region
ML - Application	RL - Application	Environmentally Sensitive	Division
ML - Active	RL - Active		
MC - Application	MDRL - Application		
MC - Active	MDRL - Active		

Projection: Albers Conic Equal Area  
 Spheroid: Bessel 1841  
 Central Meridian: 17 Deg. E

AREA: **49800.2095 Hectares**

MAP(S):

LOCALITY:

- \*Regions(s): **Kunene**
- \*Magisterial District(s): **Outjo**
- \*Registration Division(s): **A**

Order	Lat Deg	Lat Min	Lat Sec		Long Deg	Long Min	Long Sec	
1	- 20	01	12.34	S	16	12	0.03	E
2	- 19	58	16.39	S	16	16	24.20	E
3	- 20	10	10.96	S	16	22	52.20	E
4	- 20	11	29.89	S	16	20	14.35	E
5	- 20	13	46.94	S	16	15	2.51	E
6	- 20	13	49.03	S	16	12	36.41	E
7	- 20	09	0.35	S	16	12	53.18	E
8	- 20	08	49.95	S	16	07	59.19	E
9	- 20	13	30.63	S	16	05	6.52	E
10	- 20	13	29.66	S	16	04	59.69	E
11	- 20	04	35.51	S	16	05	5.29	E

Certified by:.....*John A. ...*..... Date Stamp  
Mining Commissioner

*MA*  
*RB*